

FLOS

■ F9560030 Black

Wan Suspension

Designed by Johanna Grawunder, 2006



Halogen

Suspension lamp providing direct lighting. Aluminum body, available in shiny white, shiny black and shiny green finishes. Low glare shield. Provided by two different ring due to fix the safety tempered glass, in black and green.

Are you a professional and your project needs consulting and support?

BOOK AN APPOINTMENT

Main specifications

Mounting	Suspension
Environments	Indoor dry location
Light source type	Bulb
Light sources included	No
Lamp category	Halogen
Lamp holders	G9
Ilcos	HSG
Number of lamps	1

Physical

Colour	Black
Cord length (mm)	2800
Net weight (kg)	0.85
Package height (mm)	175
Package width (mm)	220
Package length (mm)	190
Package volume (m3)	0.01

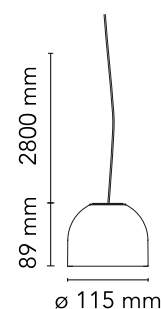

Download

Mounting instructions  PDF

Photometric Files

LDT / IES  LDT

Technical Drawings

2D  ZIP

3D  ZIP

 Bim  ZIP



Schematic light drawing

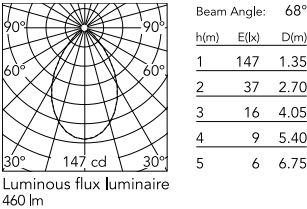

Photometric

Light distribution	Symmetric
Extreme cut off	No

Electrical

Insulation class	II
Frequency (Hz)	50/60
Main voltage (Vac)	220-250
Dimmable	Yes
Dimming interface	Remote Dimmable (Dimmer Not Included)
Batteries inside	No

Bulbs



NOT INCLUDED

RF18863

Halogen Lamp G9 33W 2700K

HALOPIN Dimmable

Spare Parts

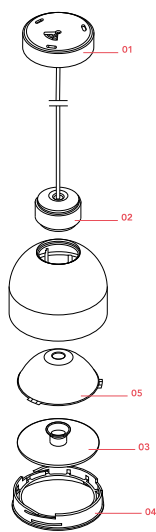

01.	Black rose assembly	RF9560130
02.	G9 lamp holder with inner ring and 2,5mt of eletrical cable	RF9560200
03.	Wan glass assembly	RF9550200
04.	External ring	RF13990
05.	Reflector / ring assembly	RF9550130



RF9560130

Black rose assembly



RF9560200

G9 lamp holder with inner ring
and 2,5mt of eletrical cable



RF9550200

Wan glass assembly



RF13990

External ring



RF9550130

Reflector / ring assembly