

■ F7541031 Matte Black

## To-Tie T1

Designed by Guglielmo Poletti, 2022

7W - 314lm - 2700K - CRI> 90

Designed by Guglielmo Poletti Table lamp providing diffused light. Clear glass cylindrical lamp body available in multiple sizes. The handle is made of aluminum and also acts as a light emitter. Multi-led diffuser in specially designed white polycarbonate to avoid the Multi Shadow effect and dazzle. High efficiency LED source with a lifetime of more than 50.000 hours. Electric cable of useful length 180 cm, covered in black fabric and equipped with dimmer switch for ON/OFF and adjustment of the light flow between 10-100%. Plug-in power supply with interchangeable plugs. To-Tie is a future-proof lamp as no glue is used to assemble its different parts. The product can therefore be separated, replaced individually, and recycled separately.

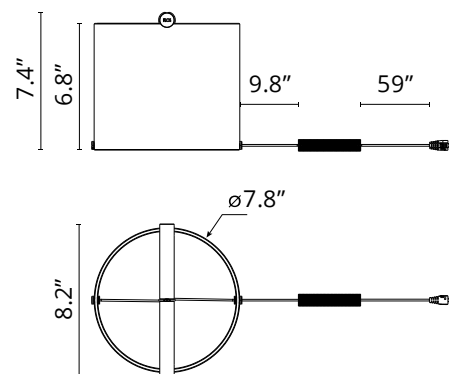

Are you a professional and your project needs consulting and support?

[BOOK AN APPOINTMENT](#)

### Main specifications

EAN	8059607047613
Mounting	Table
Environments	Indoor dry location
Light Source Type	LED
Light sources included	Yes
LED type	LED Module
Power (W)	7
System flux (lm)	314

### Physical

Color	Matte Black
Length (in)	8.27
Cord color	Black
Net weight (lb)	3.31
Package height (in)	11.42
Package width (in)	11.61
Package length (in)	11.61
Package volume (in)	1540.06
IP internal	20
H2O stop	No

### Download

Mounting instructions [↓ PDF](#)

### Photometric Files

LDT / IES [↓ ZIP](#)

### Technical Drawings

2D [↓ ZIP](#)

3D [↓ ZIP](#)

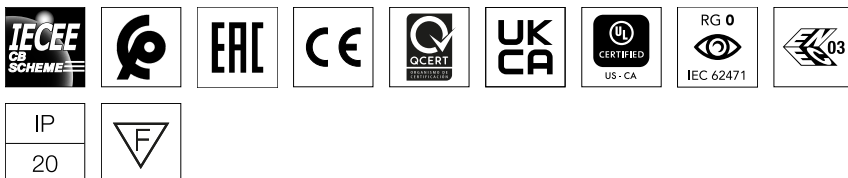

Ecodesign and Energy Labelling

This product contains a light source of energy efficiency class F

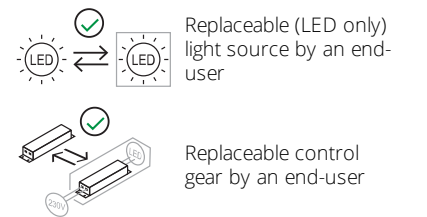

## Schematic light drawing

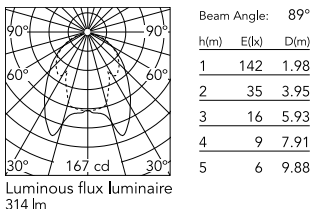

## Photometric

Light distribution	Asymmetric
CCT (K)	2700
CRI>	90

## Electrical

Insulation class	III
Frequency (Hz)	50/60
Main voltage (Vac)	24
LED current (mA)	500
Driver	Remote included
Dimmable	Yes
Dimming type	Electronic 24V
Dimming interface	Dimmer Integrated
Plug type	Type G, Type A, Type C

Spare Parts

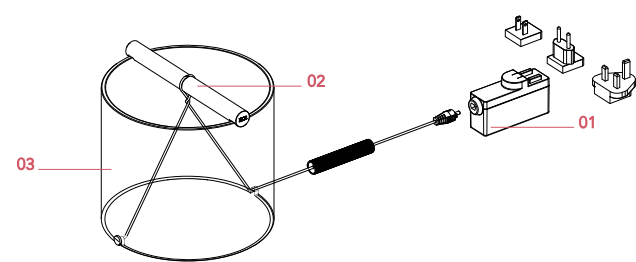

00.	Led Board with connectors for To-Tie Table 1-Table 2	RF7541200
01.	Black plug assembly kit & 24V driver	RF6600230
02.	Assembly Body for To-Tie Table 1 Black	RF7541131
03.	Base for To-Tie Table 1	RF7541100



RF7541200  
Led Board with connectors for  
To-Tie Table 1-Table 2



RF6600230  
Black plug assembly kit & 24V  
driver



RF7541131  
Assembly Body for To-Tie Table 1  
Black



RF7541100  
Base for To-Tie Table 1