

# FLOS

 F6486014 Blue

## String Light - Sphere head - 12mt cable

Designed by Michael Anastassiades, 2014



21W - 1515lm - 2700K

Suspension lamp providing diffused light. Black, white or blue varnished die-cast aluminium body coated with clear soft-touch varnish. Optical diffuser in opal PC. Suspension system of 12 metres with Kevlar reinforced coaxial cable. Available with wall/ceiling connection in black PC and power supply with floor switch in black varnished PC. The on/off switch is electronic with optical and touch dimm mechanism included or touch dimm and CASAMBI Ready version. Dimmer included. Compulsory to add either floor switch or ceiling/wall rose.

Are you a professional and your project needs consulting and support?

[BOOK AN APPOINTMENT](#)

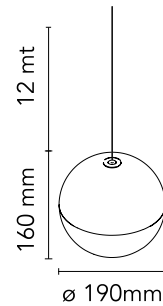

### Main specifications

EAN	8059607041413
Mounting	Suspension
Environments	Indoor dry location
Light source type	LED
Light sources included	Yes
LED type	LED array
Power (W)	21
System flux (lm)	1515

### Physical

Colour	Blue
Length (mm)	190
Cord colour	Blue
Cord length (mm)	12000
Net weight (kg)	1.12
Package height (mm)	300
Package width (mm)	300
Package length (mm)	300
Package volume (m3)	0.03
IP internal	20

### Download

Mounting instructions	<a href="#">↓ PDF</a>
Mounting instructions	<a href="#">↓ PDF</a>
Mounting instructions	<a href="#">↓ PDF</a>

### Photometric Files

LDT / IES	<a href="#">↓ LDT</a>
-----------	-----------------------

### Technical Drawings

 Bim	<a href="#">↓ ZIP</a>
---	-----------------------

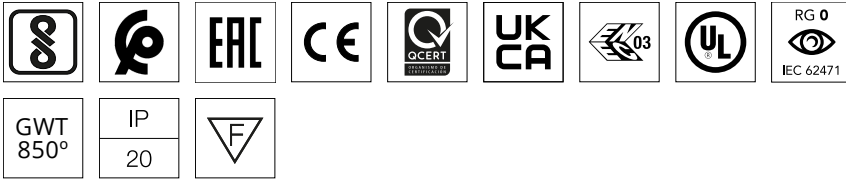

## Ecodesign and Energy Labelling

This product contains a light source of energy efficiency class D

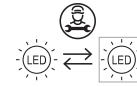

Replaceable (LED only) light source by a professional

## Schematic light drawing

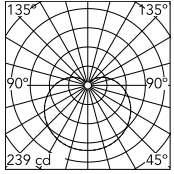

Luminous flux luminaire  
1515 lm

## Photometric

Light distribution	Roto symmetric
CCT (K)	2700

## Electrical

Insulation class	III
Main voltage (Vac)	48
Forward voltage (V)	48
Power supply	Remote excluded
Dimmable	Yes
Power supply type	Electronic 48V
Dimming interface	Dimmer Integrated
Batteries inside	No

## Accessories & Power Supply



REQUIRED

F6484014

Sting Light Floor Switch



REQUIRED

F6484314

Sting Light Floor Switch



REQUIRED

F6482014

String Light Canopy in Blue



OPTIONAL

F6485014

String Light Cable

## Spare Parts

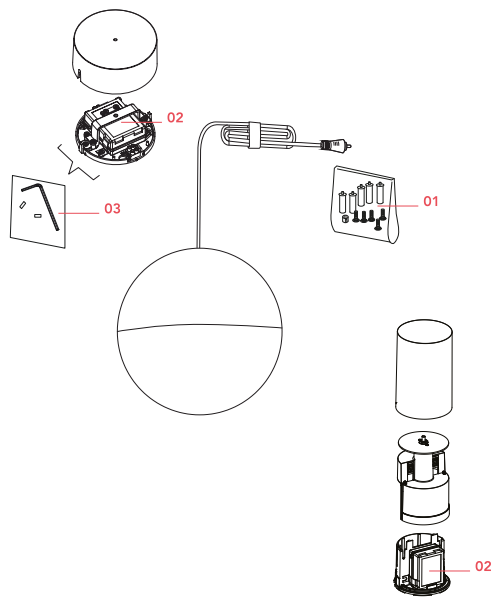

- 01. Kit with blue hooks and blue wire cable clamps RF6480114
- 02. Power supply unit for led RF22934
- 03. Kit with allen key and screws for ceiling rose assembly RF6480200

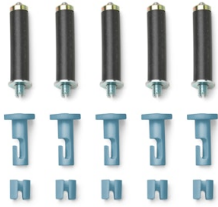

RF6480114

Kit with blue hooks and blue wire  
cable clamps



RF22934

Power supply unit for led



RF6480200

Kit with allen key and screws for  
ceiling rose assembly