

FLOS

■ FU661230 Glossy Black

Spun Light Floor

Designed by Sebastian Wrong, 2003

Incandescent - 200W



Designed by Sebastian Wrong in 2003, the Spun Light-F floor lamp reflects the best of modern manufacturing technology combined with elegance, craftsmanship, and dynamic fluid aesthetics. Its main body has a spun metal frame and diffuser. The diffuser support arms and lamp-holder support are die-cast aluminum, and the diffuser supports are white, injection-molded PC (polycarbonate). The dimmer has a 0-100% luminosity adjustment on the polarized cord. Emitting a gorgeous diffused light, the Spun Light- F floor lamp is part of the Spun Light family. It is available in black, mud, white, and Polished aluminum.

Are you a professional and your project needs consulting and support?

BOOK AN APPOINTMENT

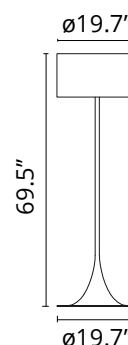

Main specifications

EAN	8059607029923
Mounting	Floor
Environments	Indoor dry location
Light Source Type	Bulb
Light sources included	No
Lamp category	Incandescent
Lamp type	A Shielded
Lamp holders	E26
Number of lamps	1
Power (W)	200

Physical

Color	Glossy Black
Length (in)	19.68
Cord color	Black
Net weight (lb)	20.5
Package height (in)	22.83
Package width (in)	74.02
Package length (in)	22.83
Package volume (in)	38593.52
IP internal	20

Download

Mounting instructions



<https://professional.flos.com/en-US/us/product/spun-light-floor-fu661230/>

FU661230

©2022 Flos - P.IVA 00290820174 - 9/19/2025

professional.flos.com | info@flos.com 1/4

In our constantly evolving world and business, technical upgrades happen every day. This means all product specifications and data are subject to change without warning in order to improve reliability, function, performance or otherwise. We make every effort to ensure the accuracy of our product images, however due to different lighting and screens used for viewing, the colours may vary. Images are indicative of the quality and style of the product but may not represent the precise details of the product you receive. This is because we are constantly working to make improvements. For aesthetic reasons, cables and/or electrical elements are often not shown. Refer to technical data sheets for all technical data. Images and colours are not part of any contract or warranty in any way.

Photometric

Light distribution	Symmetric
Extreme cut off	No

Electrical

Insulation class	II
Frequency (Hz)	60
Main voltage (Vac)	120
Dimmable	Yes
Dimming interface	Dimmer Integrated
Plug type	Type A
Batteries inside	No

Spare Parts

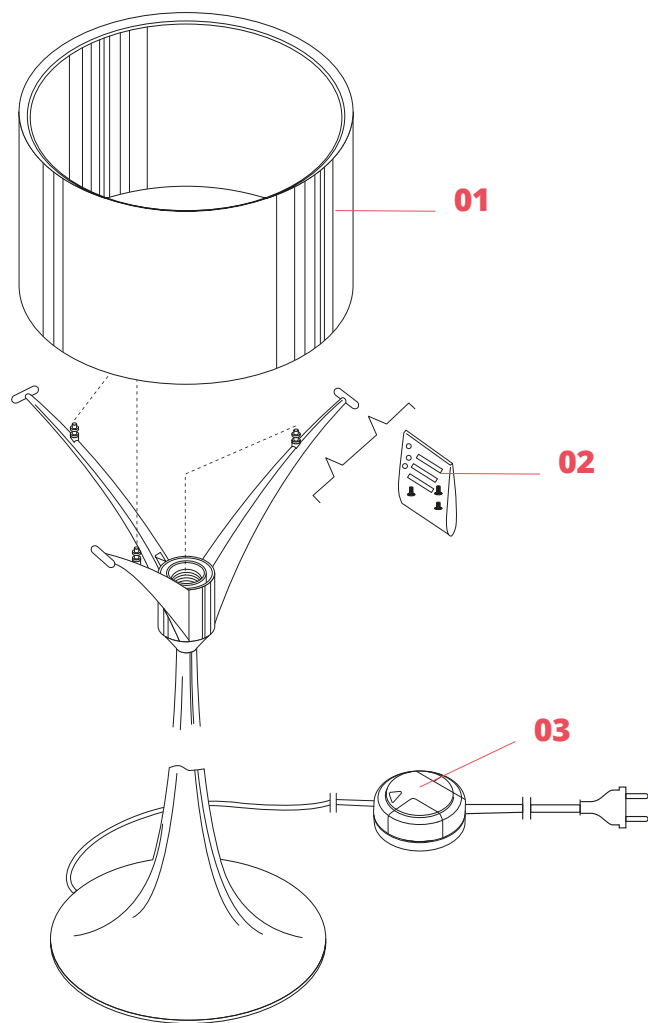

- | | | |
|-----|---------------------------------------|-----------|
| 01. | Spun Light Floor black diffuser | RF12147 |
| 02. | Bag with diffuser supports and o-ring | RF6610100 |
| 03. | 4W -25W Black Led Dimmer | RF28209 |



RF12147

Spun Light Floor black diffuser



RF6610100

Bag with diffuser supports and o-ring



RF28209

4W -25W Black Led Dimmer