

FLOS

03.6303.14CDA Black

Spot Module Dali Version

Designed by FLOS Architectural, 2016



Accent lighting LED module to be installed in The Running Magnet System. Built-in DC/DC electronic voltage converter.

Are you a professional and your project needs consulting and support?

BOOK AN APPOINTMENT

Main specifications

Mounting	Track
Environments	Indoor dry location
Light source type	LED
Light sources included	Yes
LED type	Power LED
Lamp category	LED
Number of lamps	1
Power (W)	8
System power (W)	8.4
Source flux (lm)	0
Lumen Output (lm)	403
Efficacy (lm/W)	47.98

Physical

Colour	Black
Trim	No
Orientation	Adjustable
Rotation (°)	360
Longitudinal tilting (°)	90
Spot diameter (mm)	34
Length (mm)	34
Net weight (kg)	0.19
IP internal	20
IP external	20

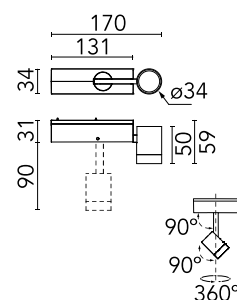

Download

Mounting instructions [Download PDF](#)

Item information [Download JPG](#)

Photometric Files

LDT / IES [Download ZIP](#)

Technical Drawings

2D [Download ZIP](#)

3D [Download ZIP](#)

[Bim](#) [Download ZIP](#)



Schematic light drawing

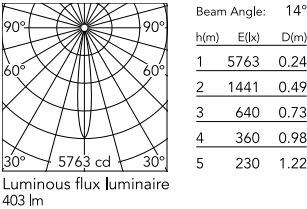

Photometric

Lighting type	Direct
Light distribution	Symmetric
CCT (K)	2700
CRI>	90
McAdam steps (SDCM)	3
LED Life / Failure Ratio	L80B50 > 50.000h (Tc=85°C)
Beam angle C0-180 (°)	14
Beam angle C90-270 (°)	14
Extreme cut off	No
UGR _L	<16

Electrical

Insulation class	III
Forward voltage (V)	24
Power supply	Remote excluded
Dimmable	Yes
Power supply type	Dimmable DALI 2
Dimming range (%)	10-100

Notes

Maximum 14 spots for a single driver. Maximum 64 spots for a single DALI controller. For wireless lighting control, choose integrated Casambi versions.

Accessories & Power Supply



OPTIONAL
Accessory
Optical

08.8427.14
Screening external ring for
Running Magnet spot module



OPTIONAL
Accessory
Optical

08.8759.00
Elliptical lens



OPTIONAL
Accessory
Optical

08.8760.00
Frosted Medium lens



OPTIONAL
Accessory
Optical

08.8761.00
Frosted Flood lens