

# FLOS

■ F0273000 Black

## Noctambule Suspension 2 Low Cylinder Bowl

Designed by Konstantin Grcic, 2019



45W - 1007lm - 2700K - CRI> 90

Hanging lamps consisting of interconnecting glass modules reaching a length of 3,2 mt. (126.77") with 4 mt. (157.48") suspended power cable. Cylindrical and semi-spherical transparent blown glass structure, suspended die cast aluminium ring connector, hydroformed steel internal lateral arm and injection moulded optical opal silicone outer ring diffusers. The power supply unit within the ceiling rose can be used as a dimmer to adjust the light intensity by 10% to 100% in either direction by means of the 0-10/1-10V, PUSH, DALI control.

Are you a professional and your project needs consulting and support?

BOOK AN APPOINTMENT

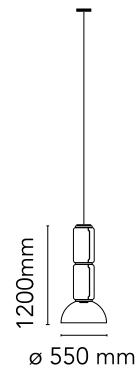

### Main specifications

|                        |                     |
|------------------------|---------------------|
| EAN                    | 8059607000687       |
| Mounting               | Suspension          |
| Environments           | Indoor dry location |
| Light source type      | LED                 |
| Light sources included | Yes                 |
| LED type               | LED Module          |
| Power (W)              | 45                  |
| System flux (lm)       | 1007                |

### Physical

|                             |       |
|-----------------------------|-------|
| Colour                      | Black |
| Length (mm)                 | 250   |
| Cord colour                 | Black |
| Cord length (mm)            | 4000  |
| Canopy colour               | Black |
| Canopy length/diameter (mm) | 187   |
| Canopy height (mm)          | 45    |
| Net weight (kg)             | 14.2  |
| Package volume (m3)         | 0.5   |
| IP internal                 | 20    |

### Download

Mounting instructions [↓ PDF](#)  
Mounting instructions [↓ PDF](#)

### Photometric Files

LDT / IES [↓ ZIP](#)

### Technical Drawings

3D [↓ ZIP](#)  
[🔒 Bim](#) [↓ ZIP](#)

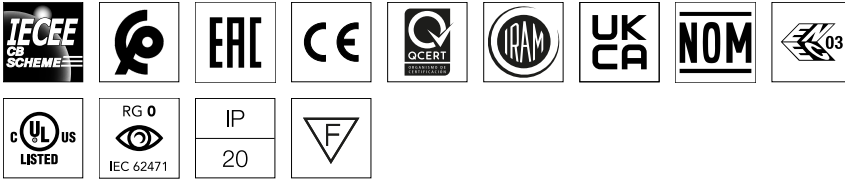

## Schematic light drawing

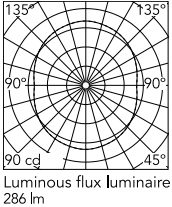

## Photometric

|                    |           |
|--------------------|-----------|
| Lighting type      | Total     |
| Light distribution | Symmetric |
| CCT (K)            | 2700      |
| CRI>               | 90        |
| Extreme cut off    | No        |

## Electrical

|                    |   |
|--------------------|---|
| Insulation class   | I   |
| Frequency (Hz)     | 50/60   |
| Main voltage (Vac) | 120-277   |
| Power supply       | Integrated  |
| Dimmable           | Yes   |
| Power supply type  | Dimmable 0-10V,<br>Dimmable Push,<br>Dimmable 1-10V,<br>Dimmable DALI 1 |
| Dimming interface  | Remote Dimmable<br>(Dimmer Not<br>Included)                             |
| Batteries inside   | No  |

## Ecodesign and Energy Labelling

This product contains a light source of energy efficiency class E

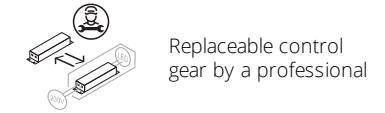
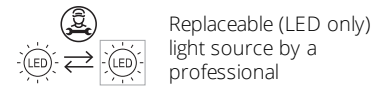

## Spare Parts

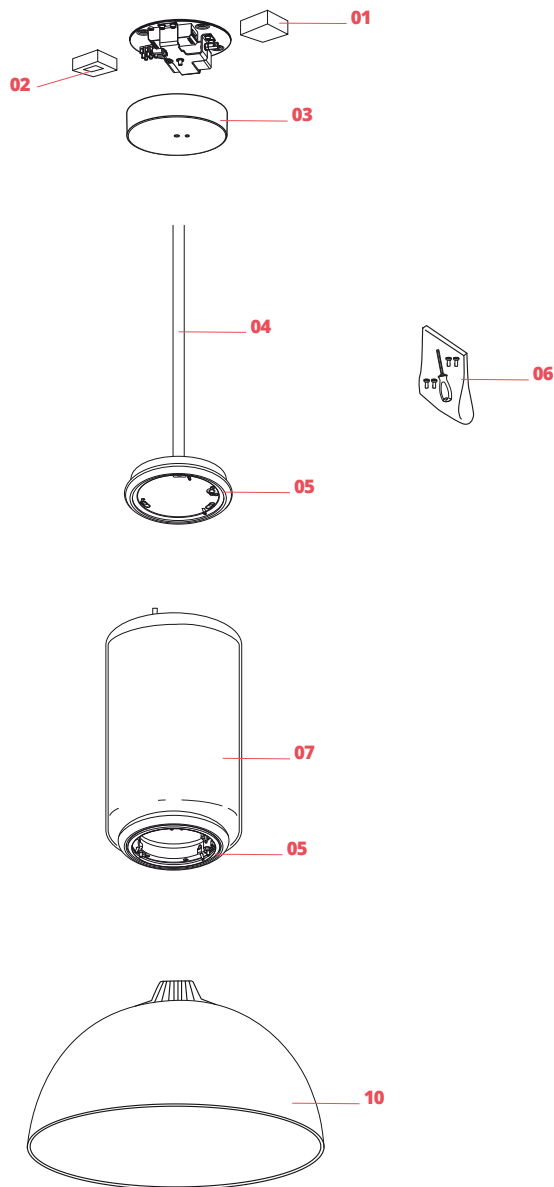

|     |  |           |
|-----|--|-----------|
| 01. | Power supply kit for Arrangements small & Noctambule | RF0410500 |
| 02. | Led dimmer kit                                       | RF0410300 |
| 04. | Suspension attack                                    | F0253030  |
| 05. | Ring led diffuser                                    | RF27498   |
| 06. | Fixing screws kit                                    | RF0254100 |
| 07. | Noctambule Low Cylinder                              | F0254000  |
| 10. | Noctambule Bowl                                      | F0255000  |



RF0410500  
Power supply kit for  
Arrangements small &  
Noctambule



RF0410300  
Led dimmer kit



F0253030  
Suspension attack



RF27498  
Ring led diffuser



RF0254100  
Fixing screws kit



F0254000  
Noctambule Low Cylinder



F0255000  
Noctambule Bowl