

Noctambule Floor 1 Low Cylinder Small Base

Designed by Konstantin Grcic, 2019

18W - 485lm - 2700K



Noctambule LED dimmable floor lamp short cylinders with small base is a flamboyant, yet functional modern floor lamp lighting fixture crafted by the world-class designer Konstantin Grcic for FLOS. An innovative lamp that is practical and exquisite in equal measure, the product is available in an array of interesting designs. One of the highlighting aspects of this fixture is that it is very dynamic in nature. The lighting system has a transparent hand-blown glass cylinder as its foundation, which is surrounded on top and at the bottom by LED technology. Users can configure this as a pendant lamp or a standing lamp by using its additional components. Putting together these units can help form columns of light at different heights that illuminate at the intersecting points between these modules. Inspiration behind the design: Inspired by night owls, Noctambule by Konstantin Grcic features a transparent body that almost blends into a room when unlit, but makes its presence known when it illuminates at night. Noctambule means night owl in French.

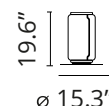

Are you a professional and your project needs consulting and support?

[BOOK AN APPOINTMENT](#)

Main specifications

| | |
|------------------------|---------------------|
| EAN | 8059607000847 |
| Mounting | Floor |
| Environments | Indoor dry location |
| Light Source Type | LED |
| Light sources included | Yes |
| LED type | LED Module |
| Power (W) | 18 |
| System flux (lm) | 485 |

Physical

| | |
|---------------------|---------|
| Color | Black |
| Length (in) | 9.84 |
| Cord color | Black |
| Cord length (in) | 70.866 |
| Net weight (lb) | 22.71 |
| Package volume (in) | 6880.82 |
| IP internal | 20 |

Download

Mounting instructions  PDF

Mounting instructions  PDF

Photometric Files

LDT / IES  ZIP

Technical Drawings

3D  ZIP

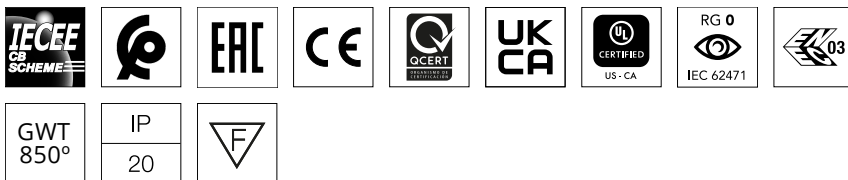

Schematic light drawing

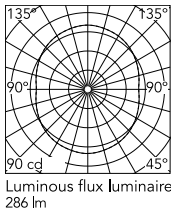

Photometric

| | |
|--------------------|-----------|
| Lighting type | Total |
| Light distribution | Symmetric |
| CCT (K) | 2700 |
| Extreme cut off | No |

Electrical

| | |
|--------------------|------------------------|
| Insulation class | III |
| Frequency (Hz) | 50/60 |
| Main voltage (Vac) | 100-240 |
| Driver | Remote included |
| Dimmable | Yes |
| Dimming type | Electronic 48V |
| Dimming interface | Dimmer Integrated |
| Plug type | Type G, Type A, Type C |
| Batteries inside | No |

Ecodesign and Energy Labelling

This product contains a light source of energy efficiency class E

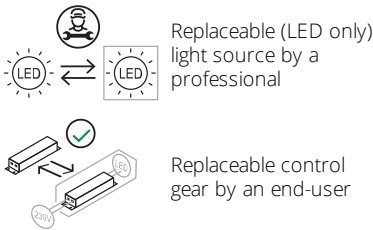

Spare Parts

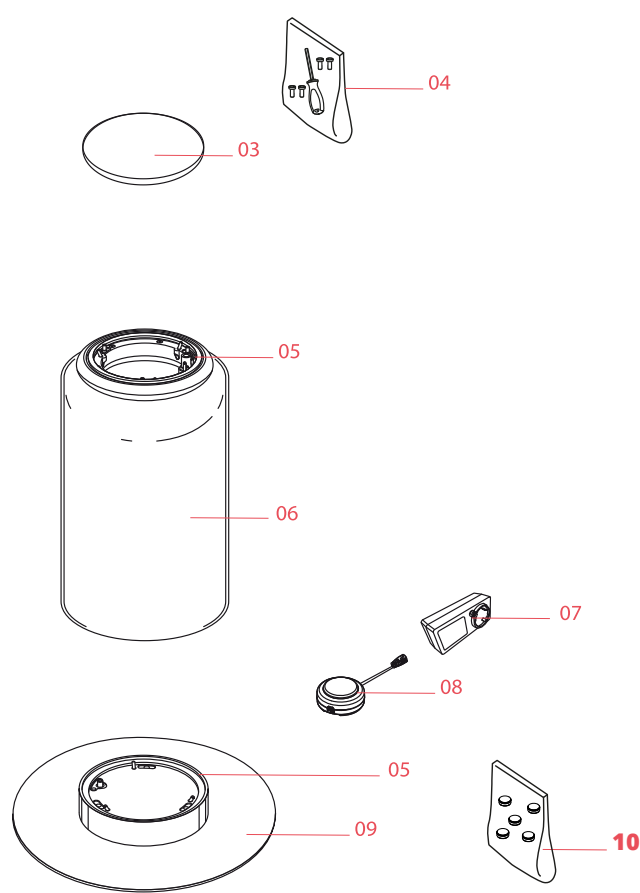

| | | |
|-----|---|-----------|
| 03. | Noctambule Floor Terminal cap | F0293030 |
| 04. | Fixing screws kit | RF0254100 |
| 05. | Ring led diffuser | RF27498 |
| 06. | Noctambule Low Cylinder | F0254000 |
| 07. | Black plug assembly kit & 48V driver | RF6600130 |
| 08. | Noctambule switch dimmer assembly (with EMC filter) | RF37082 |
| 09. | Noctambule Floor Small base | F0261030 |
| 10. | Noctambule F n°5 adjustable feet kit | RF0254200 |



F0293030

Noctambule Floor Terminal cap



RF0254100

Fixing screws kit



RF27498

Ring led diffuser



F0254000

Noctambule Low Cylinder



RF6600130

Black plug assembly kit & 48V driver



RF37082

Noctambule switch dimmer assembly (with EMC filter)



F0261030

Noctambule Floor Small base



RF0254200

Noctambule F n°5 adjustable feet kit