

FLOS

F1490009 Glass

Mini Button

Designed by Piero Lissoni, 2005



Halogen - 25W

Wall or ceiling fixture providing diffused lighting suitable for indoor and outdoor use. Silicone elastomer dust and waterproof seal. Die-cast aluminum lamp body and wall fitting. Diffuser available in opaline glass or polycarbonate (IP44).

Are you a professional and your project needs consulting and support?

[BOOK AN APPOINTMENT](#)

Main specifications

EAN	8059607015179
Mounting	Ceiling, Wall
Environments	Indoor Outdoor wet location
Light source type	Bulb
Light sources included	No
Lamp category	Halogen
Lamp holders	G9
Ilcos	HSGS
Number of lamps	1
Power (W)	25

Physical

Colour	Glass
Length (mm)	140
Net weight (kg)	0.66
Package height (mm)	70
Package width (mm)	190
Package length (mm)	205
IP internal	44

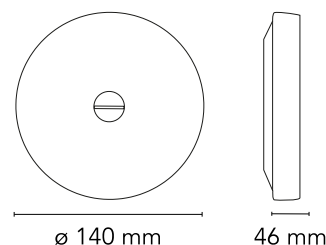

Download

[Mounting instructions](#)



Schematic light drawing

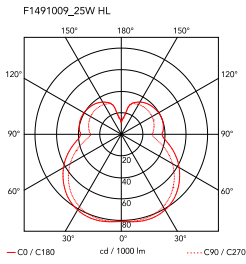

Photometric

Light distribution	Roto symmetric
Extreme cut off	No

Electrical

Insulation class	I
Frequency (Hz)	50/60
Main voltage (Vac)	220-250
Dimmable	Yes
Dimming interface	Remote Dimmable (Dimmer Not Included)
Batteries inside	No

Bulbs



NOT INCLUDED

RF36378

LED BiPin Lamp G9 3,2W 2700K
Dimmable



NOT INCLUDED

RF26520

LED Lamp 2W 240lm G9 220-
240 2700K T13 Non Dimmable

Spare Parts

02. Glass diffuser assembly

RF1490109

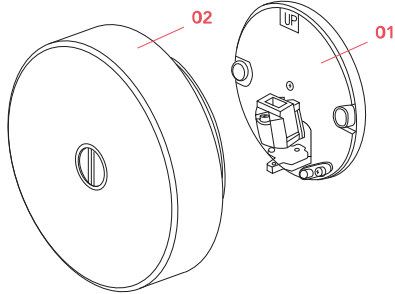



RF1490109

Glass diffuser assembly