

# FLOS

03.2300.40A White

## Micro Spot NEW

Designed by FLOS Architectural, 2020



Accent lighting LED module to be installed in The Micro Running Magnet System.  
Built-in DC/DC electronic voltage converter.

Are you a professional and your project needs consulting and support?

[BOOK AN APPOINTMENT](#)

### Main specifications

Mounting	Track
Environments	Indoor dry location
Light Source Type	LED
Light sources included	Yes
LED type	Power LED
Lamp category	LED
Number of lamps	1
Power (W)	3
System power (W)	3
Source flux (lm)	275
System flux (lm)	216
Efficacy (lm/W)	72

### Physical

Color	White
Orientation	Adjustable
Rotation (°)	267
Longitudinal tilting (°)	90
Length (in)	1.62
Net weight (lb)	6.999999999999993E-2
IP internal	20

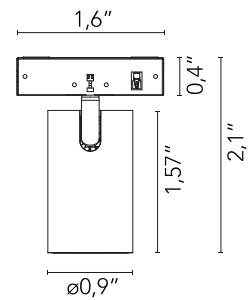

### Download

- [Family spec sheet](#) ZIP
- [Mounting instructions](#) PDF

### Photometric Files

- [LDT / IES](#) ZIP

### Technical Drawings

- [2D](#) ZIP
- [3D](#) ZIP

### Ecodesign and Energy Labelling



## Schematic light drawing

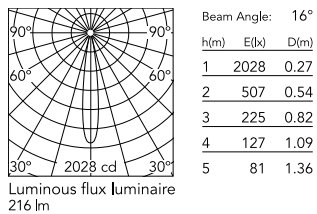

### Photometric

Lighting type	Direct
Light distribution	Symmetric
CCT (K)	2700
CRI>	90
McAdam steps (SDCM)	2
Beam angle C0-180 (°)	16
Beam angle C90-270 (°)	16
UGR <sub>L</sub>	<16

### Electrical

Insulation class	III
Forward voltage (V)	24
Driver	Remote excluded
Dimmable	Yes
Dimming type	Non Dimmable, Dimmable
Dimming interface	Remote Dimmable (Dimmer Not Included)

### Notes

Honeycomb accessory available. Must be ordered separately.