

FLOS

03.2223.14A Black

Micro Spot NEW

Designed by FLOS Architectural, 2020



LED - Power LED - 3W - 224lm - 5000K - CRI> 90 - Beam° 28

Accent lighting LED module to be installed in The Micro Running Magnet System.
Built-in DC/DC electronic voltage converter.

Are you a professional and your project needs consulting and support?

[BOOK AN APPOINTMENT](#)

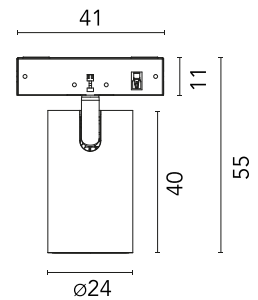

Main specifications

| | |
|------------------------|---------------------|
| Mounting | Track |
| Environments | Indoor dry location |
| Light source type | LED |
| Light sources included | Yes |
| LED type | Power LED |
| Lamp category | LED |
| Number of lamps | 1 |
| Power (W) | 3 |
| System power (W) | 3 |
| Source flux (lm) | 335 |
| Lumen Output (lm) | 224 |
| Efficacy (lm/W) | 74.67 |

Physical

| | |
|--------------------------|------------|
| Colour | Black |
| Orientation | Adjustable |
| Rotation (°) | 267 |
| Longitudinal tilting (°) | 90 |
| Spot diameter (mm) | 24 |
| Length (mm) | 41 |
| Net weight (kg) | 0.03 |
| IP internal | 20 |

Download

Mounting instructions [PDF](#)

Photometric Files

LDT / IES [ZIP](#)

Technical Drawings

2D [ZIP](#)

3D [ZIP](#)

[Bim](#) [ZIP](#)



Ecodesign and Energy Labelling



Schematic light drawing

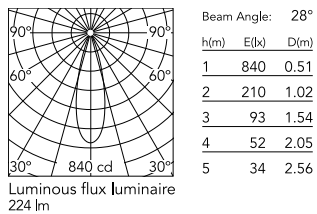

Photometric

| | |
|------------------------|-----------|
| Lighting type | Direct |
| Light distribution | Symmetric |
| CCT (K) | 5000 |
| CRI> | 90 |
| McAdam steps (SDCM) | 2 |
| Beam angle C0-180 (°) | 28 |
| Beam angle C90-270 (°) | 28 |
| UGR _L | <16 |

Electrical

| | |
|---------------------|---------------------------------------|
| Insulation class | III |
| Forward voltage (V) | 24 |
| Power supply | Remote excluded |
| Dimmable | Yes |
| Power supply type | Non Dimmable, Dimmable |
| Dimming interface | Remote Dimmable (Dimmer Not Included) |

Accessories & Power Supply



OPTIONAL
Accessory

Optical

08.0190.14

Honeycomb for Micro Spot