

FLOS

03.6813.3CBDA White/Aluminium

Light Supply Wall-Washer Trim Dimmable

Designed by FLOS Architectural, 2017

LED - LED array - 33.2W - 1845lm - 4000K - CRI> 90 - Beam° 36



Recessed luminaire with LED light source. Remote 220/240V power supply included.

Are you a professional and your project needs consulting and support?

[BOOK AN APPOINTMENT](#)

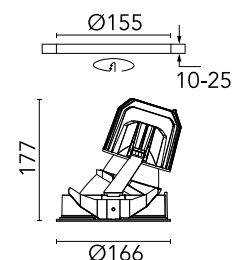

Main specifications

| | |
|------------------------|---------------------|
| Mounting | Ceiling recessed |
| Environments | Indoor dry location |
| Light source type | LED |
| Light sources included | Yes |
| LED type | LED array |
| Lamp category | LED |
| Number of lamps | 1 |
| Power (W) | 33.2 |
| Source flux (lm) | 3506 |
| Lumen Output (lm) | 1845 |

Physical

| | |
|---------------------|-----------------|
| Colour | White/Aluminium |
| Trim | No |
| Orientation | Fixed |
| Recessed depth (mm) | 290 |
| Net weight (kg) | 1.01 |
| IP internal | 20 |
| IP external | 44 |

Download

Mounting instructions [↓ PDF](#)

Photometric Files

LDT / IES [↓ ZIP](#)

Technical Drawings

2D [↓ ZIP](#)

3D [↓ ZIP](#)



Schematic light drawing

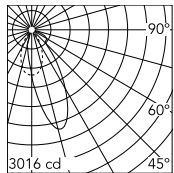

Beam Angle: 34°

| h(m) | E(lx) | D(m) |
|------|-------|------|
| 1 | 2696 | 0.67 |
| 2 | 674 | 1.35 |
| 3 | 300 | 2.02 |
| 4 | 168 | 2.69 |
| 5 | 108 | 3.37 |

Luminous flux luminaire
1989 lm (EXTREME CUT OFF)

Photometric

| | |
|------------------------|------------------|
| Lighting type | Indirect, Direct |
| Light distribution | Asymmetric |
| CCT (K) | 4000 |
| CRI> | 90 |
| Beam angle C0-180 (°) | 36 |
| Beam angle C90-270 (°) | 51 |
| Extreme cut off | No |

Electrical

| | |
|--------------------|-----------------|
| Insulation class | II |
| Frequency (Hz) | 50/60 |
| Main voltage (Vac) | 220-240 |
| Power supply | Remote included |
| Dimmable | Yes |
| Power supply type | Dimmable DALI 2 |