

FLOS

03.6811.3BBDA White/White

Light Supply Fixed Trim Dimmable

Designed by FLOS Architectural, 2017

LED - LED array - 29W - 1487lm - 3000K - CRI> 90 - Beam° 62



Recessed luminaire with LED light source. Remote 220/240V power supply included.

Are you a professional and your project needs consulting and support?

[BOOK AN APPOINTMENT](#)

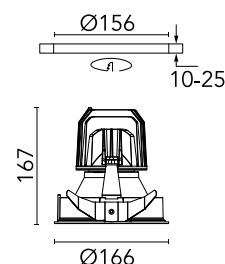

Main specifications

| | |
|------------------------|---------------------|
| Mounting | Ceiling recessed |
| Environments | Indoor dry location |
| Light source type | LED |
| Light sources included | Yes |
| LED type | LED array |
| Lamp category | LED |
| Number of lamps | 1 |
| Power (W) | 29 |
| Source flux (lm) | 2910 |
| Lumen Output (lm) | 1487 |

Physical

| | |
|---------------------|-------------|
| Colour | White/White |
| Trim | No |
| Orientation | Fixed |
| Recessed depth (mm) | 277 |
| Net weight (kg) | 0.98 |
| IP internal | 20 |
| IP external | 44 |

Download

Mounting instructions [↓ PDF](#)

Photometric Files

LDT / IES [↓ ZIP](#)

Technical Drawings

2D [↓ ZIP](#)

3D [↓ ZIP](#)



Schematic light drawing

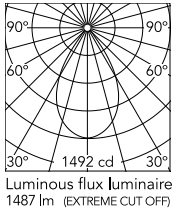

Beam Angle: 62°

| h(m) | E(lx) | D(m) |
|------|-------|------|
| 1 | 1492 | 1.19 |
| 2 | 373 | 2.39 |
| 3 | 166 | 3.58 |
| 4 | 93 | 4.77 |
| 5 | 60 | 5.97 |

Luminous flux luminaire
1487 lm (EXTREME CUT OFF)

Photometric

| | |
|------------------------|-----------|
| Lighting type | Direct |
| Light distribution | Symmetric |
| CCT (K) | 3000 |
| CRI> | 90 |
| Beam angle C0-180 (°) | 62 |
| Beam angle C90-270 (°) | 62 |
| Extreme cut off | No |

Electrical

| | |
|--------------------|-----------------|
| Insulation class | II |
| Frequency (Hz) | 50/60 |
| Main voltage (Vac) | 220-240 |
| Power supply | Remote included |
| Dimmable | Yes |
| Power supply type | Dimmable DALI 2 |