

FLOS

03.6810.1CA Black/Aluminium

Light Supply Fixed Trim

Designed by FLOS Architectural, 2017

LED - LED array - 29W - 1549lm - 4000K - CRI> 90 - Beam° 62



Recessed luminaire with LED light source. Remote 220/240V power supply included.

Are you a professional and your project needs consulting and support?

[BOOK AN APPOINTMENT](#)

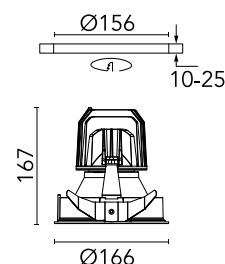

Main specifications

Mounting	Ceiling recessed
Environments	Indoor dry location
Light source type	LED
Light sources included	Yes
LED type	LED array
Lamp category	LED
Number of lamps	1
Power (W)	29
Source flux (lm)	2911
Lumen Output (lm)	1549

Physical

Colour	Black/Aluminium
Trim	No
Orientation	Fixed
Recessed depth (mm)	277
Net weight (kg)	0.98
IP internal	20
IP external	44

Download

Mounting instructions [↓ PDF](#)

Photometric Files

LDT / IES [↓ ZIP](#)

Technical Drawings

2D [↓ ZIP](#)

3D [↓ ZIP](#)

[Bim](#) [↓ ZIP](#)



Schematic light drawing

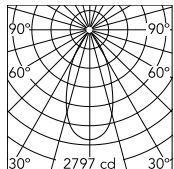

Beam Angle: 47°

h(m)	E(lx)	D(m)
1	2797	0.86
2	699	1.73
3	311	2.59
4	175	3.46
5	112	4.32

Luminous flux luminaire
1828 lm (EXTREME CUT OFF)

Photometric

Lighting type	Direct
Light distribution	Symmetric
CCT (K)	4000
CRI>	90
Beam angle C0-180 (°)	62
Beam angle C90-270 (°)	62
UGR _L	<16

Electrical

Insulation class	II
Frequency (Hz)	50/60
Main voltage (Vac)	220-240
Power supply	Remote included
Dimmable	No
Power supply type	Non Dimmable
Emergency	No