

FLOS

03.8321.14A Black/Black

Light Shadow Fixed Trim 8 Spots Optic Wide Flood

NEW

Designed by FLOS Architectural, 2022



Recessed integrated luminaire with 8 LED lighting spots. Remote power supply included (220-240V).

Are you a professional and your project needs consulting and support?

BOOK AN APPOINTMENT

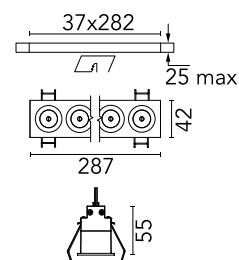

Main specifications

| | |
|------------------------|---------------------|
| Mounting | Ceiling recessed |
| Environments | Indoor dry location |
| Light source type | LED |
| Light sources included | Yes |
| LED type | Power LED |
| Lamp category | LED |
| Number of lamps | 1 |
| Power (W) | 21.6 |
| Source flux (lm) | 2280 |
| Lumen Output (lm) | 1858 |

Physical

| | |
|---------------------|-------------|
| Colour | Black/Black |
| Trim | Yes |
| Orientation | Fixed |
| Recessed depth (mm) | 75 |
| Length (mm) | 287 |
| Net weight (kg) | 0.50 |
| IP internal | 20 |
| IP external | 55 |

Download

Mounting instructions [Download PDF](#)

Photometric Files

LDT / IES [Download ZIP](#)

Technical Drawings

2D [Download ZIP](#)

3D [Download ZIP](#)

Bim [Download ZIP](#)



Schematic light drawing

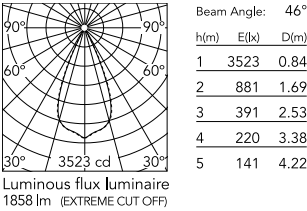

Photometric

| | |
|------------------------|-----------|
| Lighting type | Direct |
| Light distribution | Symmetric |
| CCT (K) | 3000 |
| CRI> | 90 |
| Beam angle C0-180 (°) | 46 |
| Beam angle C90-270 (°) | 46 |
| UGR _L | <10 |

Electrical

| | |
|-----------------------------------|-----------------|
| Insulation class | II |
| Frequency (Hz) | 50/60 |
| Main voltage (Vac) | 220-240 |
| Alternating current voltage (Vac) | 230 |
| Power supply | Remote included |
| Dimmable | No |
| Power supply type | Non Dimmable |
| Emergency | No |

Notes

Pre-installation frame not required.