

Light Shadow Fixed No Trim Mains dimming Version 12 Spots Optic Wide Flood

Designed by FLOS Architectural, 2022



Recessed integrated luminaire with 12 LED lighting spots. Remote power supply included (220-240V).

Are you a professional and your project needs consulting and support?

[BOOK AN APPOINTMENT](#)

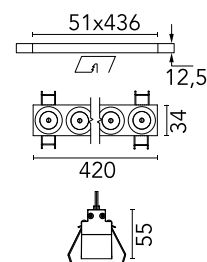

Main specifications

Mounting	Ceiling recessed
Environments	Indoor dry location
Light source type	LED
Light sources included	Yes
Lamp category	LED
Number of lamps	1
Power (W)	31.3
System power (W)	32.4
Source flux (lm)	2640
Lumen Output (lm)	2173
Efficacy (lm/W)	80

Physical

Colour	Black/White
Trim	No
Orientation	Fixed
Recessed depth (mm)	75
Length (mm)	420
Net weight (kg)	0.66
IP internal	20
IP external	55

Download

Mounting instructions	Download PDF
Mounting instructions	Download PDF

Photometric Files

LDT / IES	Download ZIP
-----------	------------------------------

Technical Drawings

2D	Download ZIP
3D	Download ZIP
Bim	Download ZIP



Schematic light drawing

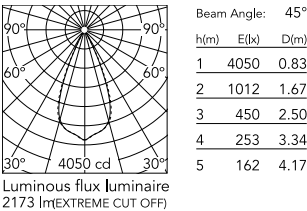

Ecodesign and Energy Labelling

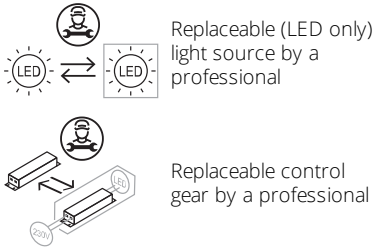

Photometric

Lighting type	Direct
Light distribution	Symmetric
CCT (K)	2700
CRI>	90
McAdam steps (SDCM)	3
LED Life / Failure Ratio	L80B20 >50.000h (Tc=85°C)
Beam angle C0-180 (°)	45
Beam angle C90-270 (°)	47
Extreme cut off	No
UGR _L	<10

Electrical

Insulation class	II
Frequency (Hz)	50/60
Main voltage (Vac)	220-240
Alternating current voltage (Vac)	230
LED current (mA)	900
Power supply	Remote included
Dimmable	Yes
Power supply type	Mains Cut Dimming

Notes

It requires a pre-installation frame, to be ordered separately.

Accessories & Power Supply



REQUIRED
Frame

Installation

08.0513.00

Pre-installation No Trim Frame
12L Fix

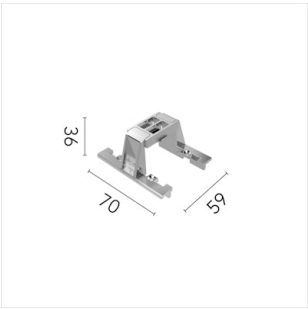

OPTIONAL
Accessory

Installation

08.0052.90

Accessory for mounting of No
Trim Fix continuous line.