

## Light Shadow Adjustable No Trim 4 Spots Optic Flood - Non IC

Designed by FLOS Architectural, 2022



Recessed integrated luminaire with 4 LED lighting spots. Remote power supply.

Are you a professional and your project needs consulting and support?

BOOK AN APPOINTMENT

### Main specifications

Mounting	Ceiling recessed
Environments	Indoor dry location
Light Source Type	LED
Light sources included	Yes
LED type	Power LED
Lamp category	LED
Number of lamps	1
Power (W)	10.8
Source flux (lm)	1080
System flux (lm)	741

### Physical

Color	White/White
Trim	No
Orientation	Adjustable
Longitudinal tilting (°)	30
IP internal	20

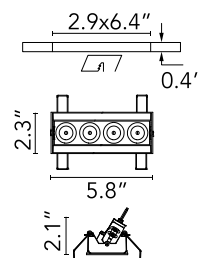

### Download

Family spec sheet	ZIP
Mounting instructions	PDF
Mounting instructions	PDF

### Photometric Files

LDT / IES	ZIP
-----------	-----

### Technical Drawings



2D	ZIP
3D	ZIP

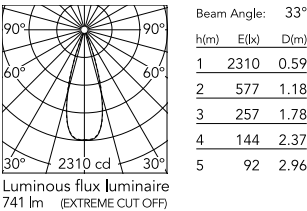

Schematic light drawing



Ecodesign and Energy  
Labelling



Replaceable (LED only)  
light source by a  
professional

Replaceable control  
gear by a professional

Photometric

Lighting type	Direct
Light distribution	Symmetric
CCT (K)	2700
CRI>	90
McAdam steps (SDCM)	3
LED Life / Failure Ratio	L80B20 >50.000h (Tc=85°C)
Beam angle C0-180 (°)	33
Beam angle C90-270 (°)	33
UGR <sub>L</sub>	<10

Electrical

Forward voltage (V)	12
LED current (mA)	900
Driver	Integral - Splice Box
Dimmable	Yes
Dimming type	Dimmable ELV, Dimmable 0-10V
Dimming interface	Remote Dimmable (Dimmer Not Included)

Notes

It requires a pre-installation frame, to be ordered separately.

Accessories & Power Supply



REQUIRED  
Accessory

Installation

08.0516.00.90  
Pre-installation No Trim Frame 4L  
Fix Adjustable

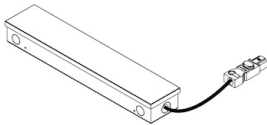

REQUIRED  
Power supply

SP20W900MA-ELV-C01  
Splice Box 9"x2.22"x1.25",  
900mA , 20W, ELV Dimmable,  
Thermal 120V

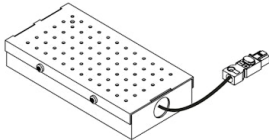

REQUIRED  
Power supply

SP25W900MA-120-A01  
Splice Box 9"x3.59"x1.25",  
900mA , 25W, 0-10V Dimmable,  
Thermal 120V

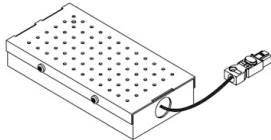

REQUIRED  
Power supply

SP25W900MA-277-A01  
Splice Box 9"x3.59"x1.25",  
900mA , 25W, 0-10V Dimmable,  
Thermal 277V

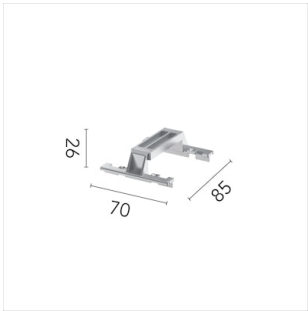

OPTIONAL  
Accessory

Installation

08.0059.90  
Accessory for mounting of No  
Trim Adjustable continuous line.

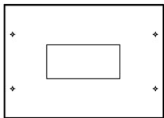

OPTIONAL  
Housing and Hanger Bar

TRAY-0038  
Registration Tray - non electrical,  
place holder for non IC new  
construction, for Light Shadow  
Adjustable 4 Lights Trim