

FLOS

F3305009 White

Kelvin Led Floor

Designed by Antonio Citterio/assistant Toan Nguyen, Antonio Citterio, 2011

8W - 285lm - 2700K

Part of the popular Kelvin LED family, the Kelvin LED F floor lamp features the collection's signature square head and utilizes the latest technology to provide precise customization of output. The three-step on/off switch utilizes Soft Touch technology, and the base cover is injection-printed PC (polycarbonate). The head is directional, the counterweight is an iron cut painted through a process of cataphoresis. The base separates from the lamp body, held in place with a safety-locking pin. Inspiration behind the design: Inspired by a love of industrial design, creators Antonio Citterio and Toan Nguyen developed the Kelvin family to blend seemingly simple structures with the most innovative technologies and materials.

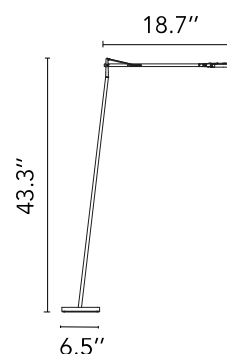

Are you a professional and your project needs consulting and support?

[BOOK AN APPOINTMENT](#)

Main specifications

Mounting	Floor
Environments	Indoor dry location
Light Source Type	LED
Light sources included	Yes
LED type	LED Module
Power (W)	8
System flux (lm)	285

Physical

Color	White
Length (in)	26.58
Cord color	Clear
Cord length (in)	59.055
Net weight (lb)	8.38
Package volume (in)	2281.01
IP internal	20

Download

Mounting instructions	Download PDF
Mounting instructions	Download PDF

Photometric Files

LDT / IES	Download LDT
-----------	------------------------------

Technical Drawings

2D	Download ZIP
3D	Download ZIP

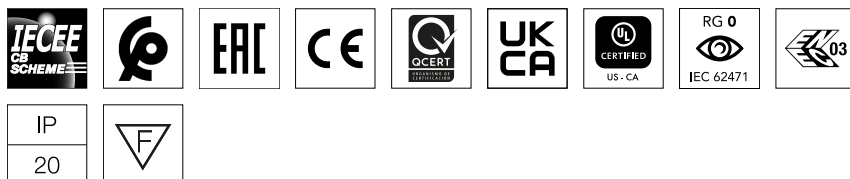

Schematic light drawing

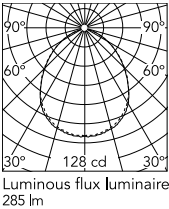

Photometric



Lighting type	Direct
Light distribution	Symmetric
CCT (K)	2700
Extreme cut off	No

Electrical



Insulation class	III
Frequency (Hz)	50/60
Main voltage (Vac)	100-240
Driver	Remote included
Dimmable	Yes
Dimming type	Electronic 24V
Dimming interface	Dimmer Integrated
Plug type	Type G, Type A, Type C
Batteries inside	No

Ecodesign and Energy Labelling

This product contains a light source of energy efficiency class F



Replaceable (LED only) light source by a professional



Replaceable control gear by an end-user

Spare Parts

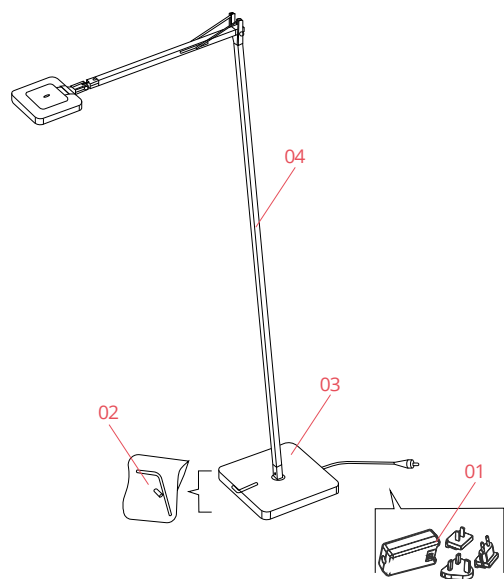

- | | | |
|-----|--|-----------|
| 01. | White plug assembly kit & 24V driver | RF6600209 |
| 02. | Kelvin Led Floor Kit with screw and allen keys | RF3320300 |
| 03. | Kelvin Led gm white base | F3322009A |



RF6600209

White plug assembly kit & 24V driver



RF3320300

Kelvin Led Floor Kit with screw and allen keys



F3322009A

Kelvin Led gm white base