

# FLOS

F3305009 White

## Kelvin Led Floor

Designed by Antonio Citterio/assistant Toan Nguyen, Antonio Citterio, 2011

8W - 285lm - 2700K

Floor lamp. Head in pressofused aluminium, diffuser in PC. Power pack on plug, base cover in injection printed PC, counterweight in iron cut and painted by means of a cataphoresis process. Directionable head. Three-step ON/OFF switch with Soft Touch technology. Base separated from the lamp body with safety locking pin.

Are you a professional and your project needs consulting and support?

BOOK AN APPOINTMENT

### Main specifications

Mounting	Floor
Environments	Indoor dry location
Light source type	LED
Light sources included	Yes
LED type	LED Module
Power (W)	8
Lumen Output (lm)	285

### Physical

Colour	White
Length (mm)	675
Cord colour	Clear
Cord length (mm)	1500
Net weight (kg)	3.8
Package volume (m3)	0.04
IP internal	20

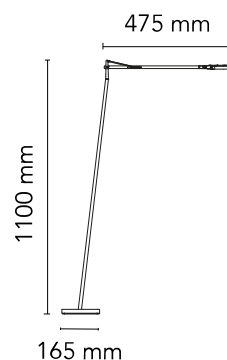

### Download

Mounting instructions [↓ PDF](#)

Mounting instructions [↓ PDF](#)

### Photometric Files

LDT / IES [↓ LDT](#)

### Technical Drawings

2D [↓ ZIP](#)

3D [↓ ZIP](#)

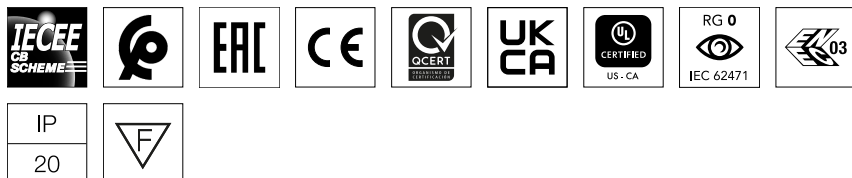

Schematic light drawing

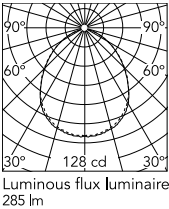

Photometric



Lighting type	Direct
Light distribution	Symmetric
CCT (K)	2700
Extreme cut off	No

Electrical



Insulation class	III
Frequency (Hz)	50/60
Main voltage (Vac)	100-240
Power supply	Remote included
Dimmable	Yes
Power supply type	Electronic 24V
Dimming interface	Dimmer Integrated
Plug type	Type G, Type A, Type C
Batteries inside	No

Ecodesign and Energy Labelling

This product contains a light source of energy efficiency class F



Replaceable (LED only) light source by a professional



Replaceable control gear by an end-user

Spare Parts

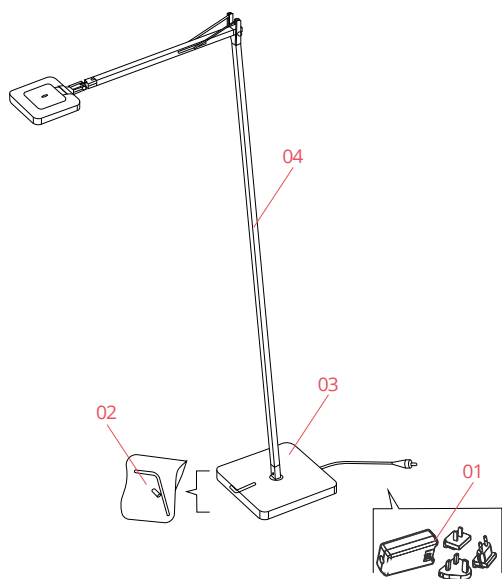

01.	White plug assembly kit & 24V driver	RF6600209
02.	Kelvin Led Floor Kit with screw and allen keys	RF3320300
03.	Kelvin Led gm white base	F3322009A
04.	Kelvin led Floor white body	F3306009



RF6600209

White plug assembly kit & 24V driver



RF3320300

Kelvin Led Floor Kit with screw and allen keys



F3322009A

Kelvin Led gm white base



F3306009

Kelvin led Floor white body