

FLOS

F3452033 Titanium

Kelvin Edge Base

Designed by Antonio Citterio, 2015

7W - 306lm - 2700-3200K - CRI> 90



Adjustable table lamp providing direct light. Aluminium painted or chromed body, with die cast head, joints and forks, and extruded arms. Diffuser in photoengraved polycarbonate and aluminate on the perimeter. Edge Lighting technology light source. Optical switch sensor placed on the head that provide 3-step dimming function and color temperature adjustment at 2700K or 3200K. Power cord length 150 cm. Plug-in power supply with interchangeable plugs.

Are you a professional and your project needs consulting and support?

BOOK AN APPOINTMENT

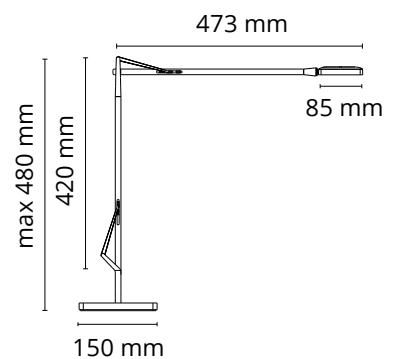

Main specifications

EAN	8059607004593
Mounting	Table
Environments	Indoor dry location
Light source type	LED
Light sources included	Yes
LED type	LED Module
Power (W)	7
Lumen Output (lm)	306

Physical

Colour	Titanium
Length (mm)	473
Cord colour	Black
Net weight (kg)	3.9
Package volume (m3)	0.02
IP internal	20

Download

Mounting instructions [Download PDF](#)

Mounting instructions [Download PDF](#)

Mounting instructions [Download PDF](#)

Photometric Files

LDT / IES [Download LDT](#)

Technical Drawings

2D [Download ZIP](#)



Schematic light drawing

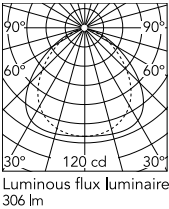

Photometric



Lighting type	Direct
Light distribution	Symmetric
CCT (K)	2700-3200
CRI>	90
Extreme cut off	No

Electrical

Insulation class	III
Frequency (Hz)	50/60
Main voltage (Vac)	100-240
Power supply	Remote included
Dimmable	Yes
Power supply type	Electronic 24V
Dimming interface	Dimmer Integrated
Plug type	Type G, Type A, Type C
Batteries inside	No

Ecodesign and Energy Labelling

This product contains a light source of energy efficiency class E



Replaceable (LED only) light source by a professional



Replaceable control gear by an end-user

Spare Parts

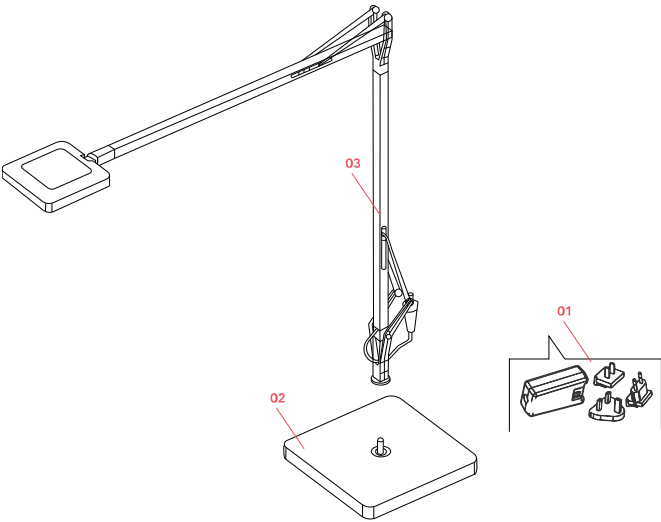

- | | | |
|-----|--------------------------------------|-----------|
| 01. | Black plug assembly kit & 24V driver | RF6600230 |
| 02. | Kelvin edge titanium base | F3451033 |
| 03. | Kelvin edge titanium body | F3450033 |



RF6600230
Black plug assembly kit & 24V
driver



F3451033
Kelvin edge titanium base



F3450033
Kelvin edge titanium body