

FLOS

03.4184.GL Gold

Kap Ø 80 Adjustable Optic Medium

Designed by FLOS Architectural, 2016



Recessed luminaire with LED light source. Power supply not included. Diffusing lens included.

Are you a professional and your project needs consulting and support?

[BOOK AN APPOINTMENT](#)

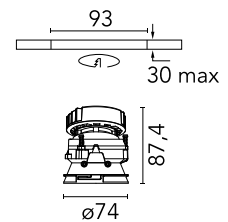

Main specifications

| | |
|-------------------|---------------------|
| Mounting | Ceiling recessed |
| Environments | Indoor dry location |
| Light Source Type | LED |
| LED type | LED array |
| Lamp category | LED |
| Iicos | No |
| Bulb finish | Clear |
| Number of heads | 1 |
| Power (W) | 9.2 |
| System power (W) | 9.2 |
| Source flux (lm) | 956 |
| System flux (lm) | 648 |
| Efficacy (lm/W) | 70 |

Physical

| | |
|--------------------------|------------|
| Colour | Gold |
| Trim | No |
| Orientation | Adjustable |
| Rotation (°) | 360 |
| Longitudinal tilting (°) | 20 |
| Transversal tilting (°) | 20 |
| Recessed depth (mm) | 91 |
| Spot diameter (mm) | 74 |
| Net weight (kg) | 0.24 |
| IP internal | 20 |
| IP external | 54 |

Download

[Mounting instructions](#)  PDF

Photometric Files

[LDT / IES](#)  ZIP

Technical Drawings

[2D](#)  ZIP

[3D](#)  ZIP

[Bim](#)  ZIP



Schematic light drawing

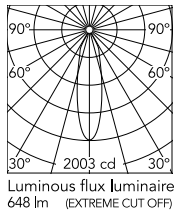

| h(m) | E(lx) | D(m) |
|------|-------|------|
| 1 | 2003 | 0.46 |
| 2 | 501 | 0.93 |
| 3 | 223 | 1.39 |
| 4 | 125 | 1.85 |
| 5 | 80 | 2.32 |

Ecodesign and Energy Labelling

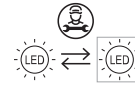

Replaceable (LED only)
light source by a
professional



Replaceable control
gear by a professional

Photometric

| | |
|--------------------------|-----------|
| Lighting type | Direct |
| Light distribution | Symmetric |
| CCT (K) | 3000 |
| CRI> | 90 |
| McAdam steps (SDCM) | 3 |
| LED Life / Failure Ratio | L80B50 |
| Beam angle C0-180 (°) | 26 |
| Beam angle C90-270 (°) | 26 |
| UGR _L | 12 |

Electrical

| | |
|---------------------|---|
| Insulation class | III |
| Frequency (Hz) | 0 |
| Main voltage (Vac) | 18 |
| Forward voltage (V) | 17.8 |
| LED current (mA) | 500 |
| Driver | Remote excluded |
| Dimmable | Yes |
| Dimming type | Non Dimmable, Dimmable DALI 2, Dimmable 0-10V, Dimmable Casambi, Dimmable 1-10V, Dimmable DALI 1, Mains Cut Dimming |
| Emergency type | No |

Notes

Diffusing lens included.

Accessories & Power Supply

Max. \varnothing 123



\varnothing 93



REQUIRED
Frame

Installation

08.9102.00

Installation frame No Trim



REQUIRED
Power supply

Electrical

60.9188

Continuous current power supply of 13-20W, 110*/240V - 50/60Hz with power current selected through adjustable 200 mA - 13W / 300 mA - 15W / 350 mA - 18W / 400 / 450 / 500 / 550 / 600 / 650 / 700 / 750 / 800 / 850 / 900 mA - 20W. switch. 0/1-10V or push...



REQUIRED
Power supply

Electrical

60.9207

Continuous current power supply, dimmable Casambi, 220/240V - 50/60Hz, 300mA - 16W / 350mA - 18,5W / 400mA - 21,5W / 450 mA - 24W / 500mA - 27W / 600mA - 32W / 650 mA - 35W / 700 mA - 36W /750 /800 /900 /1000 /1050 /1200 mA - 38W.



REQUIRED
Power supply

Electrical

60.9411

Continuous current power supply, 1-10V, regulable trailing & leading edge dimming (mains dimming) 220/240V - 50/60Hz, 500mA - 10W.



REQUIRED
Power supply

Electrical

60.9768

Non dimmable continuous current power supply of 220/240V - 50/60Hz with power current selected through adjustable with DIP-switch 350 mA - 7,3W / 400mA - 8,4W / 450 mA - 9,4W / 500 mA - 10,5W



REQUIRED
Power supply

Electrical

60.9826

Continuous current power supply of 12-20W, 110/240V - 50/60Hz with power current selected through DIP-switch 350mA - 15W / 500mA - 21W / 600mA - 26W / 700mA - 30W dimmable Dali 1, Dali 2 & PUSH

