

# FLOS

09.8405.SB Smooth Black

## Gustave Residential

Designed by Vincent Van Duysen, 2022



Gustave is a portable, self-powered luminaire, specially designed for tabletop lighting applications and other related uses as supplementary lighting. Gustave's compact size encloses a perfect mix of the most innovative optical and light technology and a disruptive engineering, developed in the service of a discretionary purpose of Flos for this project: to create the first portable luminaire on the market with circular design awareness, ecological and honestly conceived against obsolescence. Portable luminaire with autonomous battery, designed for residential applications. Powered by 'Button Type 18650 Li-Ion' batteries (2 units, included inside the product). USB-C charging cable (plug adapter not included). 0-100% sequential regulation by means of capacitive haptic push button.

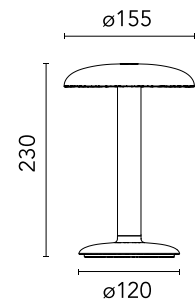

Are you a professional and your project needs consulting and support?

[BOOK AN APPOINTMENT](#)

### Main specifications

Mounting	Table
Light source type	LED
Light sources included	Yes
LED type	Top LED
Number of lamps	1
System power (W)	2.5
Source flux (lm)	221
System flux (lm)	159
Efficacy (lm/W)	69

### Physical

Colour	Smooth Black
Length (mm)	155
Cord colour	Black
Cord length (mm)	1200
Net weight (kg)	0.78
Package height (mm)	36
Package width (mm)	21
Package length (mm)	21
Package volume (m3)	0.02
IP internal	54

### Download

Mounting instructions [↓ PDF](#)

### Photometric Files

LDT / IES [↓ ZIP](#)

### Technical Drawings

2D [↓ ZIP](#)

3D [↓ ZIP](#)



## Schematic light drawing

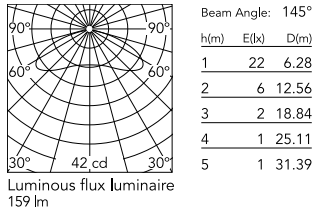

## Photometric

Lighting type	Direct
Light distribution	Roto symmetric
CCT (K)	2700
CRI>	90
McAdam steps (SDCM)	3
Rf fidelity index	93
Rg gamut index	100
Beam angle C0-180 (°)	144
Beam angle C90-270 (°)	144
Extreme cut off	No

## Electrical

Insulation class	III
LED current (mA)	180
Dimmable	Yes
Power supply type	Dimmable
Dimming interface	Dimmer Integrated
Plug type	Type A
Batteries inside	Yes
Battery type	LI-IO
Charging cycles guaranteed	500
Charging max power	1 A
Charging min time	5.5
Charging socket/connector	USB-C

## Notes

Product Battery autonomy: 100% - 6 hours / 50% - 10 hours / 25% - 18 hours.  
Batteries included. USB-A / USB-C Cable included. Adapter 5V, min 2A not included.

## Ecodesign and Energy Labelling

This product contains a light source of energy efficiency class **G**

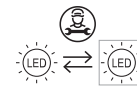

Replaceable (LED only) light source by a professional

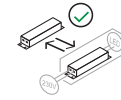

Replaceable control gear by an end-user

## Accessories & Power Supply



### REQUIRED

RF25965

Adapter 5V. Min 2A | EUR USA  
UK



### REQUIRED

RF27576

Adapter 5V. Min 2A. EUR / USA /  
UK

## Spare Parts

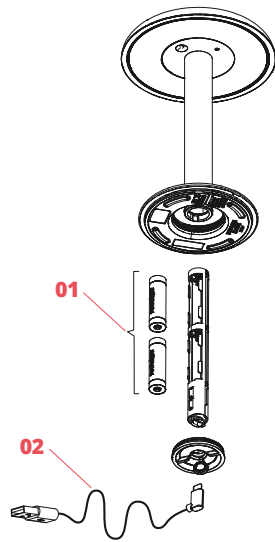

01.	Pack 2x Battery for Gustave Residential	08.0744.00
02.	Cable for Gustave Residential USB-A/USB-C	08.0761.14
02.	Cable for Gustave Residential USB-A/USB-C	08.0761.30



### Electrical

08.0744.00

Pack 2x Battery for Gustave Residential



### Cable

08.0761.14

Cable for Gustave Residential USB-A/USB-C



### Cable

08.0761.30

Cable for Gustave Residential USB-A/USB-C