

Bellhop Table

Designed by Edward Barber and Jay Osgerby, 2018

3W - 151lm - 2700K



Portable, rechargeable and wireless, Bellhop is a sleek modern LED tabletop lamp. Originally designed by renowned designers Edward Barber and Jay Osgerby for the London Design Museum. Made for the twenty-first century, Bellhop charges via a micro USB-C and holds a charge for up to 24 hours. Portable and elegant, Bellhop functions like a modern day candle by providing a soft atmospheric pool of light. British designers Edward Barber and Jay Osgerby pay homage to the hatted hotel porter, where it gets its name from. Bellhop introduced in two new colors in 2020: Grey Blue and Yellow to give a fresh touch and bring warm light into modern interiors. Available in 6 finishes: Brown, Burnt Orange, Grey, Grey Blue, White and Yellow. Features: Push-button switch positioned on the base provides the 4-step dimmer function. Battery status indicator positioned under the base. USB-C charging cable included. USB battery charging on plug with universal plugs. Remains charged up to 24 hours after fully charging the battery. Inspiration behind the design: Designed by Edward Barber and Jay Osgerby, Bellhop is a portable tabletop lamp that evokes the spirit of a modern day candle. The beloved, cordless tabletop can be carried around anywhere, bringing light where it is needed the most, casting a pool of direct light wherever it goes. "The Bellhop began when we designed a table lamp for the new London Design Museum. The table top Bellhop gives the user ultimate flexibility as a portable lamp. Bellhop casts an atmospheric pool of light and the portable version is like a modern day candle."

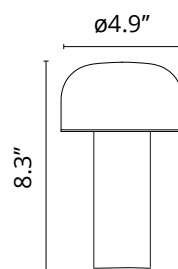

Download

Mounting instructions  PDF

Photometric Files

LDT / IES  LDT

Technical Drawings

2D  ZIP

3D  ZIP

Are you a professional and your project needs consulting and support?

[BOOK AN APPOINTMENT](#)

Main specifications

EAN	8059607001295
Mounting	Table
Environments	Indoor dry location
Light Source Type	LED
Light sources included	Yes
LED type	LED Module
Power (W)	3
System flux (lm)	151

Physical

Color	Yellow
Length (in)	4.92
Net weight (lb)	2.87
Package height (in)	7.87
Package width (in)	7.87
Package length (in)	12.99
Package volume (in)	805.52
IP internal	20

Ecodesign and Energy Labelling

This product contains a light source of energy efficiency class C

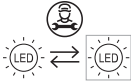

Replaceable (LED only) light source by a professional

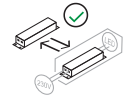

Replaceable control gear by an end-user



Schematic light drawing

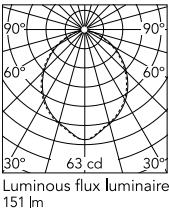

Photometric

Light distribution	Roto symmetric
CCT (K)	2700
Extreme cut off	No

Electrical

Insulation class	III
Frequency (Hz)	50/60
Main voltage (Vac)	100-240
Driver	Remote excluded
Dimmable	Yes
Dimming type	Electronic 5V
Dimming interface	Dimmer Integrated
Batteries inside	Yes
Battery type	LI-PO
Charging max power	14
Charging min time	3H - 0% TO 100%
Charging socket/connector	USB-C

Spare Parts

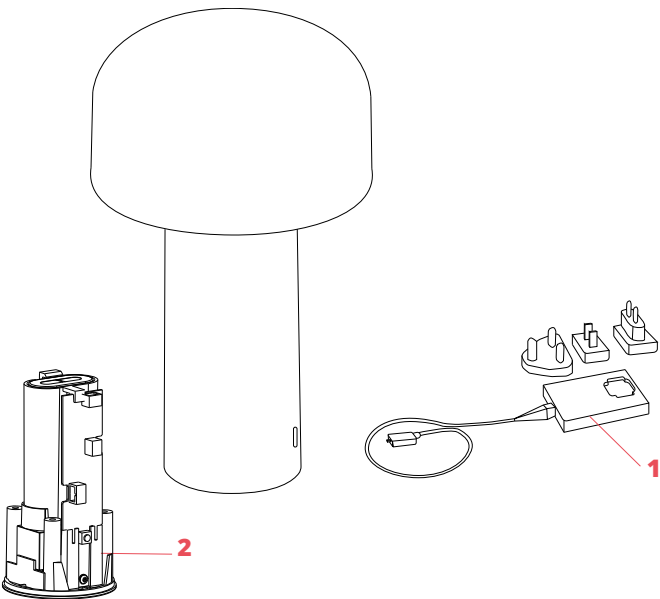

01. Power charger with electrical cable & plugs RF1035109



RF1035109

Power charger with electrical
cable & plugs