

# FLOS

60.9421

**Continuous current power supply of 7,2-24W, 220/240V - 50/60Hz with power current selected through adjustable 150 mA - 7,2W /200 mA - 9,5W /250 mA - 12W /300 mA -14,5W /350 mA -17W/400 mA - 19,5W /450 mA -21,5W /500 mA - 24W switch. Mains or push dimm...**



Are you a professional and your project needs consulting and support?

[BOOK AN APPOINTMENT](#)

## Main specifications

Power (W) 24

## Physical

Trim No

Length (mm) 166

Net weight (kg) 0.19

IP internal 20

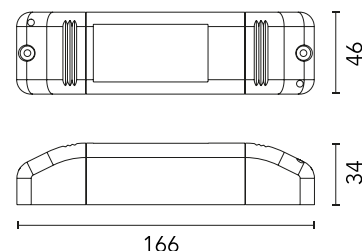

## Ecodesign and Energy Labelling

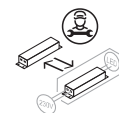

Replaceable control gear by a professional



<https://professional.flos.com/en/global/product/continuous-current-power-supply-of-7-2-24w-220-240v-50-60hz-with-power-current-selected-through-adjustable-150-ma-7-2w-200-ma-9-5w-250-ma-12w-300-ma-14-5w-350-ma-17w-400-ma-19-5w-450-ma-21-5w-500-ma-24w-switch.-mains-or-push-dimm...-60.9421/>

60.9421

## Photometric

Extreme cut off No

## Electrical

Insulation class	II
Frequency (Hz)	50/60
Main voltage (Vac)	220-240
LED current (mA)	150 / 200 / 250 / 300 / 350 / 400 / 450 / 500
Power supply	Remote
Dimmable	Yes
Power supply type	Dimmable Push, Mains Cut Dimming
Dimming range (%)	0.5 - 100
Dimming interface	Remote Dimmable (Dimmer Not Included)
Emergency	Yes
Batteries inside	No