

FLOS

■ F9550030A Black

Wan Ceiling/Wall

Designed by Johanna Grawunder, 2005



Halogen

Wall or ceiling fixture providing direct lighting. Aluminum body, available in shiny white, shiny black and shiny green finishes. Low glare shield. Provided by two different ring due to block the safety tempered glass, in black and green.

Are you a professional and your project needs consulting and support?

[BOOK AN APPOINTMENT](#)

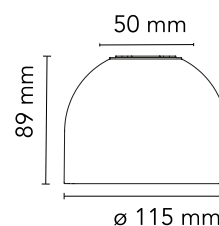

Main specifications

Mounting	Ceiling, Wall
Environments	Indoor dry location
Light source type	Bulb
Light sources included	No
Lamp category	Halogen
Lamp holders	G9
Ilcos	HSG
Number of lamps	1

Physical

Colour	Black
Length (mm)	115
Net weight (kg)	0.62
Package height (mm)	175
Package width (mm)	220
Package length (mm)	190
Package volume (m3)	0.01

Download

Mounting instructions [↓ PDF](#)

Photometric Files

LDT / IES [↓ LDT](#)

Technical Drawings

2D [↓ ZIP](#)

3D [↓ ZIP](#)



Schematic light drawing

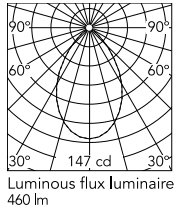

h(m)	E(lx)	D(m)
1	147	1.35
2	37	2.70
3	16	4.05
4	9	5.40
5	6	6.75

Photometric

Light distribution	Symmetric
Extreme cut off	No

Electrical

Insulation class	II
Frequency (Hz)	50/60
Main voltage (Vac)	220-250
Dimmable	Yes
Dimming interface	Remote Dimmable (Dimmer Not Included)
Batteries inside	No

Bulbs



NOT INCLUDED

RF18863

Halogen Lamp G9 33W 2700K

HALOPIN Dimmable

Spare Parts

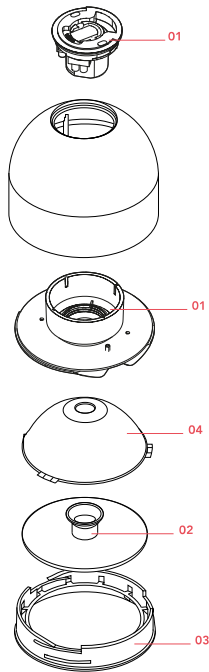

- | | | |
|-----|--|-----------|
| 01. | New type attachment assembly with g9 lamp holder and safety ring | RF9550300 |
| 02. | Wan glass assembly | RF9550200 |
| 03. | External ring | RF13990 |
| 04. | Reflector / ring assembly | RF9550130 |



RF9550300
New type attachment assembly
with g9 lamp holder and safety
ring



RF9550200
Wan glass assembly



RF13990
External ring



RF9550130
Reflector / ring assembly