

FLOS

05.9035.ES Brushed Bronze

Light Shadow Spot 45 Dimmer On Board

Designed by FLOS Architectural, 2022



10W - 686lm - 3000K - CRI> 90 - Beam° 15

LED accent lighting module for installation in The Tracking Magnet or Infra-Structure systems. For wireless control of luminaires, please select Casambi integrated versions. Accessories available, (honeycomb and CCT dichroic filters).

Are you a professional and your project needs consulting and support?

[BOOK AN APPOINTMENT](#)

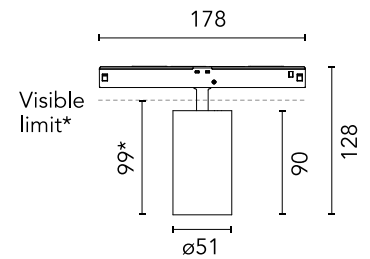

*installed in The Tracking Magnet

Main specifications

| | |
|------------------------|---------------------|
| Mounting | Track |
| Environments | Indoor dry location |
| Light source type | LED |
| Light sources included | Yes |
| LED type | LED array |
| Number of lamps | 1 |
| Power (W) | 10 |
| Source flux (lm) | 844 |
| Lumen Output (lm) | 686 |

Physical

| | |
|--------------------------|----------------|
| Colour | Brushed Bronze |
| Orientation | Adjustable |
| Rotation (°) | 360 |
| Longitudinal tilting (°) | 90 |
| Net weight (kg) | 0.25 |
| IP internal | 20 |

Download

Mounting instructions [↓ PDF](#)

Photometric Files

LDT / IES [↓ ZIP](#)

Technical Drawings

2D [↓ ZIP](#)

3D [↓ ZIP](#)



Schematic light drawing

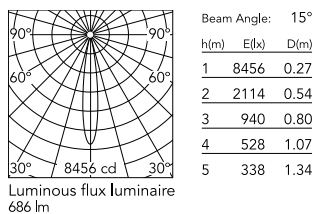

Photometric

| | |
|--------------------------|-----------------------|
| Lighting type | Direct |
| Light distribution | Symmetric |
| CCT (K) | 3000 |
| CRI> | 90 |
| Rf fidelity index | 92 |
| Rg gamut index | 100 |
| LED Life / Failure Ratio | L80B50>47.000h_Tc85°C |
| Beam angle C0-180 (°) | 15 |
| Beam angle C90-270 (°) | 15 |
| UGR _L | <10 |

Electrical

| | |
|---------------------|-----------------|
| Insulation class | III |
| Forward voltage (V) | 48 |
| LED current (mA) | 250 |
| Power supply | Remote excluded |
| Dimmable | No |
| Power supply type | Non Dimmable |

Ecodesign and Energy Labelling

This product contains a light source of energy efficiency class G



Accessories & Power Supply



OPTIONAL
Filter

08.0793.00

Honeycomb



OPTIONAL
Filter

Optical

08.0794.00

CCT Inreaser Filter D58



OPTIONAL
Filter

Optical

08.0795.00

CCT Decreaser Filter