

# FLOS

05.9131.ES.DA Brushed Bronze

## Light Shadow Spot 45 Dali Version

Designed by FLOS Architectural, 2022

10W - 645lm - 2700K - CRI> 90 - Beam° 21



LED accent lighting module for installation in The Running Magnet system. For wireless control of luminaires, please select Casambi integrated versions. Accessories available, (honeycomb and CCT dichroic filters).

Are you a professional and your project needs consulting and support?

[BOOK AN APPOINTMENT](#)

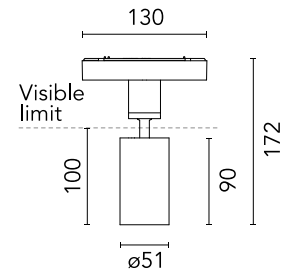

### Main specifications

|                        |                     |
|------------------------|---------------------|
| Mounting               | Track               |
| Environments           | Indoor dry location |
| Light source type      | LED                 |
| Light sources included | Yes                 |
| LED type               | LED array           |
| Number of lamps        | 1                   |
| Power (W)              | 10                  |
| Source flux (lm)       | 756                 |
| Lumen Output (lm)      | 645                 |

### Physical

|                          |                |
|--------------------------|----------------|
| Colour                   | Brushed Bronze |
| Orientation              | Adjustable     |
| Rotation (°)             | 360            |
| Longitudinal tilting (°) | 90             |
| Net weight (kg)          | 0.25           |
| IP internal              | 20             |

### Download

Mounting instructions [↓ PDF](#)

### Photometric Files

LDT / IES [↓ ZIP](#)

### Technical Drawings

2D [↓ ZIP](#)

3D [↓ ZIP](#)



## Schematic light drawing

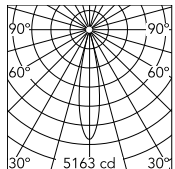

Beam Angle: 21°

| h(m) | E(lx) | D(m) |
|------|-------|------|
| 1    | 5163  | 0.36 |
| 2    | 1291  | 0.73 |
| 3    | 574   | 1.09 |
| 4    | 323   | 1.46 |
| 5    | 207   | 1.82 |

Luminous flux luminaire  
645 lm

## Photometric

|                          |                       |
|--------------------------|-----------------------|
| Lighting type            | Direct                |
| Light distribution       | Symmetric             |
| CCT (K)                  | 2700                  |
| CRI>                     | 90                    |
| Rf fidelity index        | 93                    |
| Rg gamut index           | 99                    |
| LED Life / Failure Ratio | L80B50>47.000h_Tc85°C |
| Beam angle C0-180 (°)    | 21                    |
| Beam angle C90-270 (°)   | 21                    |
| UGR <sub>L</sub>         | <10                   |

## Electrical

|                     |                 |
|---------------------|-----------------|
| Insulation class    | III             |
| Forward voltage (V) | 24              |
| LED current (mA)    | 680             |
| Power supply        | Remote          |
| Dimmable            | Yes             |
| Power supply type   | Dimmable DALI 2 |
| Dimming range (%)   | 1-100           |

## Ecodesign and Energy Labelling

This product contains a light source of energy efficiency class G



## Accessories & Power Supply



OPTIONAL  
Filter

08.0793.00

Honeycomb



OPTIONAL  
Filter

Optical

08.0794.00

CCT Inreaser Filter D58



OPTIONAL  
Filter

Optical

08.0795.00

CCT Decreaser Filter