

# FLOS

05.9002.40.DA White

## Light Shadow Spot 30 Dali Version

Designed by FLOS Architectural, 2022



4.5W - 200lm - 2700K - CRI> 90 - Beam° 33

LED accent lighting module for installation in The Tracking Magnet or Infra-Structure systems. For wireless control of luminaires, please select Casambi integrated versions. Accessories available, (honeycomb and CCT dichroic filters).

Are you a professional and your project needs consulting and support?

[BOOK AN APPOINTMENT](#)

### Main specifications

Mounting	Track
Environments	Indoor dry location
Light source type	LED
Light sources included	Yes
LED type	Power LED
Number of lamps	1
Power (W)	4.5
Source flux (lm)	257
Lumen Output (lm)	200

### Physical

Colour	White
Orientation	Adjustable
Rotation (°)	360
Longitudinal tilting (°)	90
Net weight (kg)	0.14
IP internal	20

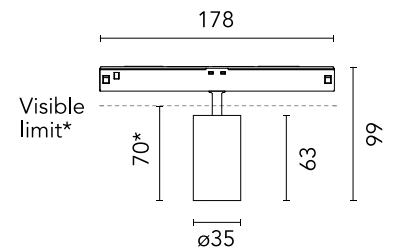

\*installed in The Tracking Magnet

### Download

Mounting instructions [↓ PDF](#)

### Photometric Files

LDT / IES [↓ ZIP](#)

### Technical Drawings

2D [↓ ZIP](#)

3D [↓ ZIP](#)

[Bim](#) [↓ ZIP](#)



## Schematic light drawing

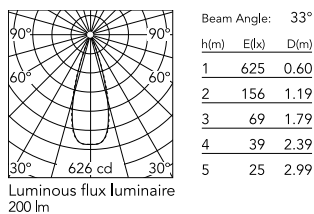

## Photometric

Lighting type	Direct
Light distribution	Symmetric
CCT (K)	2700
CRI>	90
Rf fidelity index	92
Rg gamut index	100
LED Life / Failure Ratio	L80B50>60.000h_Tc85°C
Beam angle C0-180 (°)	33
Beam angle C90-270 (°)	33
UGR <sub>L</sub>	<10

## Electrical

Insulation class	III
Forward voltage (V)	48
LED current (mA)	900
Power supply	Remote excluded
Dimmable	Yes
Power supply type	Dimmable DALI 2
Dimming range (%)	1-100

## Ecodesign and Energy Labelling

This product contains a light source of energy efficiency class G

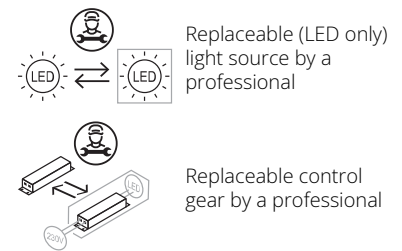

## Accessories & Power Supply



OPTIONAL  
Filter

08.0790.00

Honeycomb



OPTIONAL  
Filter

Optical

08.0791.00

CCT Increaser Filter D58



OPTIONAL  
Filter

Optical

08.0792.00

CCT Decreaser Filter D12