

FLOS

05.9007.40.CB White

Light Shadow Spot 30 Casambi

Designed by FLOS Architectural, 2022



4W - 204lm - 3000K - CRI> 90 - Beam° 33

LED accent lighting module for installation in The Tracking Magnet or Infra-Structure systems. For wireless control of luminaires, please select Casambi integrated versions. Accessories available, (honeycomb and CCT dichroic filters).

Are you a professional and your project needs consulting and support?

[BOOK AN APPOINTMENT](#)

Main specifications

| | |
|------------------------|---------------------|
| Mounting | Track |
| Environments | Indoor dry location |
| Light source type | LED |
| Light sources included | Yes |
| LED type | Power LED |
| Number of lamps | 1 |
| Power (W) | 4 |
| Source flux (lm) | 263 |
| Lumen Output (lm) | 204 |

Physical

| | |
|--------------------------|------------|
| Colour | White |
| Orientation | Adjustable |
| Rotation (°) | 360 |
| Longitudinal tilting (°) | 90 |
| Net weight (kg) | 0.14 |
| IP internal | 20 |

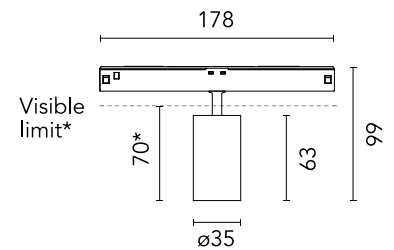

*installed in The Tracking Magnet

Download

[Mounting instructions](#) PDF

Photometric Files

[LDT / IES](#) ZIP

Technical Drawings

[2D](#) ZIP

[3D](#) ZIP

[Bim](#) ZIP



Schematic light drawing

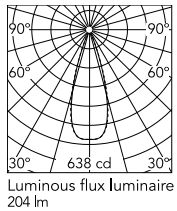

Beam Angle: 33°

| h(m) | E(lx) | D(m) |
|------|-------|------|
| 1 | 638 | 0.60 |
| 2 | 159 | 1.19 |
| 3 | 71 | 1.79 |
| 4 | 40 | 2.39 |
| 5 | 26 | 2.99 |

Photometric

| | |
|--------------------------|-----------------------|
| Lighting type | Direct |
| Light distribution | Symmetric |
| CCT (K) | 3000 |
| CRI> | 90 |
| Rf fidelity index | 90 |
| Rg gamut index | 101 |
| LED Life / Failure Ratio | L80B50>60.000h_Tc85°C |
| Beam angle C0-180 (°) | 33 |
| Beam angle C90-270 (°) | 33 |
| UGR _L | <10 |

Electrical

| | |
|---------------------|------------------|
| Insulation class | III |
| Forward voltage (V) | 48 |
| LED current (mA) | 900 |
| Power supply | Remote excluded |
| Dimmable | Yes |
| Power supply type | Dimmable Casambi |
| Dimming range (%) | 1-100 |

Ecodesign and Energy Labelling

This product contains a light source of energy efficiency class G



Accessories & Power Supply



OPTIONAL
Filter

08.0790.00

Honeycomb



OPTIONAL
Filter

Optical

08.0791.00

CCT Increaser Filter D58



OPTIONAL
Filter

Optical

08.0792.00

CCT Decreaser Filter D12