

FLOS

05.9514.ES.9S Black/Bronze/Black

Light Shadow Pro Ø45 Push Medium - IC Rated

NEW

Designed by FLOS Architectural, 2022



Luminaire with 2x1 functionality: it can work as downlight (recessed, flush with ceiling) or as a projector (fully adjustable). The passage from one position to the other can be made by moving the product easily by hand. Necessary installation pre-frames, not included (to be ordered separately). Requires a power supply unit which is not included, to be ordered separately according to recommendations.

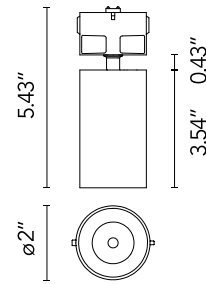

Are you a professional and your project needs consulting and support?

BOOK AN APPOINTMENT

Main specifications

EAN	Valencia
Mounting	Ceiling recessed
Environments	Indoor dry location
Light Source Type	LED
Light sources included	Yes
LED type	LED array
Lamp category	LED
Number of lamps	1
Power (W)	6
System power (W)	8.2
Source flux (lm)	643
System flux (lm)	519

Physical

Color	Black/Bronze/Black
Trim	No
Orientation	Adjustable
Recessed depth (in)	5.91
Net weight (lb)	0.51
IP internal	20
IP external	20

Download

Family spec sheet	ZIP
Mounting instructions	PDF
Mounting instructions	PDF

Photometric Files

LDT / IES	ZIP
-----------	-----

Technical Drawings

2D	ZIP
3D	ZIP

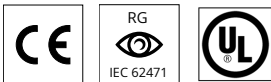

Schematic light drawing

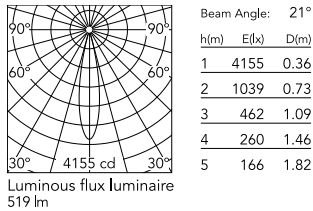

Photometric

Lighting type	Direct
Light distribution	Symmetric
CCT (K)	2700
CRI>	90
McAdam steps (SDCM)	3
LED Life / Failure Ratio	L80B50>60.000h_Tc85°C
Beam angle C0-180 (°)	21
Beam angle C90-270 (°)	21
Extreme cut off	Yes
UGR _L	<10

Electrical

Forward voltage (V)	12
LED current (mA)	500
Driver	Remote
Dimmable	Yes
Dimming interface	Remote Dimmable (Dimmer Not Included)

Ecodesign and Energy Labelling

This product contains a light source of energy efficiency class G



Notes

Light Shadow Push can be placed in top position, functioning as a downlight (perfectly flush to ceiling), or in bottom position, functioning as an adjustable spotlight. IC Rated- Inherently protected. Ceiling recessed IC-rated - Mud-in

Accessories & Power Supply



REQUIRED Frame

08.0757.00.9S

Installation Frame No Trim Light
Shadow Pro Ø45 Push

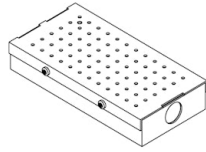

REQUIRED Power supply

Electrical

SP12W500MA-10V-T01

Splice Box UL 7"x3-5/8"x1-1/4",
UL. With Eldoled Eco Drive 12W
series Driver Programmed to
500mA , 0-10V Dim 120-277V