

# FLOS

05.5126.ES.CB Brushed Bronze

## Find Me 2 Casambi Dimmable

Designed by FLOS Architectural, 2023



10.5W - 489lm - 3000K - CRI> 90 - Beam° 19

LED projection lighting module for installation in the Zero Track Pro system. Electronic DC/DC converter incorporated. Individual wireless adjustment via Casambi. Casambi control implemented via the FLOS Control® app for mobile devices (available in the Apple Store and Google Play). Accessories included (honeycomb grid and protection bar).

Are you a professional and your project needs consulting and support?

[BOOK AN APPOINTMENT](#)

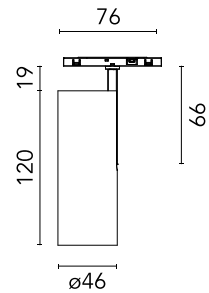

### Main specifications

|                        |                     |
|------------------------|---------------------|
| Mounting               | Track               |
| Environments           | Indoor dry location |
| Light source type      | LED                 |
| Light sources included | Yes                 |
| LED type               | Power LED           |
| Number of lamps        | 1                   |
| Power (W)              | 10.5                |
| Source flux (lm)       | 781                 |
| Lumen Output (lm)      | 489                 |

### Physical

|                          |                |
|--------------------------|----------------|
| Colour                   | Brushed Bronze |
| Orientation              | Adjustable     |
| Rotation (°)             | 360            |
| Longitudinal tilting (°) | 90             |
| Net weight (kg)          | 0.3            |
| IP internal              | 20             |

### Download

Mounting instructions [↓ PDF](#)

### Photometric Files

LDT / IES [↓ ZIP](#)

### Technical Drawings

2D [↓ ZIP](#)

3D [↓ ZIP](#)



## Schematic light drawing

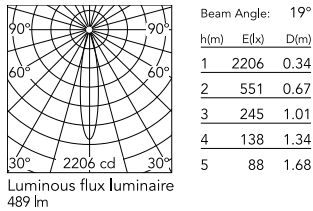

## Photometric

|                        |           |
|------------------------|-----------|
| Lighting type          | Direct    |
| Light distribution     | Symmetric |
| CCT (K)                | 3000      |
| CRI>                   | 90        |
| McAdam steps (SDCM)    | 2         |
| Beam angle C0-180 (°)  | 19        |
| Beam angle C90-270 (°) | 19        |
| Extreme cut off        | No        |
| UGR <sub>L</sub>       | <10       |

## Electrical

|                     |                                       |
|---------------------|---------------------------------------|
| Insulation class    | III                                   |
| Forward voltage (V) | 24                                    |
| LED current (mA)    | 765                                   |
| Power supply        | Remote excluded                       |
| Dimmable            | Yes                                   |
| Power supply type   | Dimmable Casambi                      |
| Dimming interface   | Remote Dimmable (Dimmer Not Included) |

## Ecodesign and Energy Labelling

This product contains a light source of energy efficiency class G



Non-replaceable light source



Replaceable control gear by a professional