

FLOS

03.8120.14 Black

Blind Tube 900 mm

Designed by Vincent Van Duysen, 2017

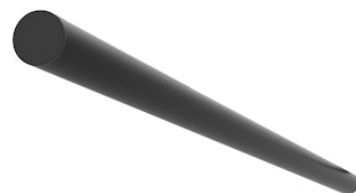

Length: 944 - Ceiling surface

A mechanical module (without lighting) to be installed in the system infrastructure. Fixing components that rotate 0°-90°, with a magnetic connection and a mechanical safety lock. To be installed transversely between two profile lines.

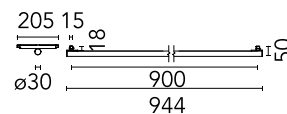

Are you a professional and your project needs consulting and support?

[BOOK AN APPOINTMENT](#)

Main specifications

Mounting	Ceiling surface
Environments	Indoor dry location
Light sources included	no

Physical

Colour	Black
Length (mm)	944
Net weight (kg)	0.75
IP internal	20

Download

[Mounting instructions](#)

