

# FLOS

03.8122.14 Black

## Blind Tube 1500 mm

Designed by Vincent Van Duysen, 2017

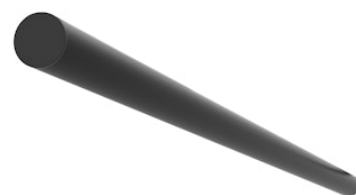

Length: 1544 - Ceiling surface

A mechanical module (without lighting) to be installed in the system infrastructure. Fixing components that rotate 0°-90°, with a magnetic connection and a mechanical safety lock. To be installed transversely between two profile lines.

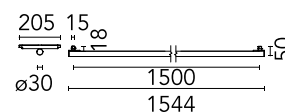

Are you a professional and your project needs consulting and support?

[BOOK AN APPOINTMENT](#)

### Main specifications

Mounting	Ceiling surface
Environments	Indoor dry location
Light sources included	no

### Physical

Colour	Black
Length (mm)	1544
Net weight (kg)	1.11
IP internal	20

### Download

[Mounting instructions](#)

