

# FLOS

F1090031 Matte Black

## Black Flag

Designed by Konstantin Grcic, 2023

75W - 2700K - CRI> 90

Black Flag is an extendable wall light that offers flexibility of illumination thanks to the expanding aluminium arm reaching up to 3.5meters from a wall-mounted frame of the same material. Wall lamp and sculptural centre piece, Black Flag embodies Grcic's industrial design expertise and demonstrates the experimental opportunities of his approach mixed with Flos' technical expertise. The luminaire provides direct and indirect lighting. Greater Up/Down light intensity can be controlled through the dedicated touch buttons featured in the stem. Touch panel control integrated on the lamp arm for On-off and Up/Down dimming unified with on board button. Possibility of wiring from a light point or through an IEC plug. Color temperature 2700°K CRI 90.

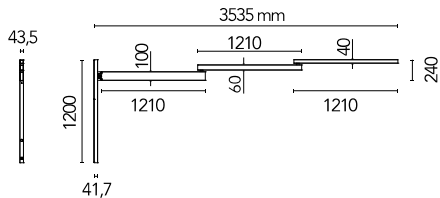

Are you a professional and your project needs consulting and support?

BOOK AN APPOINTMENT

### Main specifications

EAN	8059607058138
Mounting	Wall
Environments	Indoor dry location
Light source type	LED
Light sources included	Yes
LED type	LED Module
Power (W)	75
System power (W)	75

### Physical

Colour	Matte Black
Cord colour	Black
Canopy colour	Black
Canopy length/diameter (mm)	1200
Canopy width (mm)	43
Canopy height (mm)	43
Net weight (kg)	17
Package volume (m3)	0.08
IP internal	20

### Download

Mounting instructions [Download PDF](#)

### Photometric Files

LDT / IES [Download ZIP](#)

### Technical Drawings

2D [Download ZIP](#)

3D [Download ZIP](#)



Schematic light drawing

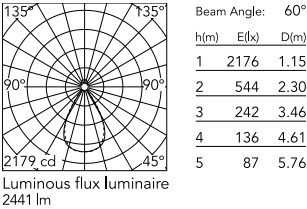

Ecodesign and Energy  
Labelling

Replaceable (LED only)  
light source by an end-  
user

Replaceable control  
gear by a professional

Photometric

Lighting type	Direct, Indirect
CCT (K)	2700
CRI>	90
Extreme cut off	No

Electrical

Insulation class	I
Frequency (Hz)	50/60
Main voltage (Vac)	220-240
Power supply	Integrated
Dimmable	Yes
Power supply type	Dimmable
Dimming interface	Dimmer Integrated

Spare Parts

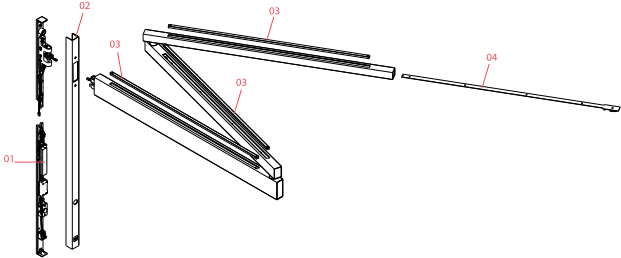

- |     |  |         |
|-----|--|---------|
| 01. | Driver 96W 48V 220-240V                | RF32405 |
| 02. | Black Flag Eu cover assembly           | RF35308 |
| 03. | Black Flag up stripe assembly          | RF35321 |
| 04. | Black Flag down 2700°K stripe assembly | RF35320 |



RF32405

Driver 96W 48V 220-240V



RF35308

Black Flag Eu cover assembly



RF35321

Black Flag up stripe assembly



RF35320

Black Flag down 2700°K stripe assembly