

FLOS

05.5140.14.DA Black

Atom 90 Dali Dimmable

Designed by FLOS Architectural, 2023



5.5W - 224lm - 2700K - CRI> 90 - Beam° 14

LED projection lighting module for installation in the Zero Track Pro system.
Electronic DC/DC converter incorporated. Individual control via DALI protocol and broadcast mode via 1-10V.

Are you a professional and your project needs consulting and support?

[BOOK AN APPOINTMENT](#)

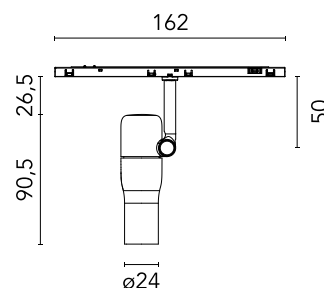

Main specifications

| | |
|------------------------|---------------------|
| Mounting | Track |
| Environments | Indoor dry location |
| Light source type | LED |
| Light sources included | Yes |
| LED type | Power LED |
| Number of lamps | 1 |
| Power (W) | 5.5 |
| Source flux (lm) | 432 |
| Lumen Output (lm) | 224 |
| Efficacy (lm/W) | 41 |

Physical

| | |
|--------------------------|------------|
| Colour | Black |
| Orientation | Adjustable |
| Rotation (°) | 360 |
| Longitudinal tilting (°) | 90 |
| Net weight (kg) | 0.1 |
| IP internal | 20 |

Download

[Mounting instructions](#)  PDF

Photometric Files

[LDT / IES](#)  ZIP

Technical Drawings

[2D](#)  ZIP

[3D](#)  ZIP



Schematic light drawing

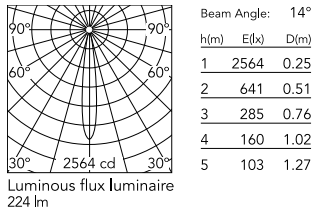

Photometric

| | |
|------------------------|-----------|
| Lighting type | Direct |
| Light distribution | Symmetric |
| CCT (K) | 2700 |
| CRI> | 90 |
| McAdam steps (SDCM) | 2 |
| Beam angle C0-180 (°) | 14 |
| Beam angle C90-270 (°) | 14 |
| UGR _L | <10 |

Electrical

| | |
|---------------------|---------------------------------------|
| Insulation class | III |
| Forward voltage (V) | 24 |
| LED current (mA) | 400 |
| Power supply | Remote excluded |
| Dimmable | Yes |
| Power supply type | Dimmable DALI 2 |
| Dimming range (%) | 1-100 |
| Dimming interface | Remote Dimmable (Dimmer Not Included) |

Ecodesign and Energy Labelling

This product contains a light source of energy efficiency class G



Non-replaceable light source



Replaceable control gear by a professional