

FLOS

09.3933.05A Polished Silver

Atom 90 Casambi integrated

Designed by Piero Lissoni, 2020



Accent lighting LED module. Incorporated DC/DC electronic converter. Casambi via Flos Control App to individually control the lights.

Are you a professional and your project needs consulting and support?

[BOOK AN APPOINTMENT](#)

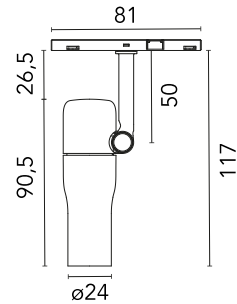

Main specifications

Mounting	Track
Environments	Indoor dry location
Light source type	LED
Light sources included	Yes
LED type	Power LED
Number of lamps	1
Power (W)	4.7
Source flux (lm)	450
Lumen Output (lm)	250
Efficacy (lm/W)	54

Physical

Colour	Polished Silver
Trim	No
Orientation	Adjustable
Rotation (°)	360
Longitudinal tilting (°)	90
Spot diameter (mm)	23
Net weight (kg)	0.1
IP internal	20

Download

[Mounting instructions](#) PDF

[Item information](#) JPG

Photometric Files

[LDT / IES](#) ZIP

Technical Drawings

[2D](#) ZIP

[3D](#) ZIP



Schematic light drawing

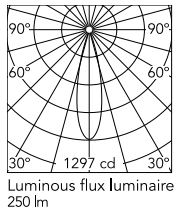

Beam Angle: 25°

h(m)	E(lx)	D(m)
1	1297	0.45
2	324	0.89
3	144	1.34
4	81	1.79
5	52	2.23

Ecodesign and Energy

Labelling

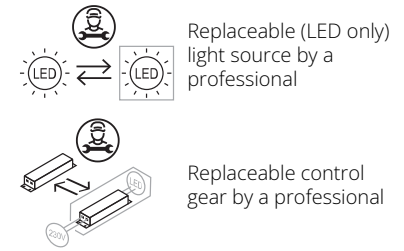

Photometric

Lighting type	Direct
Light distribution	Symmetric
CCT (K)	2700
CRI>	90
McAdam steps (SDCM)	3
LED Life / Failure Ratio	L80B50>50.000h (Tc=85°C)
Beam angle C0-180 (°)	25
Beam angle C90-270 (°)	25
Extreme cut off	No
UGR _L	<10

Electrical

Insulation class	III
Forward voltage (V)	24
LED current (mA)	330
Power supply	Remote excluded
Dimmable	Yes
Power supply type	Dimmable Casambi
Dimming range (%)	1-100

Notes

Accessories included (honeycomb and screening crosspiece). The control system with the Casambi version of light fixtures is directly and individually regulated wirelessly using the application FLOS Control® powered by Casambi.