

# FLOS

05.5146.40.1V White

## Atom 90 1-10V Dimmable

Designed by FLOS Architectural, 2023



5.5W - 289lm - 3000K - CRI> 90 - Beam° 25

LED projection lighting module for installation in the Zero Track Pro system.  
Electronic DC/DC converter incorporated. Individual control via DALI protocol and broadcast mode via 1-10V.

Are you a professional and your project needs consulting and support?

[BOOK AN APPOINTMENT](#)

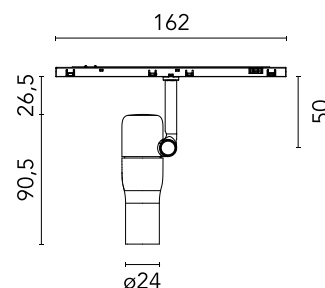

### Main specifications

|                        |                     |
|------------------------|---------------------|
| Mounting               | Track               |
| Environments           | Indoor dry location |
| Light source type      | LED                 |
| Light sources included | Yes                 |
| LED type               | Power LED           |
| Number of lamps        | 1                   |
| Power (W)              | 5.5                 |
| Source flux (lm)       | 446                 |
| Lumen Output (lm)      | 289                 |
| Efficacy (lm/W)        | 53                  |

### Physical

|                          |            |
|--------------------------|------------|
| Colour                   | White      |
| Orientation              | Adjustable |
| Rotation (°)             | 360        |
| Longitudinal tilting (°) | 90         |
| Net weight (kg)          | 0.1        |
| IP internal              | 20         |

### Download

[Mounting instructions](#)  PDF

### Photometric Files

[LDT / IES](#)  ZIP

### Technical Drawings

[2D](#)  ZIP

[3D](#)  ZIP



## Schematic light drawing

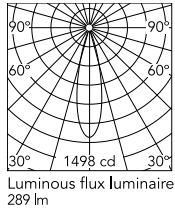

## Photometric

|                        |           |
|------------------------|-----------|
| Lighting type          | Direct    |
| Light distribution     | Symmetric |
| CCT (K)                | 3000      |
| CRI>                   | 90        |
| McAdam steps (SDCM)    | 2         |
| Beam angle C0-180 (°)  | 25        |
| Beam angle C90-270 (°) | 25        |
| UGR <sub>L</sub>       | <10       |

## Electrical

|                     |                                       |
|---------------------|---------------------------------------|
| Insulation class    | III                                   |
| Forward voltage (V) | 24                                    |
| LED current (mA)    | 400                                   |
| Power supply        | Remote excluded                       |
| Dimmable            | Yes                                   |
| Power supply type   | Dimmable 1-10V                        |
| Dimming range (%)   | 1-100                                 |
| Dimming interface   | Remote Dimmable (Dimmer Not Included) |

## Ecodesign and Energy Labelling

This product contains a light source of energy efficiency class G



Non-replaceable light source



Replaceable control gear by a professional