

FLOS

05.5145.40.1V White

Atom 90 1-10V Dimmable

Designed by FLOS Architectural, 2023



5.5W - 247lm - 3000K - CRI> 90 - Beam° 14

LED projection lighting module for installation in the Zero Track Pro system.
Electronic DC/DC converter incorporated. Individual control via DALI protocol and broadcast mode via 1-10V.

Are you a professional and your project needs consulting and support?

[BOOK AN APPOINTMENT](#)

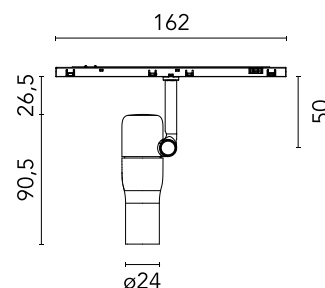

Main specifications

Mounting	Track
Environments	Indoor dry location
Light source type	LED
Light sources included	Yes
LED type	Power LED
Number of lamps	1
Power (W)	5.5
Source flux (lm)	446
Lumen Output (lm)	247
Efficacy (lm/W)	45

Physical

Colour	White
Orientation	Adjustable
Rotation (°)	360
Longitudinal tilting (°)	90
Net weight (kg)	0.1
IP internal	20

Download

[Mounting instructions](#)  PDF

Photometric Files

[LDT / IES](#)  ZIP

Technical Drawings

[2D](#)  ZIP

[3D](#)  ZIP



Schematic light drawing

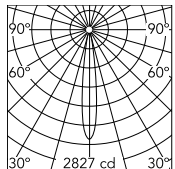

Beam Angle: 14°

h(m)	E(lx)	D(m)
1	2827	0.25
2	707	0.51
3	314	0.76
4	177	1.02
5	113	1.27

Luminous flux luminaire
247 lm

Photometric

Lighting type	Direct
Light distribution	Symmetric
CCT (K)	3000
CRI>	90
McAdam steps (SDCM)	2
Beam angle C0-180 (°)	14
Beam angle C90-270 (°)	14
UGR _L	<10

Electrical

Insulation class	III
Forward voltage (V)	24
LED current (mA)	400
Power supply	Remote excluded
Dimmable	Yes
Power supply type	Dimmable 1-10V
Dimming range (%)	1-100
Dimming interface	Remote Dimmable (Dimmer Not Included)

Ecodesign and Energy Labelling

This product contains a light source of energy efficiency class G



Non-replaceable light source



Replaceable control gear by a professional