

FLOS

05.5141.14.1V Black

Atom 90 1-10V Dimmable

Designed by FLOS Architectural, 2023

5.5W - 261lm - 2700K - CRI> 90 - Beam° 25



LED projection lighting module for installation in the Zero Track Pro system.
Electronic DC/DC converter incorporated. Individual control via DALI protocol and broadcast mode via 1-10V.

Are you a professional and your project needs consulting and support?

[BOOK AN APPOINTMENT](#)

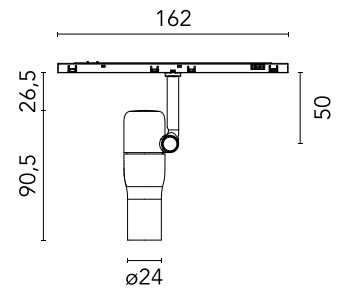

Main specifications

Mounting	Track
Environments	Indoor dry location
Light source type	LED
Light sources included	Yes
LED type	Power LED
Number of lamps	1
Power (W)	5.5
Source flux (lm)	432
Lumen Output (lm)	261
Efficacy (lm/W)	48

Physical

Colour	Black
Orientation	Adjustable
Rotation (°)	360
Longitudinal tilting (°)	90
Net weight (kg)	0.1
IP internal	20

Download

Mounting instructions [↓ PDF](#)

Photometric Files

LDT / IES [↓ ZIP](#)

Technical Drawings

2D [↓ ZIP](#)

3D [↓ ZIP](#)



Schematic light drawing

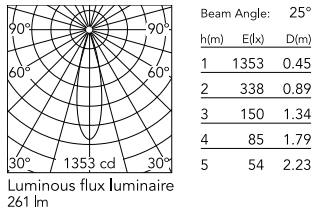

Photometric

Lighting type	Direct
Light distribution	Symmetric
CCT (K)	2700
CRI>	90
McAdam steps (SDCM)	2
Beam angle C0-180 (°)	25
Beam angle C90-270 (°)	25
UGR _L	<10

Electrical

Insulation class	III
Forward voltage (V)	24
LED current (mA)	400
Power supply	Remote excluded
Dimmable	Yes
Power supply type	Dimmable 1-10V
Dimming range (%)	1-100
Dimming interface	Remote Dimmable (Dimmer Not Included)

Ecodesign and Energy Labelling

This product contains a light source of energy efficiency class G



Non-replaceable light source



Replaceable control gear by a professional