

Almendra Organic Suspension Short 3

Designed by Patricia Urquiola, 2022

48W - 1353lm - 2700K - CRI> 95

Suspension lamp with diffused light emission available in linear and organic compositions. Tubular structure made of aluminium and CNC aluminium terminals with matte or metallized finish. Edge Lighting technology integrated. Light units can be turned by steps of 60° within the structure in order to change the direction of the light emitted. Metal rosette with matte white finish. The integrated electronics in the ceiling rose allow the use of different dimming systems: 1-10V, DALI, push-dim or potentiometer. Useful length of the cable 3 mt. The product has been designed according to the ISCC standards and it is assembled with total absence of glued components so that it can be completely separated for future recyclability.

Are you a professional and your project needs consulting and support?

BOOK AN APPOINTMENT

Main specifications

EAN	8059607048931
Mounting	Suspension
Environments	Indoor dry location
Light Source Type	LED
Light sources included	Yes
LED type	Edge Lighting
Power (W)	48
System flux (lm)	1353

Physical

Color	Anthracite
Length (in)	63.42
Cord color	Clear
Canopy color	White
Canopy width (in)	3.937
Canopy height (in)	1.732
Net weight (lb)	21.67
Gross weight (lb)	37.88
Package volume (in)	15138.65
IP internal	20

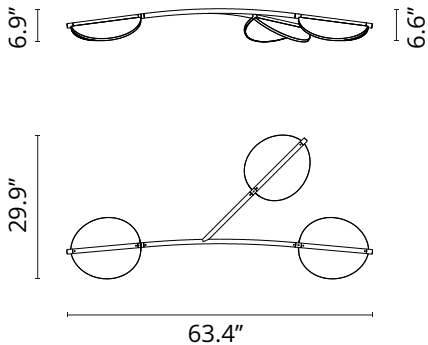
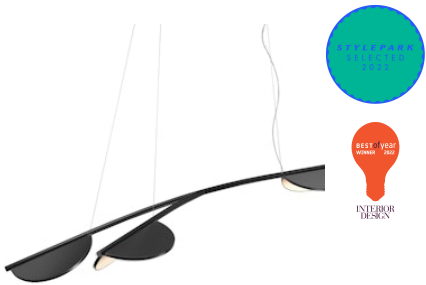

Download

Mounting instructions  PDF

Photometric Files

LDT / IES  LDT



Photometric



Lighting type	Direct
Light distribution	Symmetric
CCT (K)	2700
CRI>	95

Electrical



Insulation class	I
Frequency (Hz)	50/60
Main voltage (Vac)	120
Driver	Integrated
Dimmable	Yes
Dimming type	Dimmable
Dimming interface	Remote Dimmable (Dimmer Not Included)
Batteries inside	No

Ecodesign and Energy Labelling

This product contains a light source of energy efficiency class E



Replaceable (LED only) light source by a professional



Replaceable control gear by a professional

Spare Parts

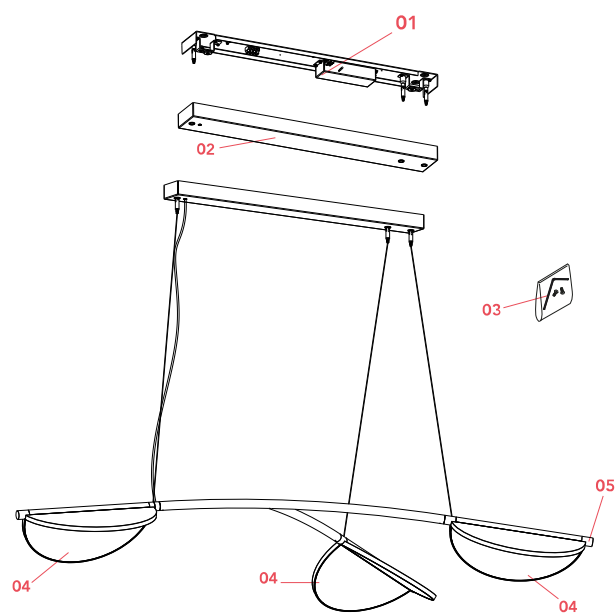

- 03. Kit with screws and allen key RF3160100
- 04. Almendra Suspension Anthracite body assembly RF32517
- 05. Almendra S Arc/Y terminal joint L31 Anth. RF33249



RF3160100

Kit with screws and allen key



RF32517

Almendra Suspension Anthracite
body assembly



RF33249

Almendra S Arc/Y terminal joint
L31 Anth.