

FLOS

FU009009 White

Aim

Designed by Ronan & Erwan Bouroullec, 2013

12W - 880lm - 2700K - CRI> 90

Created by the Bouroullec brothers in 2010, the AIM ceiling light is a design stripped to its most basic-and beautiful-essence. This innovative form of modern pendant lighting is constructed from a varnished aluminum sheet with a photo-etched optical PC (polycarbonate) shade. The internal reflector is photo-etched ABS. The cable can be adjusted to allow the fixture head and light distribution to be aimed in whatever way you choose. The cable has a total length of 354" long = 29.50 feet = 9 MT. Available in classic white, black and bronze in addition to new lively colors introduced in 2021 Anodized Blue Steel, Anodized Green, and Anodized Light Silver. The AIM pendant provides direct lighting and is available in two versions: hardwired or plug-in.

1. AIM - Hardwired: Connects to wall-switch by hardwiring to a 120V junction box (no additional LED driver is required). Comes with a 5" diameter canopy.

2. AIM - Plug-in: Switch and cord that you can plug into a socket, non-dimmable. Inspiration behind the design: When they created the AIM ceiling light, brothers Ronan and Erwan Bouroullec wanted to keep its core essence limited to the source of light and its cord. By doing that, they ensured that the AIM is versatile enough for any setting not only because of its appearance, but also because it provides a convenient, easily "aimed" light.

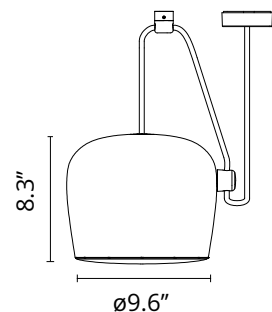

Download

Mounting instructions



Dimmers or chargers compatible



Ecodesign and Energy Labelling

This product contains a light source of energy efficiency class F

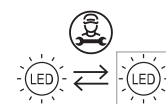

Replaceable (LED only) light source by a professional

Main specifications

| | |
|------------------------|---------------------|
| EAN | 8059607027592 |
| Mounting | Suspension |
| Environments | Indoor dry location |
| Light Source Type | LED |
| Light sources included | Yes |
| LED type | Multichip LED |
| Power (W) | 12 |
| System power (W) | 12 |
| System flux (lm) | 880 |

Physical

| | |
|---------------------|---------|
| Color | White |
| Length (in) | 9.57 |
| Cord color | White |
| Canopy color | White |
| Canopy height (in) | 0.748 |
| Net weight (lb) | 7.05 |
| Gross weight (lb) | 9.04 |
| Package height (in) | 11.81 |
| Package width (in) | 14.76 |
| Package length (in) | 11.81 |
| Package volume (in) | 2059.56 |
| IP internal | 20 |



Photometric

| | |
|--------------------|----------------|
| Light distribution | Roto symmetric |
| CCT (K) | 2700 |
| CRI> | 90 |
| Extreme cut off | No |

Electrical

| | |
|--------------------|--|
| Insulation class | II |
| Frequency (Hz) | 60 |
| Main voltage (Vac) | 120 |
| Driver | Integrated |
| Dimmable | Yes |
| Dimming type | Mains Cut Dimming |
| Dimming interface | Remote Dimmable (Dimmer Not Included) |
| Batteries inside | No |

Accessories & Power Supply



OPTIONAL

FU009309

AIM Multi Canopy in White

Spare Parts

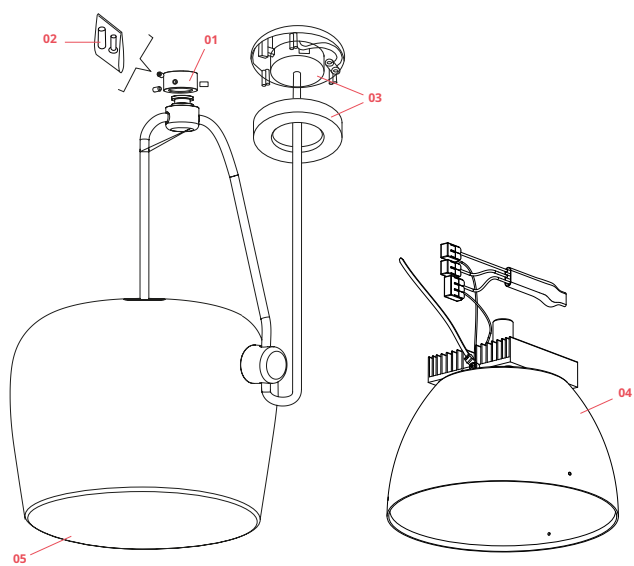

- | | | |
|-----|---|-----------|
| 01. | Aim/Aim Small Ceiling attachment assembly | RF0090109 |
| 02. | Aim/Aim Small Kit of quantity 3 m4 screws | RF06749 |
| 03. | AIM Ceiling Rose Assembly In White | RFU009909 |
| 04. | Aim Assembly Led Board 2700K | RFU009100 |



RF0090109

Aim/Aim Small Ceiling attachment
assembly



RF06749

Aim/Aim Small Kit of quantity 3
m4 screws



RFU009909

AIM Ceiling Rose Assembly In
White

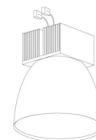

RFU009100

Aim Assembly Led Board 2700K