

TC METAL STUD INSTALLATION

PREINSTALLATION. TC METAL STUD

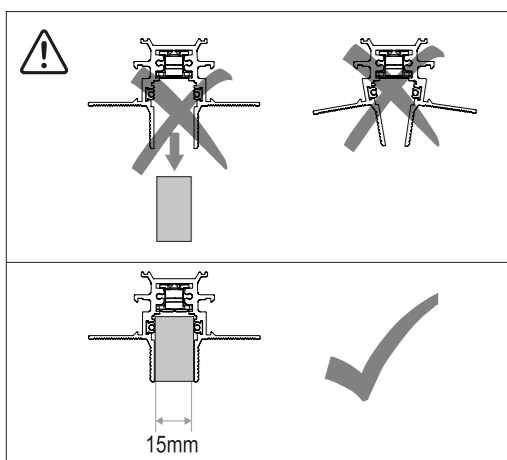
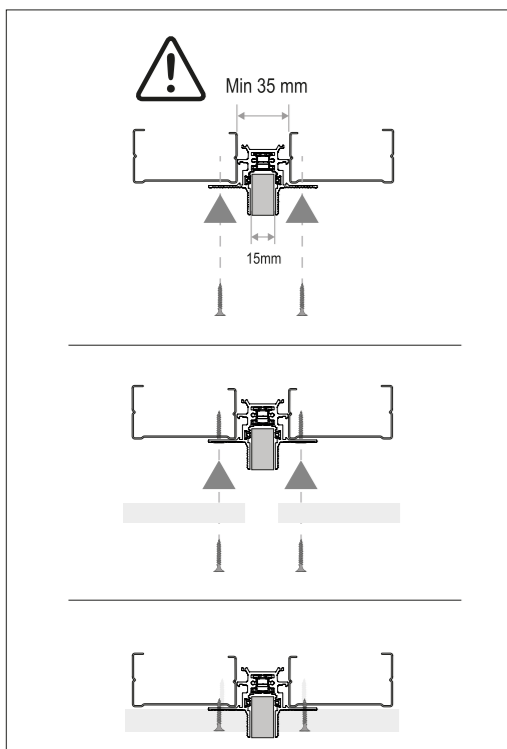
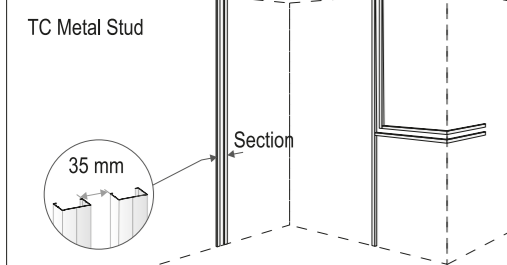

B ELECTRICAL CONNECTION

CONEXIÓN ELÉCTRICA / CONNESSIONE ELETTRICA / ELEKTRISCHER ANSCHLUSS / CONNEXION ÉLECTRIQUE / LIGAÇÃO ELÉCTRICA / のコネクション / 電力接続 / ЭЛЕКТРИЧЕСКОЕ ПОДКЛЮЧЕНИЕ / ЭЛЕКТРИК БАЙЛАНЫС / التوصيل الكهربائي

EUR VERSION

MAX
Constant voltage 48V 320W / 6,7A
Protections:
Short circuit / Overload / Over voltage

US VERSION

USE ONLY WITH CLASS 2 POWER SUPPLY
SUITABLE FOR RECESSED USE, MAX 100W

⚠ Maximum number of profile interconnections to ensure the communication of DALI or 1-10V signal: 20 interconnections including cutted profiles.

⚠ Maximum number of cutted profiles to ensure the communication of DALI or 1-10V signal: 3 cuts.

B.1 FEED PROFILE

⚠ **WARNING:**
INSTALL THE DRIVER BEFORE THE PLASTERBOARD

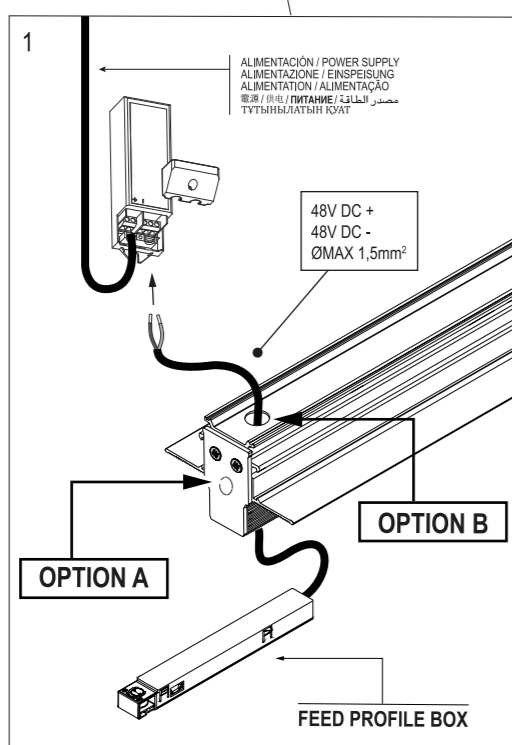
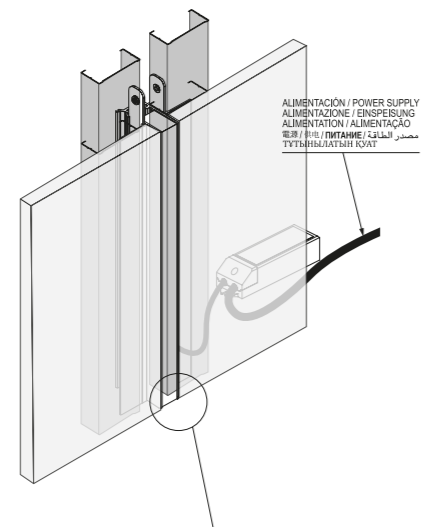

LED DRIVER

≤ 60 Vout

⚠ **ATTENTION**

The voltage under load does not exceed 25 V r.m.s. or 60 V ripple-free d.c. and the no-load voltage does not exceed 35 V peak or 60V ripple-free d.c.

OPTION A

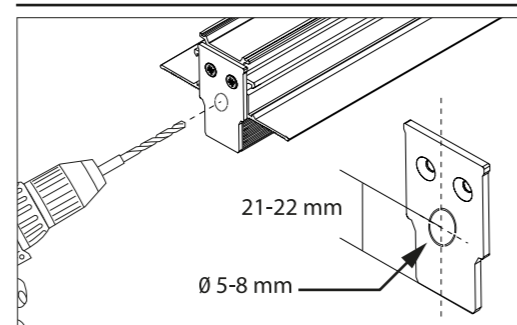

OPTION B

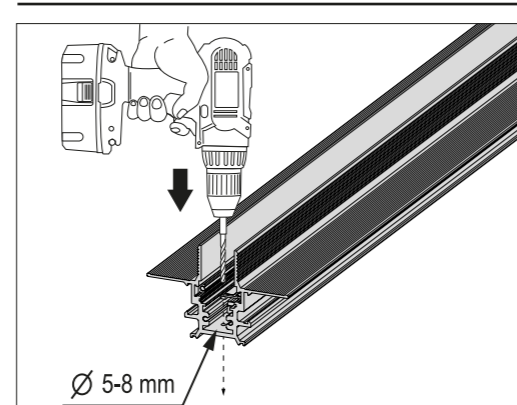

Access to the profile through the top part perforating it as show in the image.

CONNECTING 48 Vdc CABLE TO FEED PROFILE BOX

ACCESS TO THE BOX

⚠ **WARNING:** Connect the cable after the plasterboard process

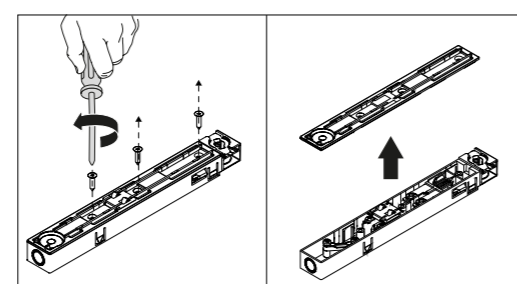
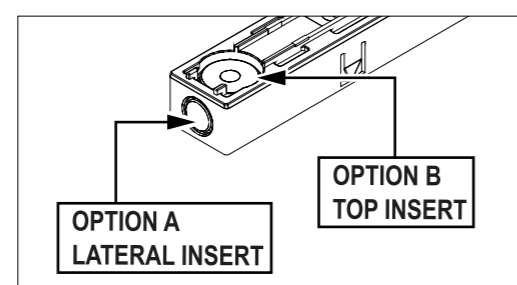

ELECTRICAL AND DIMMING CONTROL CONNECTION

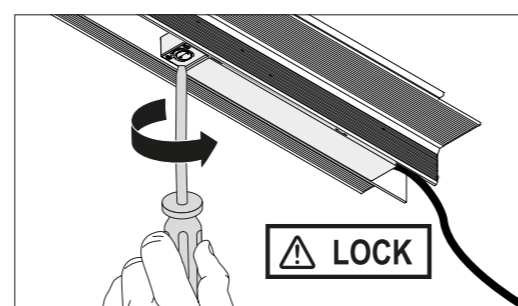
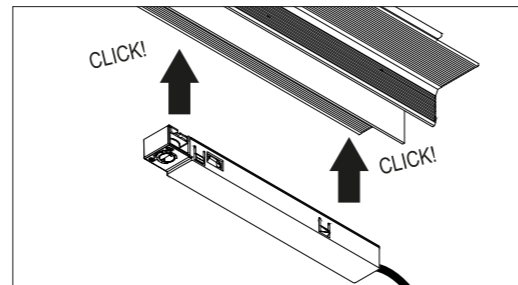
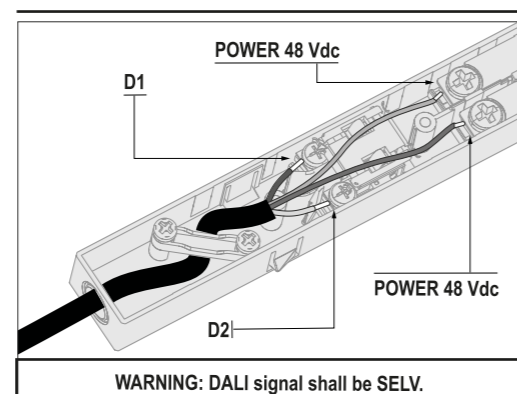

CUT PROFILE

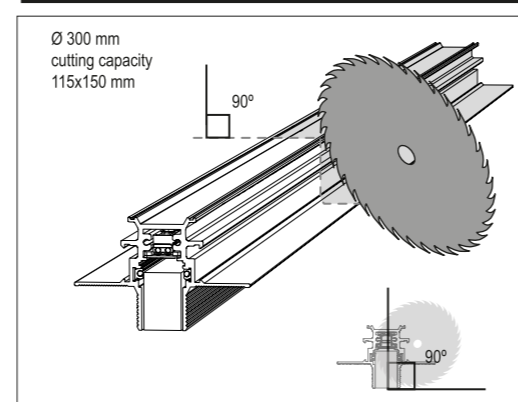

⚠ **WARNING:** After cutting the profile push both cooper cables to the inner part to avoid the contact with the adjacent profile

RECOMEND FEED PROFILE CONNECTION

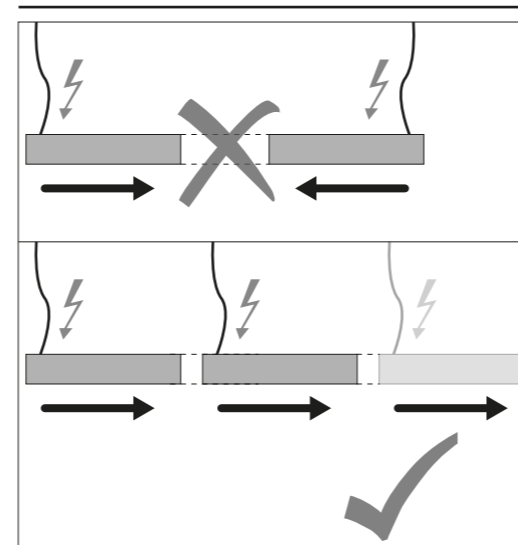

B.2 INTERCONNECTION

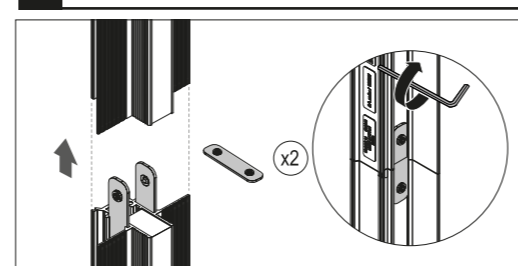

PLASTERBOARD

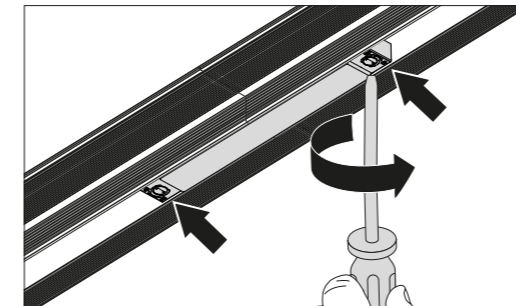
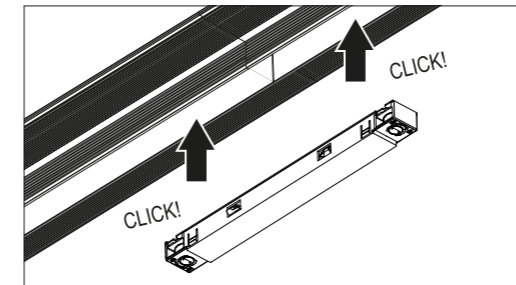
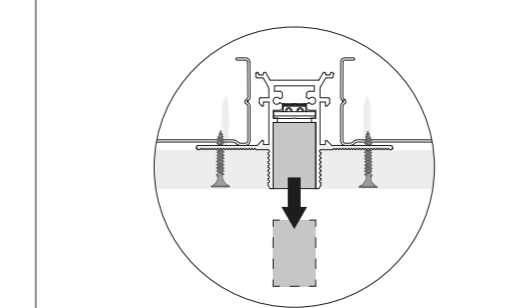
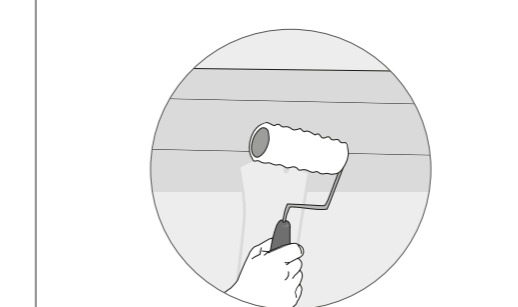
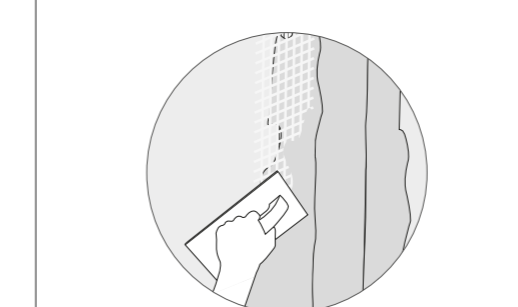
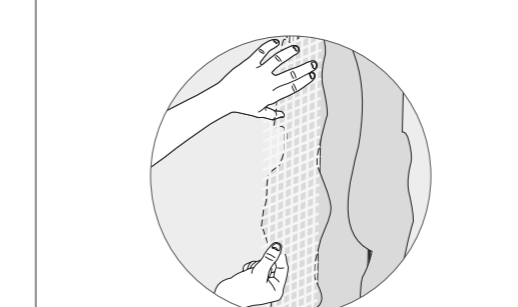
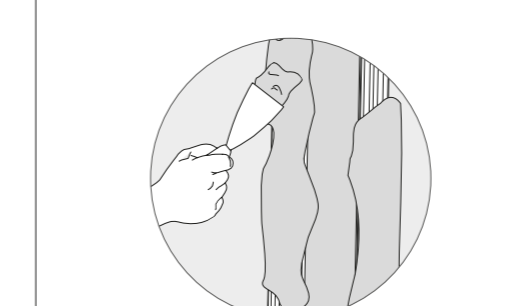
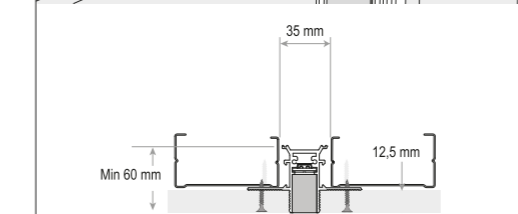
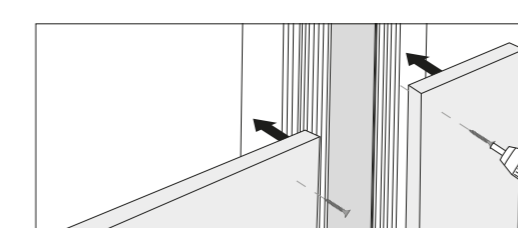

B.3 CORNER

