

WARNING!
Calculate the total power of system output by applying a safety coefficient of +15% without exceeding the driver's full potential.
Calcule la potencia total de salida del sistema aplicando un coeficiente de seguridad de +15% sin exceder el potencial total del controlador.

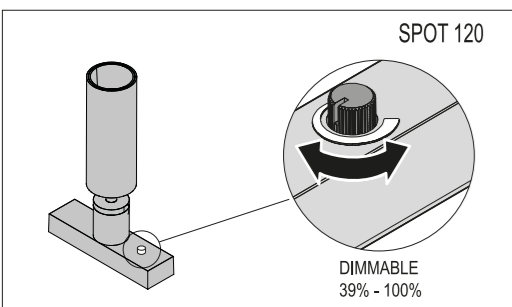

NO DALI VERSION

Each feed unit profile / Por unidad de alimentación de perfil	LUMINAIRE / LUMINARIAS
Max. 21	Spot RM Minigloball RM Findme Suspension RM
Max. 14	Spot 120 RM Multispot 4 RM Light Shadow RM 4L
Max. 6	Anthony Spot String Light

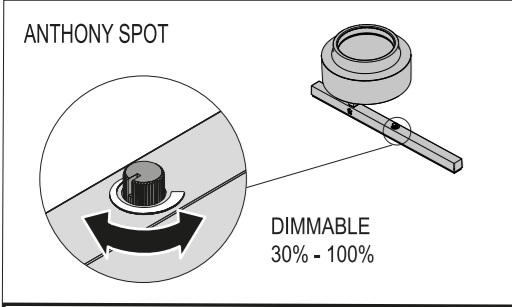

WARNING / ATENCIÓN:
Weak lens in Flood and Wide Flood versions / Lente débil en las versiones Flood y Wide Flood

DALI VERSION

Each feed unit profile / Por unidad de alimentación de perfil	LUMINAIRE / LUMINARIAS
Max. 14	Spot RM Minigloball RM Findme Suspension RM Multispot 4 RM
Max. 11	Spot 120 RM Light Shadow RM 4L

- **MAX. 64 products for the DALI controller / MAX. 64 productos para el controlador DALI.**
- **The DALI control will be 10% to 100% / El control DALI será del 10% al 100%**
- **Warning! The DALI accessory may have any address / ¡Advertencia! El accesorio DALI puede tener cualquier dirección.**
- **Warning! Confirm DALI connection, product may not present correct performance without this validation / ¡Advertencia! Confirme la conexión DALI, es posible que el producto no presente un rendimiento correcto sin esta validación.**
- **Electrical Installation requires knowledge and should be carried out by accredited specialist / La instalación eléctrica requiere conocimientos y debe ser realizada por especialistas acreditados.**

CASAMBI VERSION

Each feed unit profile / Por unidad de alimentación de perfil	LUMINAIRE / LUMINARIAS
Max. 14	Spot RM Minigloball RM Findme Suspension RM Multispot 4 RM
Max. 11	Spot 120 RM Light Shadow RM 4L

- **MAX. 200: Luminaires for a single CASAMBI network / Luminarias para una sola red CASAMBI.**
- **The CASAMBI control will be 1% to 100% / El control CASAMBI será del 1% to 100%**
- **MAX. 15: Meters between luminaires if the environment is an open space (no wall in between luminaires) / Metros entre luminarias si el entorno es un espacio abierto (sin pared entre luminarias)**
- **To know more about all CASAMBI options visit / Para saber más sobre todas las opciones de CASAMBI visite : www.casambi.com**

WARNING for / Atención para : Light Shadow Running Magnet

E La luminaria debería colocarse de forma que no se espera una mirada prolongada a la luminaria a una distancia más cercana a X m
GB The luminaire should be positioned so that prolonged staring into the luminaire at a distance of X m. is not expected.
I L'apparecchio dovrà essere collocato in modo che non ci si aspetti uno sguardo prolungato verso l'apparecchio da una distanza di circa x m.
D Die Lampe ist so zu positionieren, dass ein direkter Blick vermieden wird. Dies geschieht durch eine Längspositionierung auf x Metern Distanz.
F Le luminaire doit être positionné de manière à ne pas attendre un regard prolongé vers le luminaire à une distance proche de x mètres.
P A luminária deverá ser posicionada de tal forma que uma pessoa a x metros de distância não mantenha o olhar prolongado à mesma..

JP 本照明器具は、X mより近い距離から内部を長時間凝視することのない場所に設置してください。
CN 请勿将灯具放置于接近于离视线 X 公尺的距离。
RU Светильник должен располагаться таким образом, чтобы длительное зрительное наблюдение на светильник находилось на расстоянии x м
AR متر X لتجنب النظر إلى الإضاءة لمدة طويلة، يجب وضع الإضاءة على مسافة أقرب من
KZ Ұзақ қарау күтілмейтін а x м-ға ең жақын дейінгі қашықтықтағы жарық түсірілш құрылғы орнатыстырған жөн

OPTICS / OPTICAS	T°	X
Spot	3000 K	X = 175 cm
Medium	3000 K	X = 175 cm
Spot	2700 K	X = 50 cm

WARNING ATENCIÓN
Only use with the electrical supply track system:
Usar solo con los siguientes sistemas de carriles eléctricos:
"The Running Magnet System"

B LUMINAIRE INSTALLATION
INSTALACIÓN DE LA LUMINARIA / INSTALLAZIONE DELLA LAMPADA / INSTALLATION DER BELEUCHTUNG / INSTALLATION DU LUMINAIRE / INSTALAÇÃO DO APARELHO DE ILUMINAÇÃO / 照明器具の設置・据付け / 灯具的安装 / МОНТАЖ ОСВЕТИТЕЛЬНОГО ПРИБОРА / ШАМДАЛДЫ ОРНАТУ / تركيب وحدة الإضاءة

UL LISTED : The Running Magnet to be assembled with FLOS electrical track and FLOS mechanical housing / El Running Magnet para ser ensamblado con carril eléctrico FLOS y carcasa mecánica FLOS

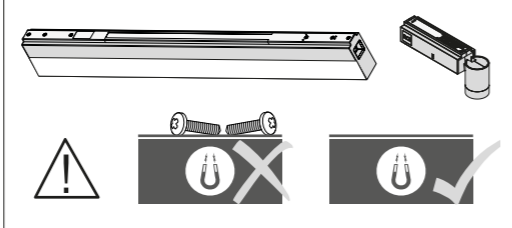

B.1 LIGHT SHADOW & LIGHT SHADOW WW RM 4L

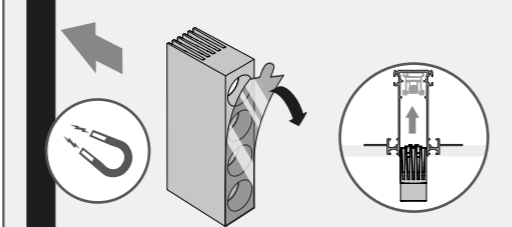

REMOVE PLASTIC FILM / QUITAR EL PLASTICO

LIGHT SHADOW WW RM 4L

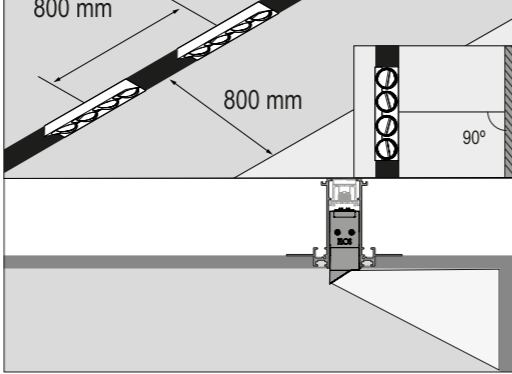

B.2 LIGHT STRIPES AND LED SPOT

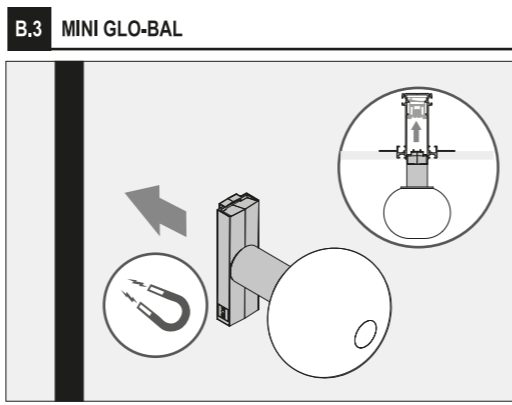
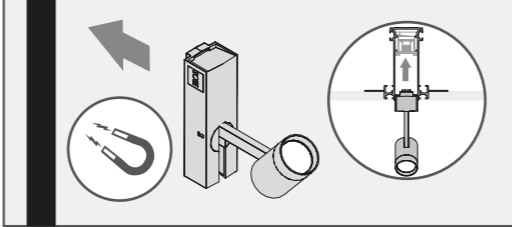
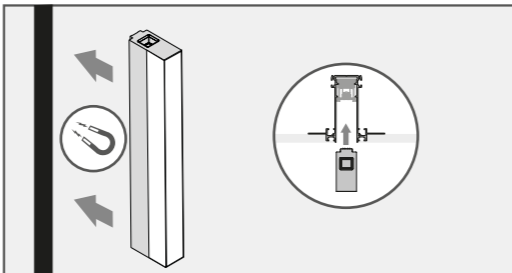

B.5 ANTHONY SPOT TRACK

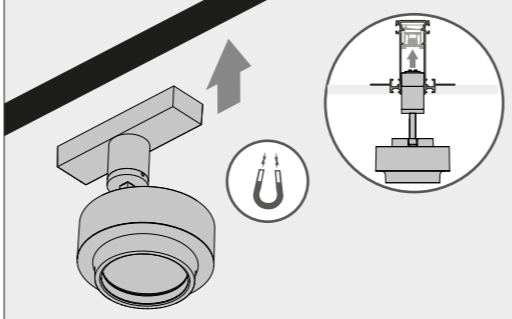

WARNING: Only allowed ceiling installation / Solo se permite la instalación en techo

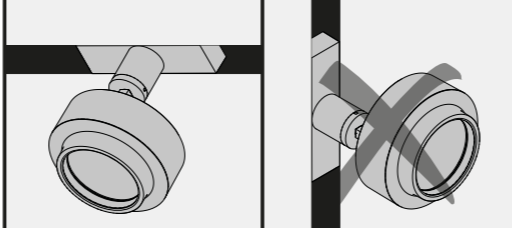

B.4 MINI GLO-BAL, FIND ME SUSPENSION

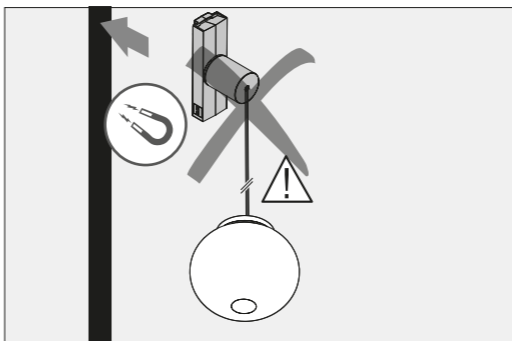
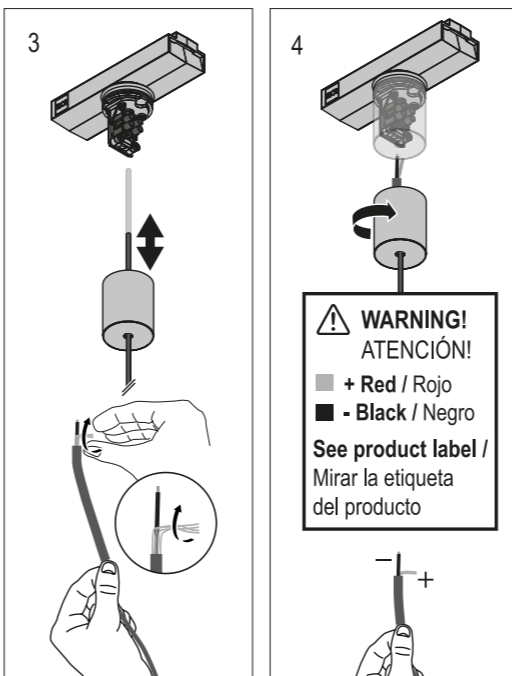
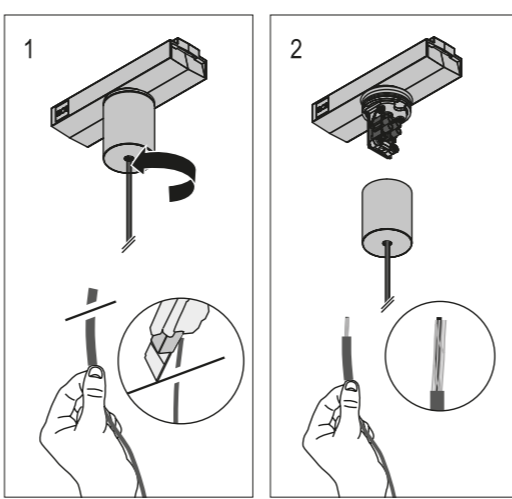
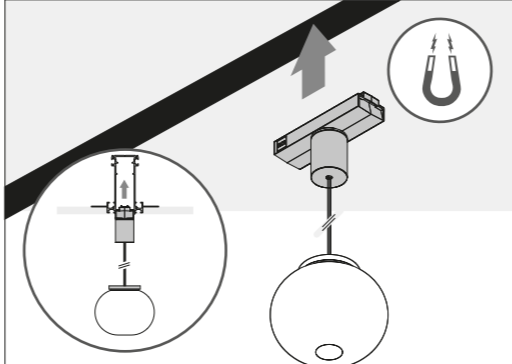

WARNING FOR ALL MODULES / ADVERTENCIA PARA TODOS LOS MÓDULOS:
Do not drag. Remove and put in the new position / No arrastre. Retirar y colocar en la nueva posición.

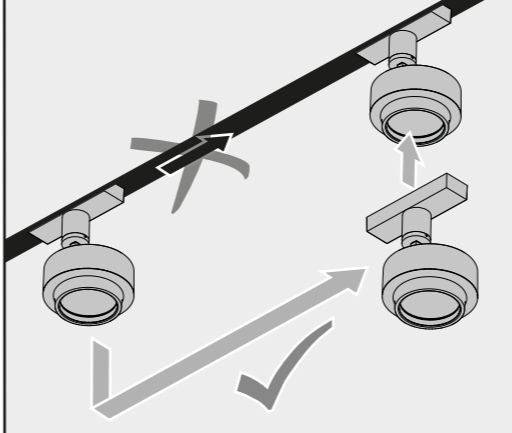

C ACCESSORIES
ACCESORIOS / ACCESSORI / ZUBEHÖR / ACCESSOIRES / ACCESSÓRIOS / アクセサリー / 配件 / АКЦЕССУАРИ / KEPEK-ЖАРАТAP / 配件

C.1 ENDCAP EXCHANGE

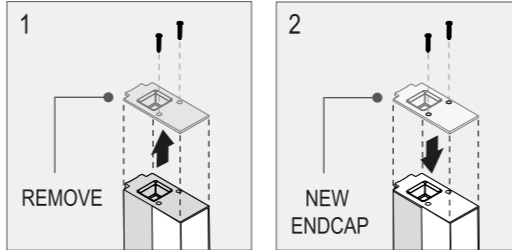

C.2 LENS EXCHANGE

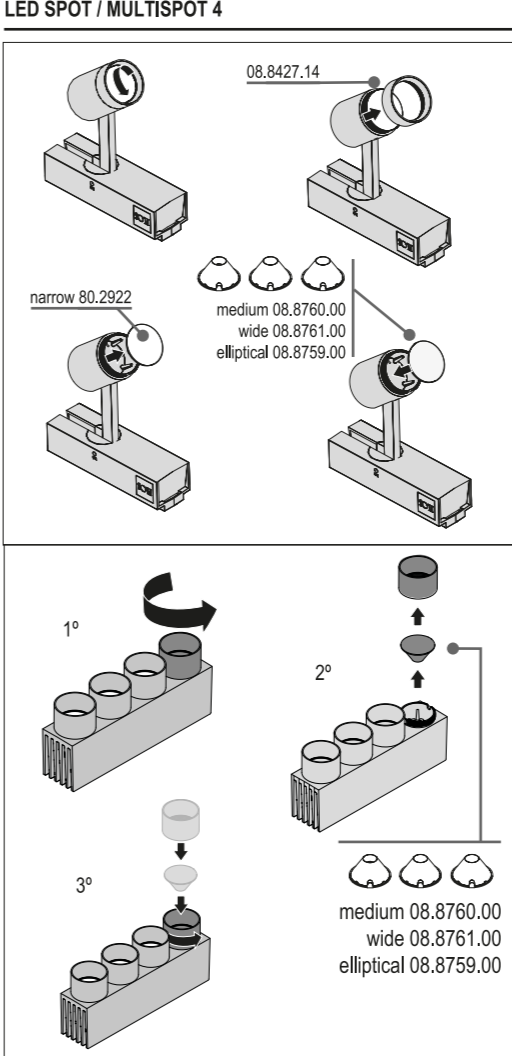

ANTHONY SPOT

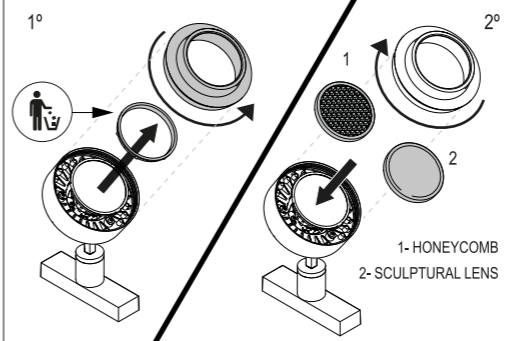

D TILT AND LOCKING ADJUSTMENT

REGULACIÓN DE LA INCLINACIÓN Y BLOQUEOS / REGOLAZIONE DELL'INCLINAZIONE E BLOCCHI / NEIGUNGSREGLER UND SPERREN / RÉGLAGE DE L'INCLINAISON ET VERROUILLAGES / REGULAÇÃO DA INCLINAÇÃO E BLOQUEIOS / 角度調節と固定 / 调节倾斜度和锁定装置 / РЕГУЛИРОВКА НАКЛОНА С ФИКСАЦИЕЙ / ЕЖКЕЙТУДІ ЖОНЕ ПСАВЛАДЫ РЕТТЕУ / ضبط الإضاءة والكبح

D.1 LED SPOT

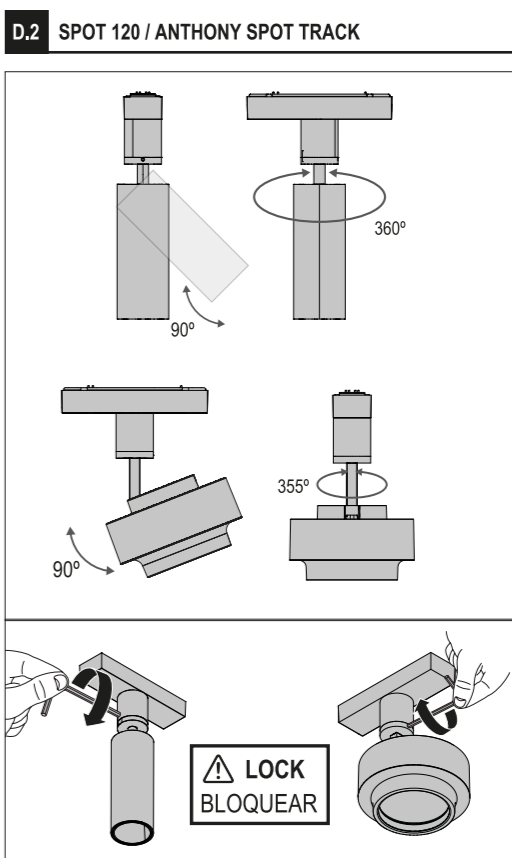
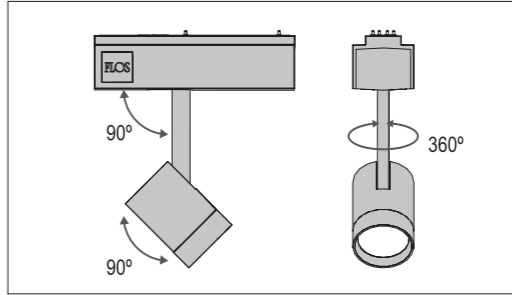

DIMENSION CONVERSION TABLE

mm	inch
2	0,08
22	0,87
33	1,30
34	1,34
40	1,57
46	1,81
50	1,97
72	2,83
85	3,35
92	3,62
110	4,33
111	4,37
120	4,72
130	5,12
140	5,51
160	6,30
165	6,50
170	6,69
220	8,66
300	11,81
500	19,69
600	23,62
800	31,50
900	35,43
1200	47,24
1500	59,06
1750	68,90
3000	118,11