

**RF26675**

Wirering Ring assembly

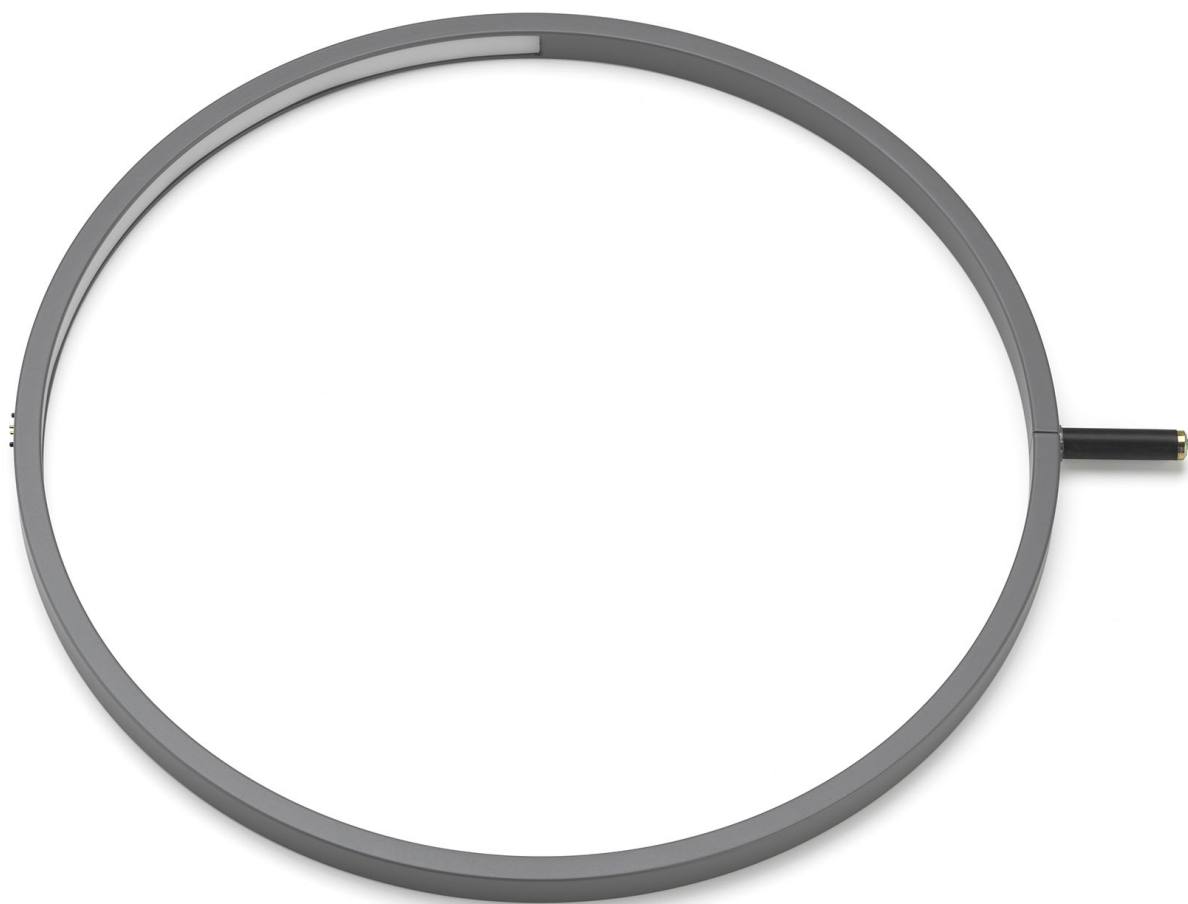

WARNING! When installing and whenever acting on the appliance, ensure that the power supply has been switched off.  
For the installation of the spare-part, it is necessary to consult a qualified electrician.

## RF26675

Wiring Ring assembly

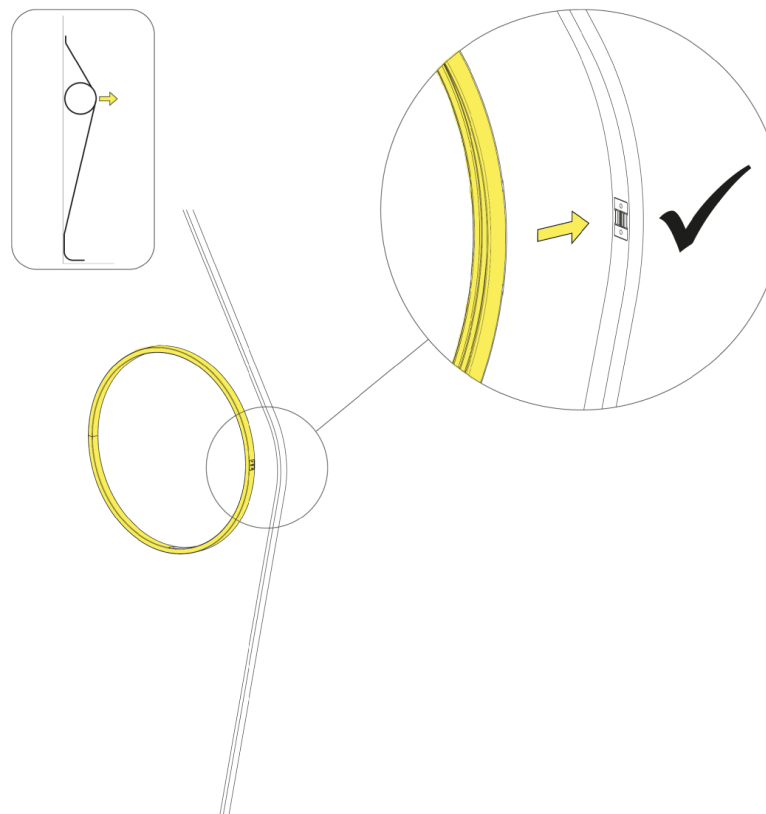

Fig.1

Disconnect the body lamp from the old ring.

WARNING! When installing and whenever acting on the appliance, ensure that the power supply has been switched off.  
For the installation of the spare-part, it is necessary to consult a qualified electrician.

**RF26675**

Wiring Ring assembly

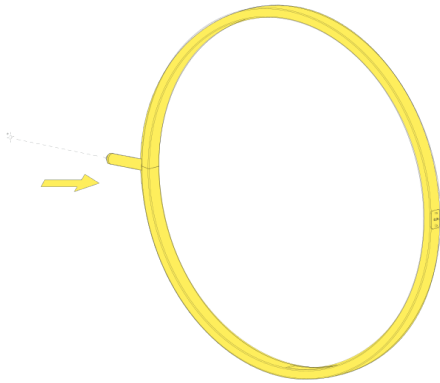

Fig.2

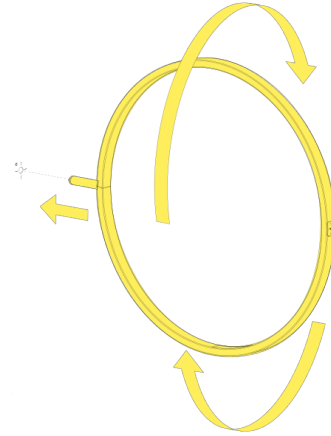

Fig.3

Remove the old ring from the wall.  
Insert the new ring in the hole into the wall.

WARNING! When installing and whenever acting on the appliance, ensure that the power supply has been switched off.  
For the installation of the spare-part, it is necessary to consult a qualified electrician.

**RF26675**

Wiring Ring assembly

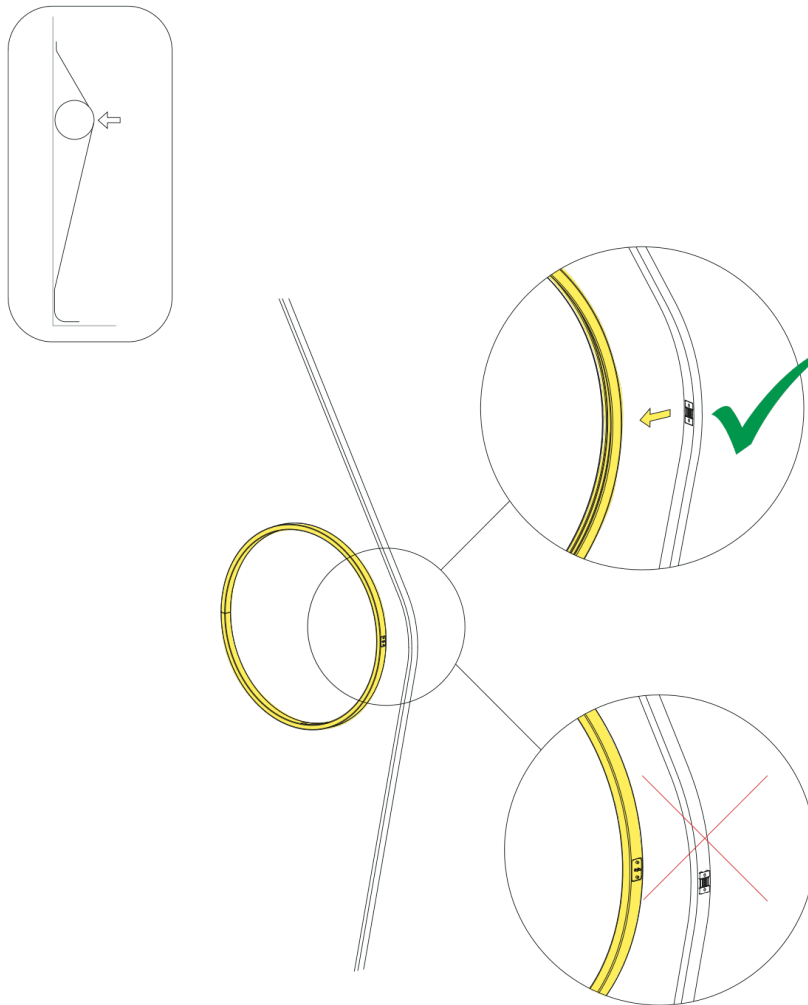

Fig.4

Connect the body lamp to the new ring respecting the correct installation direction.

WARNING! When installing and whenever acting on the appliance, ensure that the power supply has been switched off.  
For the installation of the spare-part, it is necessary to consult a qualified electrician.