

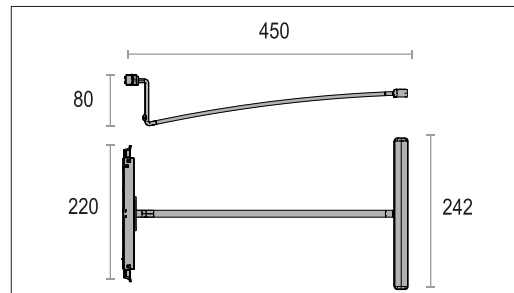

## TECHNICAL DATA

DATOS TÉCNICOS / DATI TECNICI / TECHNISCHE DATEN / DONNEES TECHNIQUES / DADOS TÉCNICOS / テクニカルデータ / 技术数据 / ТЕХНИЧЕСКИЕ ДАННЫЕ / ТЕХНИКАЛЫҒЫ МӘЛҮМЕТТЕР / بيانات تقنية

### ACCENT LIGHTING



WALLEE			
Ref	System Power (W)	CCT(K) / CRI	W (kg)
03.8091.XX	9,5	3000K CRI90	0,22
03.8090.XX	9,5	2700K CRI90	0,22

\*DIMMABLE

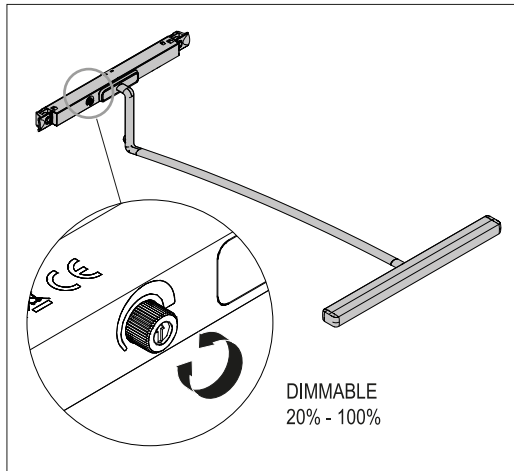

## A LUMINAIRE INSTALLATION

INSTALACIÓN DE LA LUMINARIA / INSTALLAZIONE DELLA LAMPADA / INSTALLATION DER BELEUCHTUNG / INSTALLATION DU LUMINAIRE / INSTALAÇÃO DO APARELHO DE ILUMINAÇÃO / 照明器具の設置・据付け / 灯具的安装 / МОНТАЖ ОСВЕТИТЕЛЬНОГО ПРИБОРА / ШАМДАЛДЫ ОРНАТУ / تركيب وحدة الإنارة

**WARNING/ADVERTENCIA** Only use with the electrical supply track system: Usar solo con el sistema de seguimiento de suministro eléctrico:

“The Tracking Magnet EVO Recessed”

## WARNING / ADVERTENCIA

Calculate the total power of system output by applying a safety coefficient of +15% without exceeding the driver's full potential. Calcule la potencia total de salida del sistema aplicando un coeficiente de seguridad de + 15% sin exceder el potencial total del conductor.

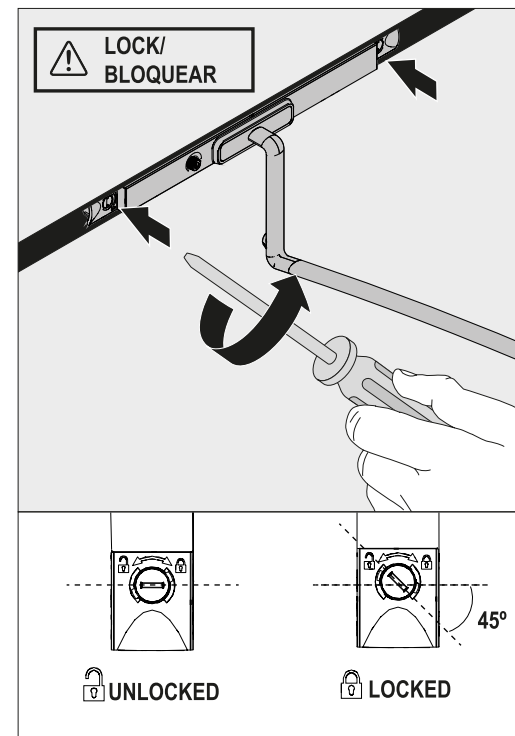
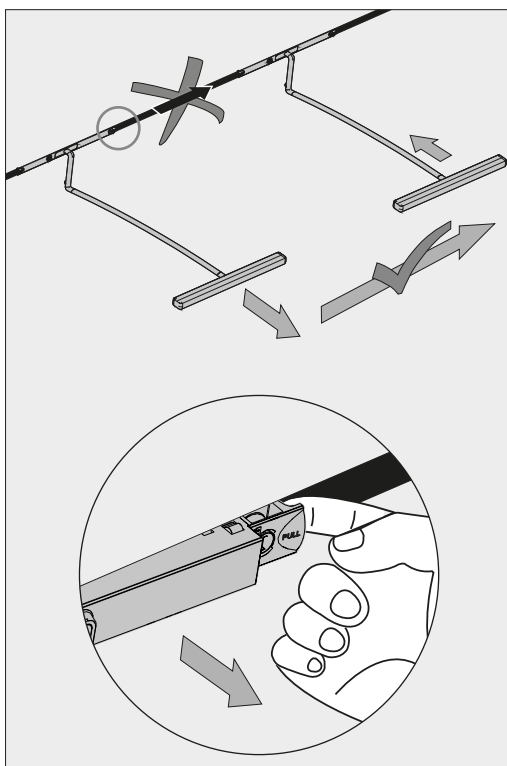
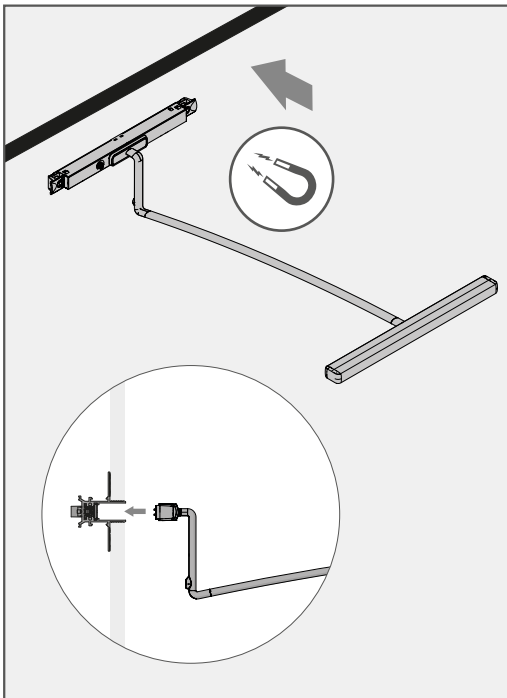
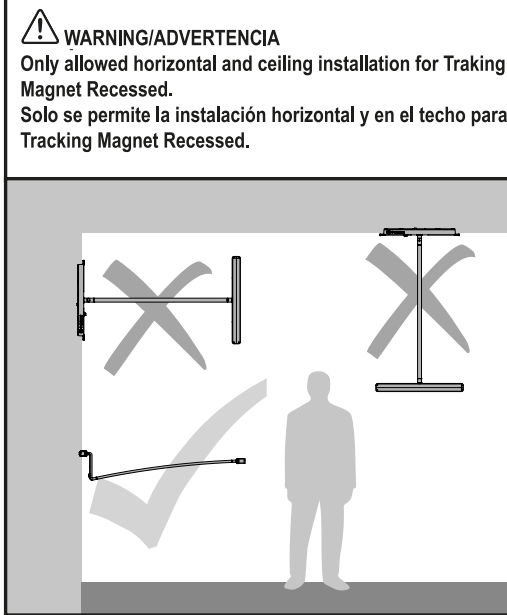
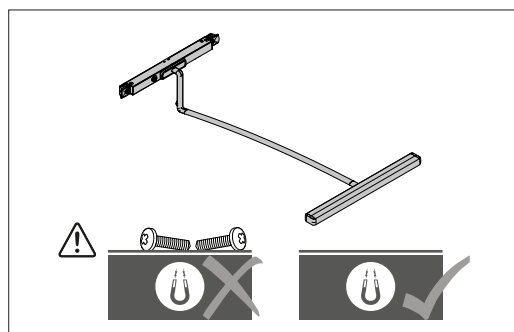

**WARNING:** Keep the adapter completely aligned inside the profile until both sides of the adapter are locked or released.  
**ADVERTENCIA:** Mantenga el adaptador completamente alineado dentro del perfil hasta que ambos lados del adaptador estén bloqueados o liberados.

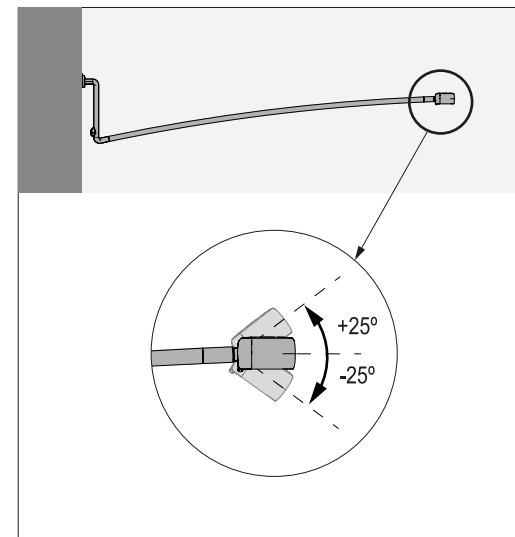

## B ACCESSORIES

ACCESORIOS / ACCESSORI / ZUBEHÖR / ACCESSOIRES / ACCESSÓRIOS / アクセサリー / 配件 / АКЦЕСУАРЫ / KEPEK-ЖАРАТAP / البسجوارات

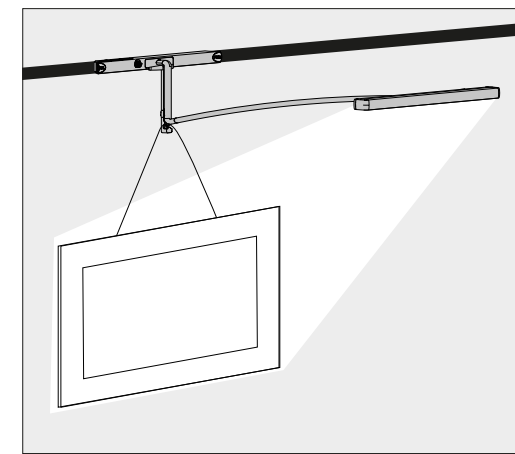
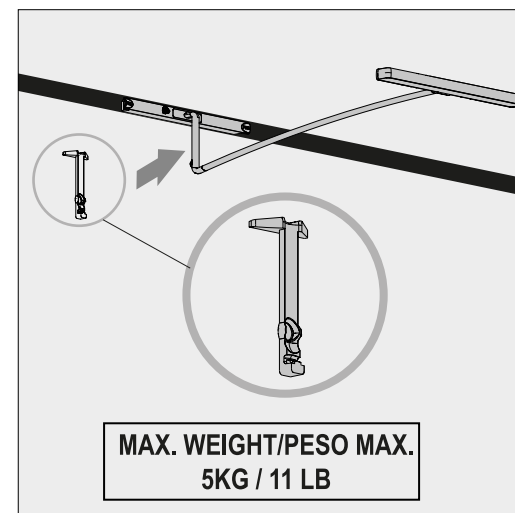

**WARNING:** The product admits manual adjust to achieve required alignment.  
**ADVERTENCIA:** El producto admite el ajuste manual para lograr la alineación requerida.

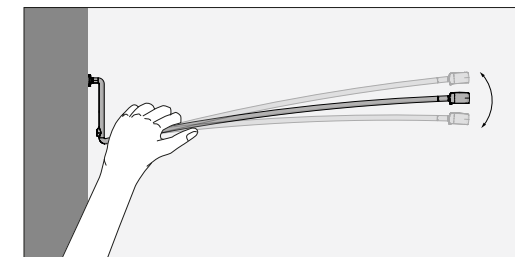
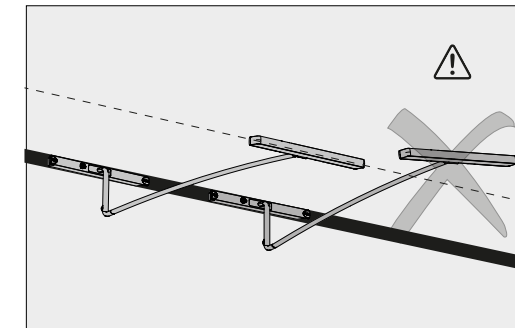

**LED DRIVER** ≤ 60 Vout

## ATTENTION /ATENCIÓN

The voltage under load does not exceed 25 V r.m.s. or 60 V ripple-free d.c. and the no-load voltage does not exceed 35 V peak or 60 V ripple-free d.c.  
El voltaje bajo carga no excede los 25 V r.m.s. o 60 V sin ondulaciones d.c. y el voltaje sin carga no supera los 35 V pico o 60 V sin ondulaciones d.c.