

**RF6257005**

Wiring assembly and external diffuser with support



WARNING! When installing and whenever acting on the appliance, ensure that the power supply has been switched off.  
For the installation of the spare-part, it is necessary to consult a qualified electrician.

## RF6257005

Wiring assembly and external diffuser with support

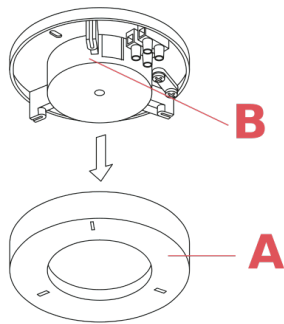

Fig.1

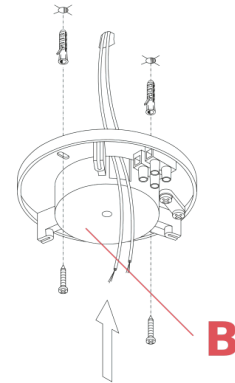

Fig.2

Unhook the rosette (A) from the socket on the roof (B).

Attach the wall socket to the roof with screws and expansion plugs taking care to pass the feeding wires to the opposite lateral crack.

NOTE: choose the correct expansion plugs for the surface that it has to be mounted on.

WARNING! When installing and whenever acting on the appliance, ensure that the power supply has been switched off.  
For the installation of the spare-part, it is necessary to consult a qualified electrician.

**RF6257005**

Wiring assembly and external diffuser with support

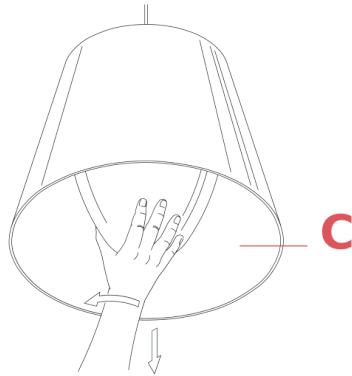

Fig.3

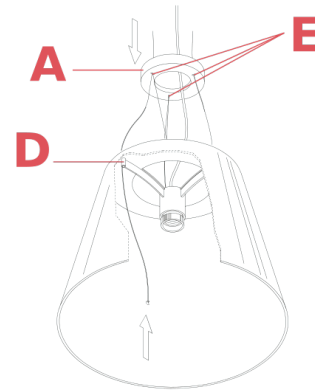

Fig.4

Remove the internal lampshade (C) unhooking it from the outer lampshade by turning it slightly counterclockwise.

Attach the three small steel cables through the appropriate holes (D) of the same diffusers and through the holes (E) of the rosette (A).

**WARNING!** When installing and whenever acting on the appliance, ensure that the power supply has been switched off.  
For the installation of the spare-part, it is necessary to consult a qualified electrician.

## RF6257005

Wiring assembly and external diffuser with support

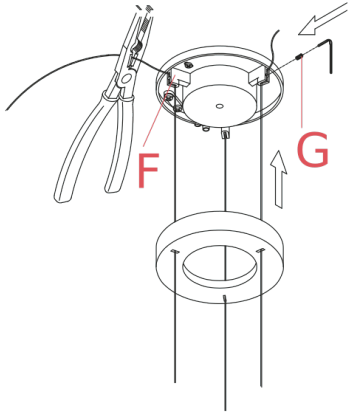

Fig.5

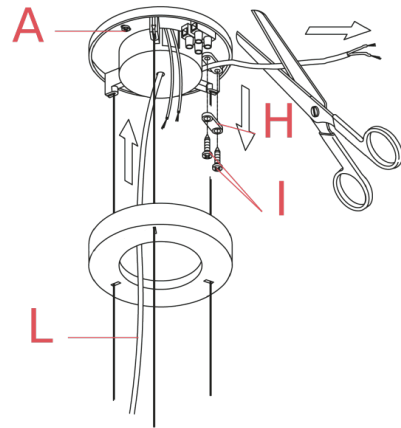

Fig.6

Bend the ends of the three steel cables by about 90° and then insert them into the corresponding guides (F) of the plugs on the roof; regulate the apparatus to the desired height thereafter block the cables by tightening the screws (G) with the keys supplied with the equipment; cut any excess length of the Cables.

Dismantle the cable block (H) tightening the two screws (I); Pass the feeding cable (L) coming from the apparatus through the central hole of the rosette and attach it to the roof, thereafter cut the excess length of the cable.

**WARNING!** When installing and whenever acting on the appliance, ensure that the power supply has been switched off.  
For the installation of the spare-part, it is necessary to consult a qualified electrician.

**RF6257005**

Wiring assembly and external diffuser with support

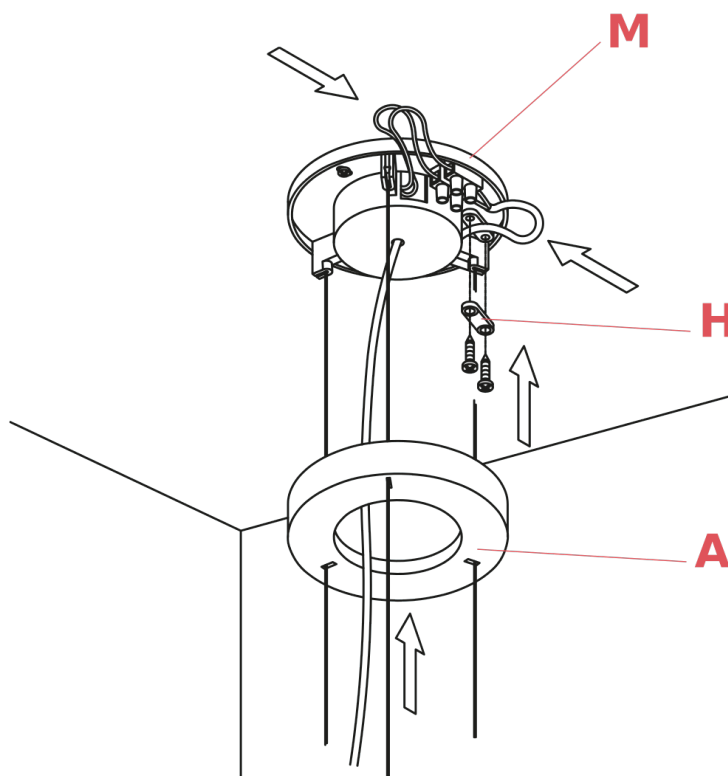

Fig.7

Connect the electric wires to the terminal board (M), block the feeding cable with the blocking cable (H); re-hooking the rosette (A).

WARNING! When installing and whenever acting on the appliance, ensure that the power supply has been switched off.  
For the installation of the spare-part, it is necessary to consult a qualified electrician.

**RF6257005**

Wiring assembly and external diffuser with support

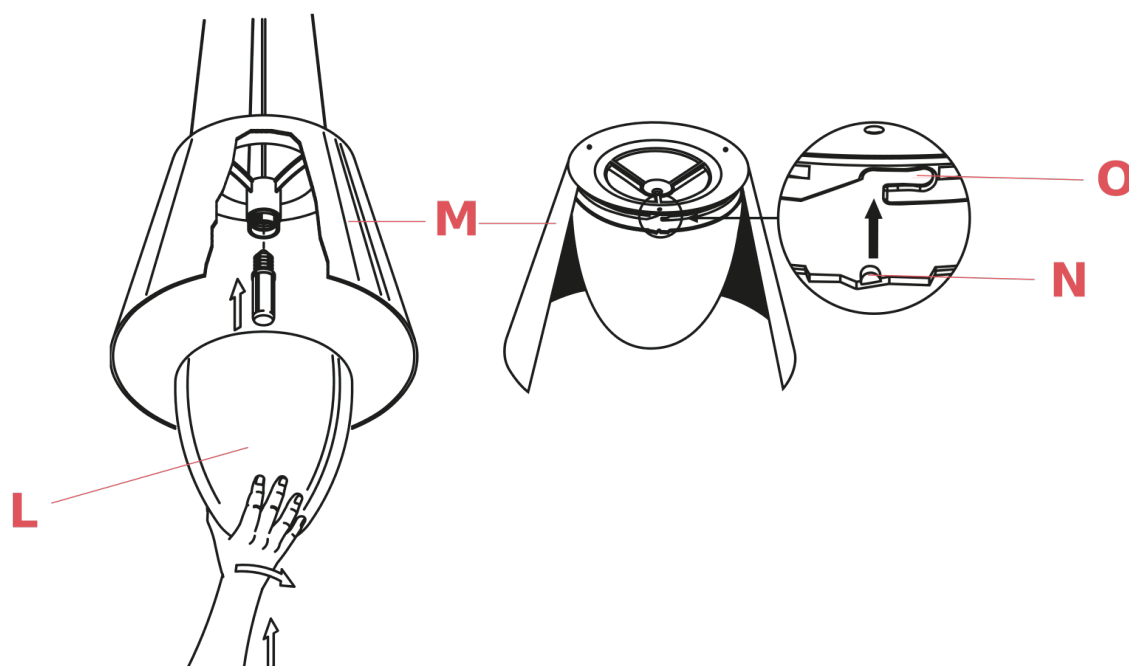

Fig.8

Insert the light bulb then replace the inner lampshade (L) blocking it with a “bayonet” movement: to carry out this operation the pins (N) hooking the inner lampshade must be inserted into the specific openings (O) of the outer lampshade (M).

WARNING! When installing and whenever acting on the appliance, ensure that the power supply has been switched off.  
For the installation of the spare-part, it is necessary to consult a qualified electrician.