

ARCO F0300000

EN

RF04724

ELECTRICAL WIRING ASSEMBLY WITH ON-OFF SWITCH



WARNING! When installing and whenever acting on the appliance, ensure that the power supply has been switched off.
For the installation of the spare-part, it is necessary to consult a qualified electrician.

ARCO F0300000

EN

RF04724

ELECTRICAL WIRING ASSEMBLY WITH ON-OFF SWITCH

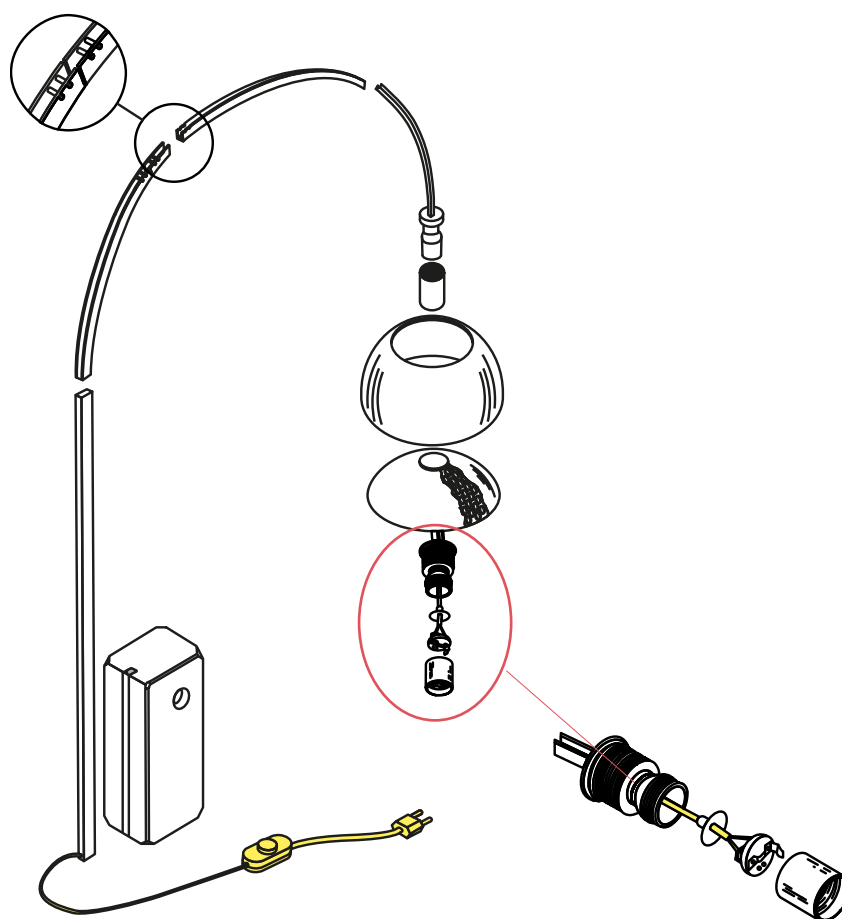

Fig.1

Remove the grid-reflector assembly.
Insert the electrical cable by sliding it through the stem and channels.
CAREFUL!!! Do not tear/mark the isolation of electrical cable.
Connect the electrical wires to the lamp-fitting terminals.
Re-assemble the grid-reflector assembly by locking the assembly through the anodized sleeve.

WARNING! When installing and whenever acting on the appliance, ensure that the power supply has been switched off.
For the installation of the spare-part, it is necessary to consult a qualified electrician.

©2021 Flos - All rights reserved - www.flos.com
Flos reserves the right to introduce any changes to its own models, without prior notice.