

BELLHOP F F1070009

EN

F1072009B

BASE



WARNING! When installing and whenever acting on the appliance, ensure that the power supply has been switched off.
For the installation of the spare-part, it is necessary to consult a qualified electrician.

©2021 Flos - All rights reserved - www.flos.com

Flos reserves the right to introduce any changes to its own models, without prior notice.

BELLHOP F F1070009

EN

F1072009B

BASE

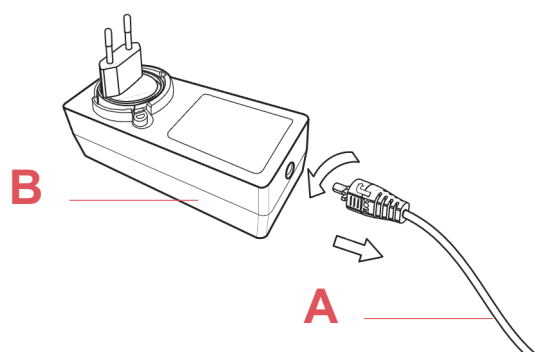

Fig.1

Remove the plug (A) from the power unit (B).

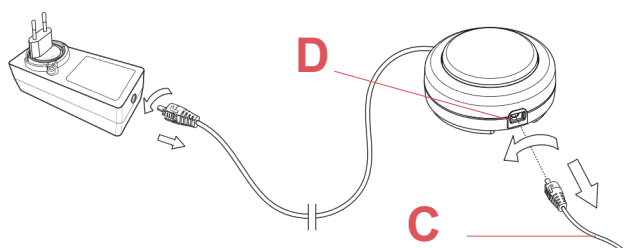

Fig.2

Disconnect the plug (C) to the push button (D).

WARNING! When installing and whenever acting on the appliance, ensure that the power supply has been switched off.
For the installation of the spare-part, it is necessary to consult a qualified electrician.

BELLHOP F F1070009

EN

F1072009B

BASE

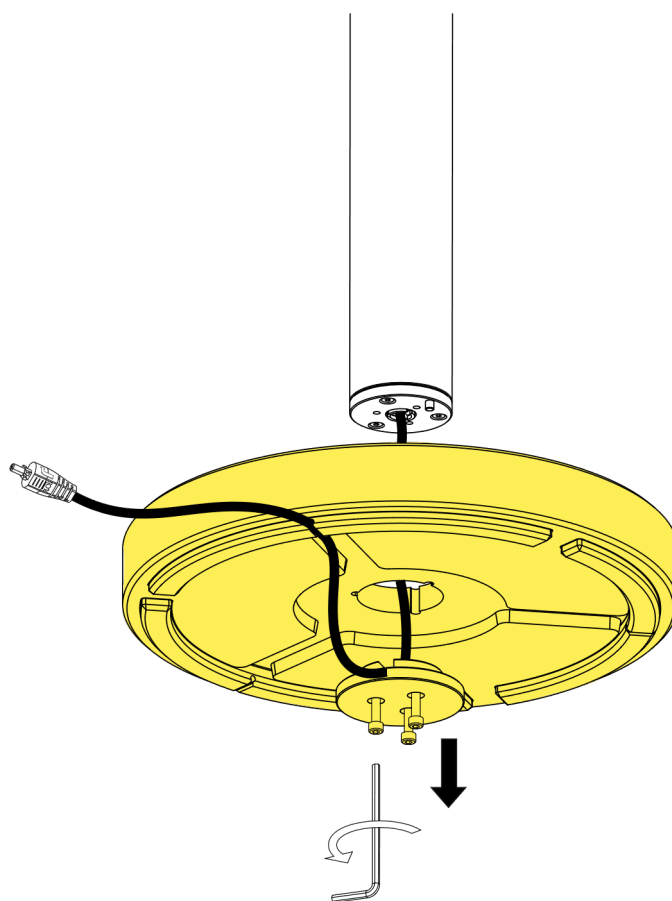

Fig.3

Unfasten the three screws under the old base (E). Disconnect it (F) from the body lamp (G).

Assemble now the new spare parts.

Install the new base to the body lamp and fast the screw under it.

Connect the plug to the push button switch locking it by turning it 90° clockwise.
(Fig.2)

Insert the plug into the power unit. (Fig.1)

WARNING! When installing and whenever acting on the appliance, ensure that the power supply has been switched off.
For the installation of the spare-part, it is necessary to consult a qualified electrician.