

2. SUPERLINE SURFACE

A LUMINAIRE INSTALLATION

INSTALACIÓN DE LA LUMINARIA / INSTALLAZIONE DELLA LAMPADA /
 INSTALLATION DER BELEUCHTUNG / INSTALLATION DU LUMINAIRE /
 INSTALAÇÃO DO APARELHO DE ILUMINAÇÃO / 照明器具の設置・取り付け /
 灯具的安装 / МОНТАЖ ОСВЕТИТЕЛЬНОГО ПРИБОРА
 ШАМДАЛДЫ ОРНАТУ / تركيب وحدة الإنارة

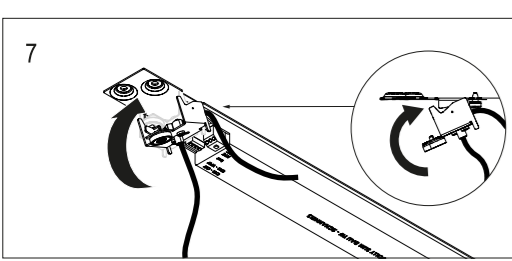
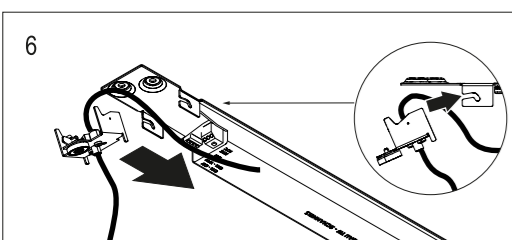
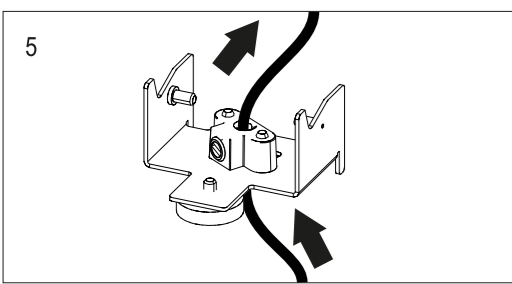
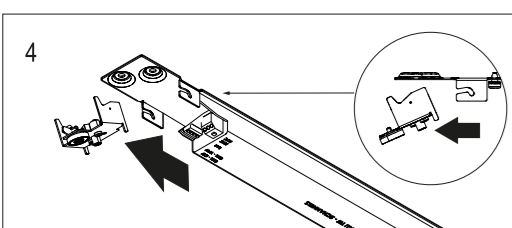
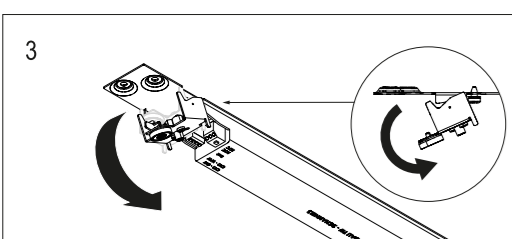
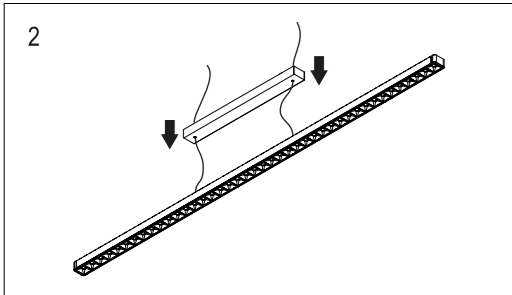
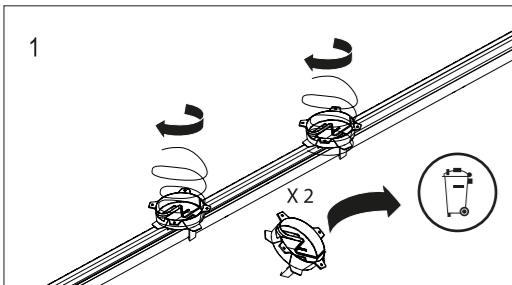

MEASURE BEFORE LOCK AND CUTTING

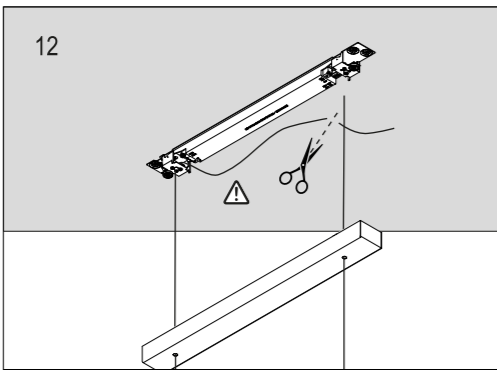
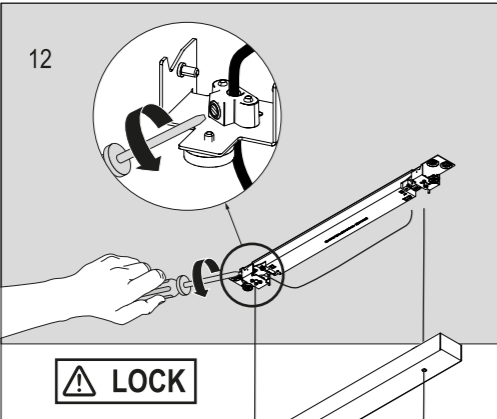
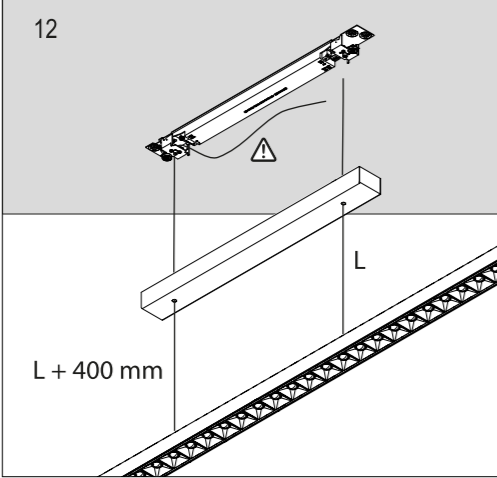

UP & DOWN VERSION

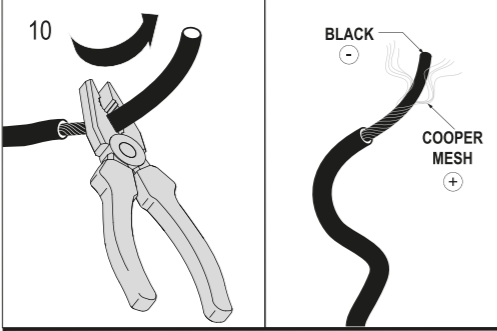

CONNECT ACCORDING TO ELECTRICAL SCHEME

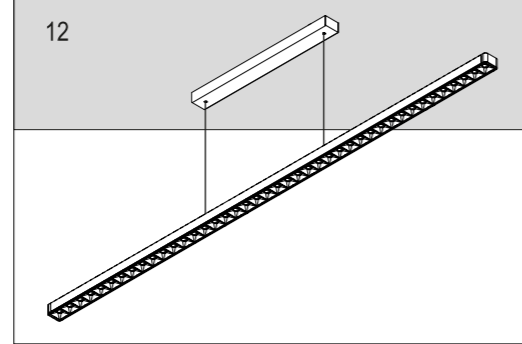
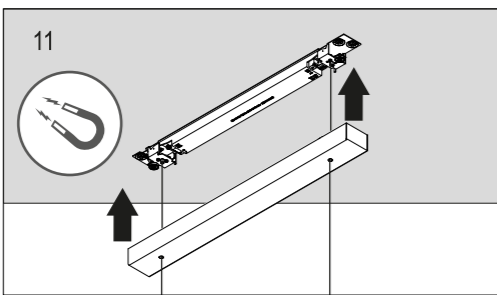

3. REMOTE DRIVER

A TECHNICAL DATA

DATOS TÉCNICOS / DATI TECNICI / TECHNISCHE DATEN / DONNEES
 TECHNIQUES / DADOS TÉCNICOS / テクニカルデータ / 技术数据 /
 ТЕХНИЧЕСКИЕ ДАННЫЕ / ТЕХНИКАЛЫБ МӨЛӨМӨТӨР / بيانات فنية

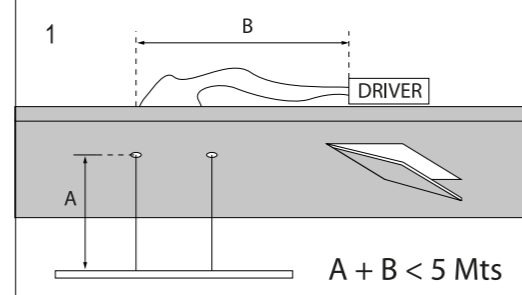

B LUMINAIRE INSTALLATION

INSTALACIÓN DE LA LUMINARIA / INSTALLAZIONE DELLA LAMPADA /
 INSTALLATION DER BELEUCHTUNG / INSTALLATION DU LUMINAIRE /
 INSTALAÇÃO DO APARELHO DE ILUMINAÇÃO / 照明器具の設置・取り付け /
 灯具的安装 / МОНТАЖ ОСВЕТИТЕЛЬНОГО ПРИБОРА
 ШАМДАЛДЫ ОРНАТУ / تركيب وحدة الإنارة

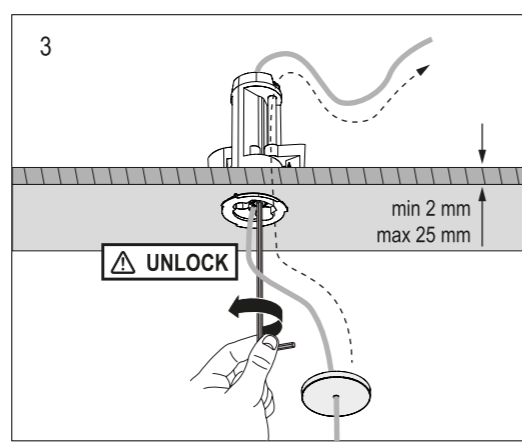
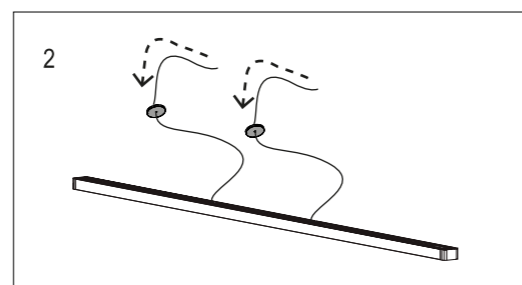
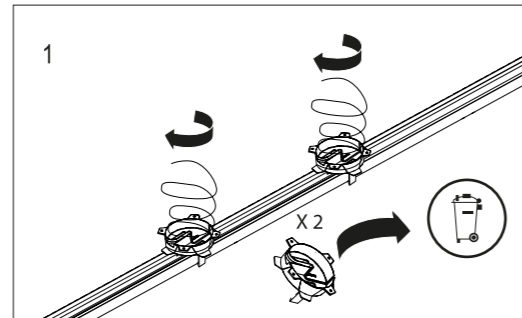

ADJUST BEFORE LOCK

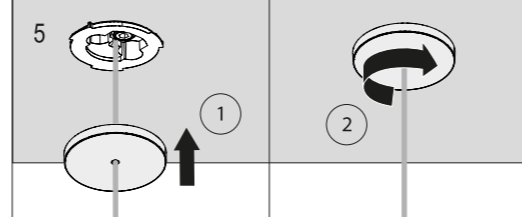
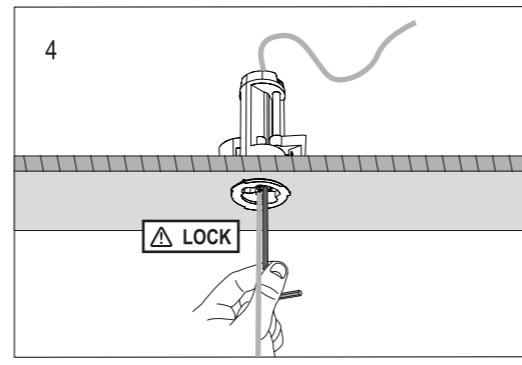
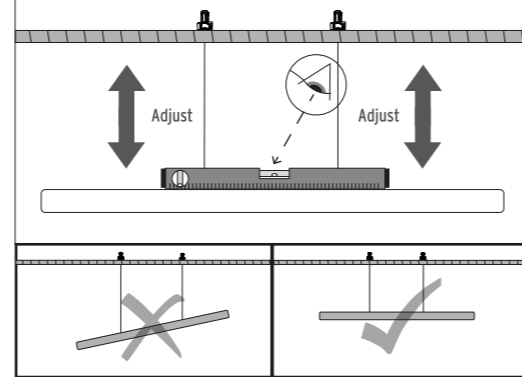

UP & DOWN VERSION

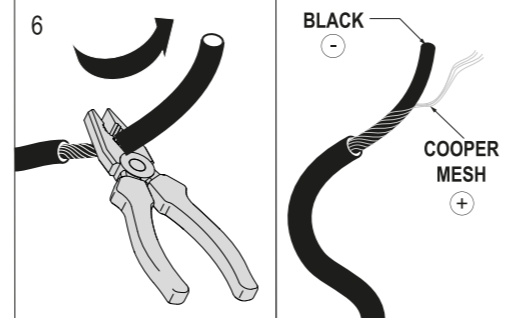

CONNECT ACCORDING TO ELECTRICAL SCHEME

DOWN LIGHT

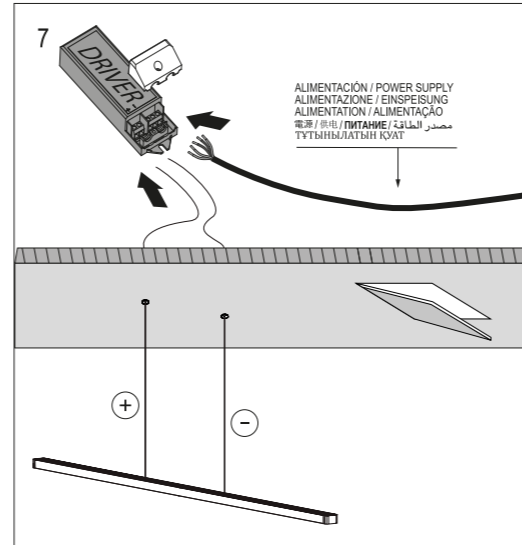

UP & DOWN LIGHT

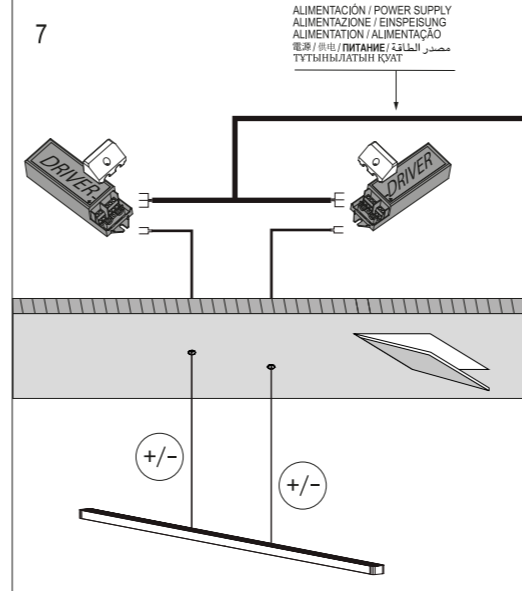

LED DRIVER $\leq 60 V_{out}$

ATTENTION

The voltage under load does not exceed 25 V r.m.s. or 60 V ripple-free d.c. and the no-load voltage does not exceed 35 V peak or 60V ripple-free d.c.

ELECTRICAL CONNECTION SCHEME

