

LA PLUS BELLE F3680064

EN

RF3680464

ANODIZED SHINY POWER UNIT

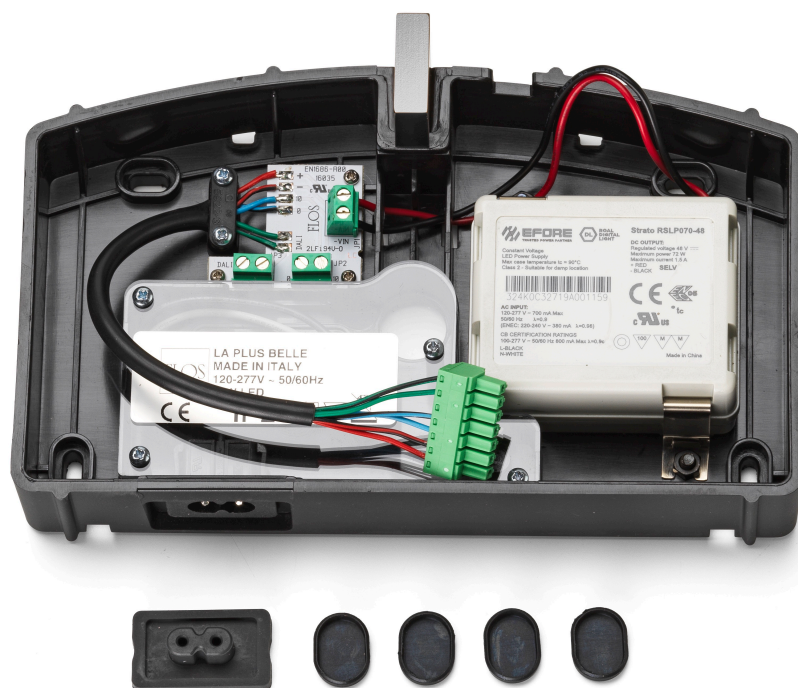

WARNING! When installing and whenever acting on the appliance, ensure that the power supply has been switched off. For the installation of the spare-part, it is necessary to consult a qualified electrician.

©2021 Flos - All rights reserved - www.flos.com

Flos reserves the right to introduce any changes to its own models, without prior notice.

LA PLUS BELLE F3680064

EN

RF3680464

ANODIZED SHINY POWER UNIT

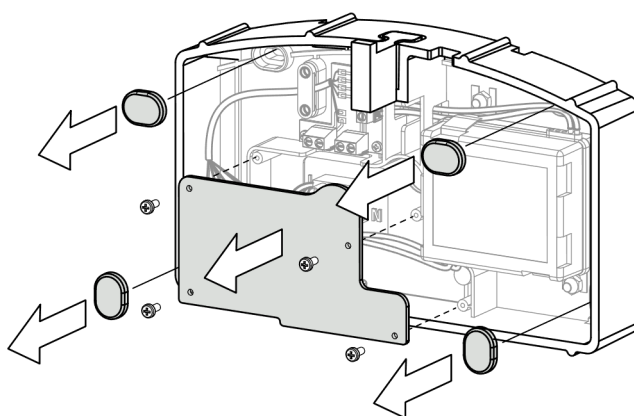

Fig.1

Remove the mirror from the wall.

Disconnect the electrical cables.

Remove the power unit from the wall..

WARNING! When installing and whenever acting on the appliance, ensure that the power supply has been switched off.
For the installation of the spare-part, it is necessary to consult a qualified electrician.

©2021 Flos - All rights reserved - www.flos.com
Flos reserves the right to introduce any changes to its own models, without prior notice.

LA PLUS BELLE F3680064

EN

RF3680464

ANODIZED SHINY POWER UNIT

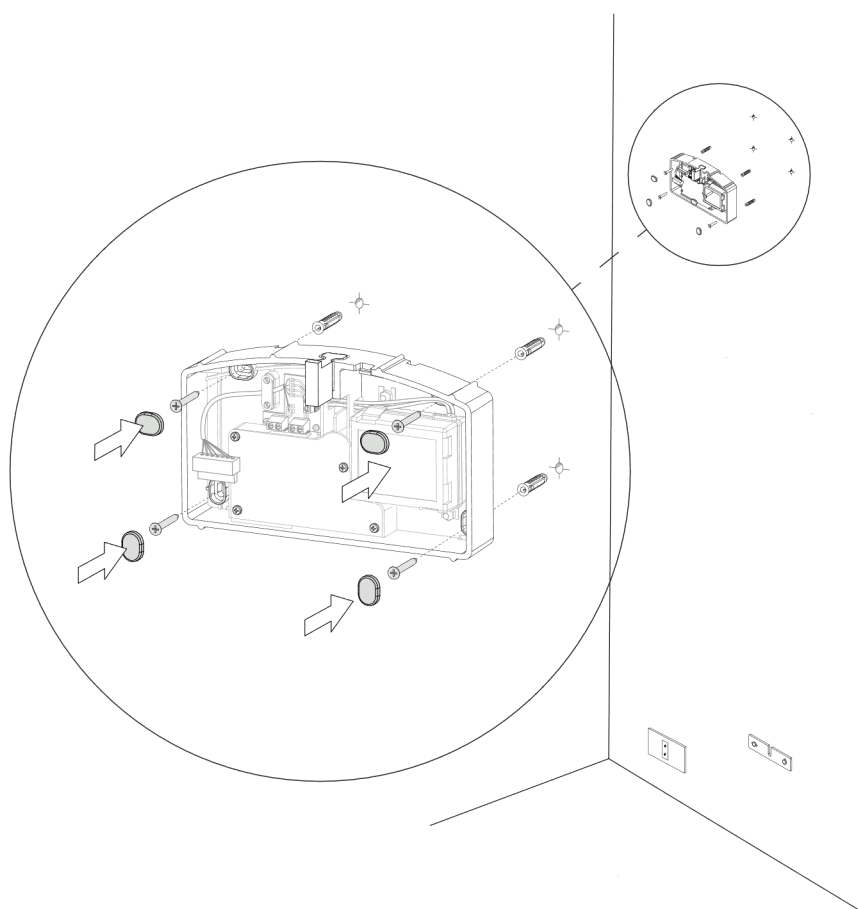

Fig.2

Position the power unit by screwing the screws in the same position as the old power unit.

WARNING! When installing and whenever acting on the appliance, ensure that the power supply has been switched off. For the installation of the spare-part, it is necessary to consult a qualified electrician.

LA PLUS BELLE F3680064

EN

RF3680464

ANODIZED SHINY POWER UNIT

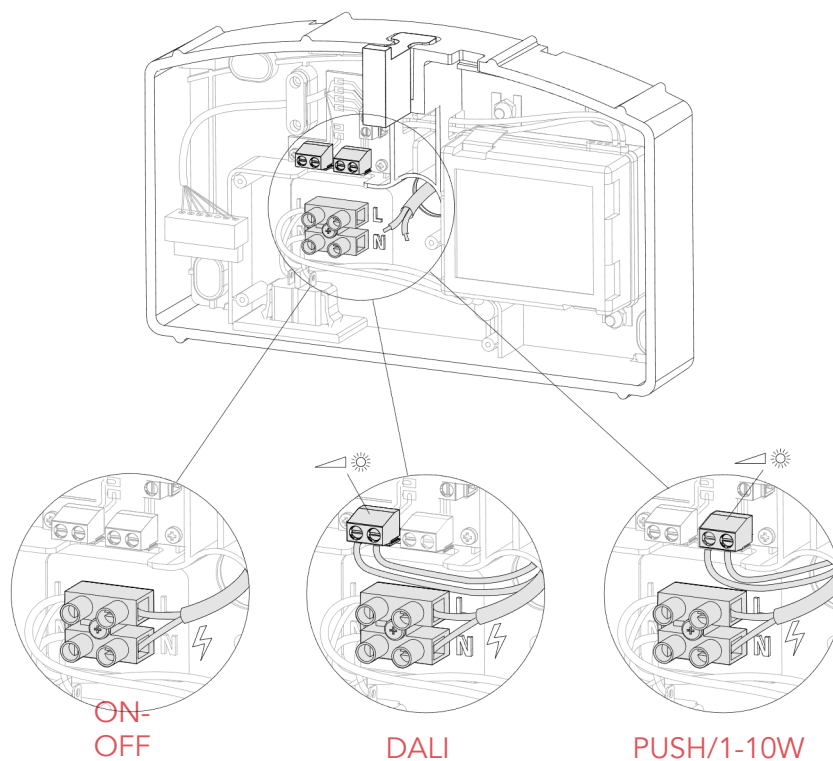

Fig.3

Connect the electric cables in the same position as the previous version.

WARNING! When installing and whenever acting on the appliance, ensure that the power supply has been switched off. For the installation of the spare-part, it is necessary to consult a qualified electrician.

LA PLUS BELLE F3680064

EN

RF3680464

ANODIZED SHINY POWER UNIT

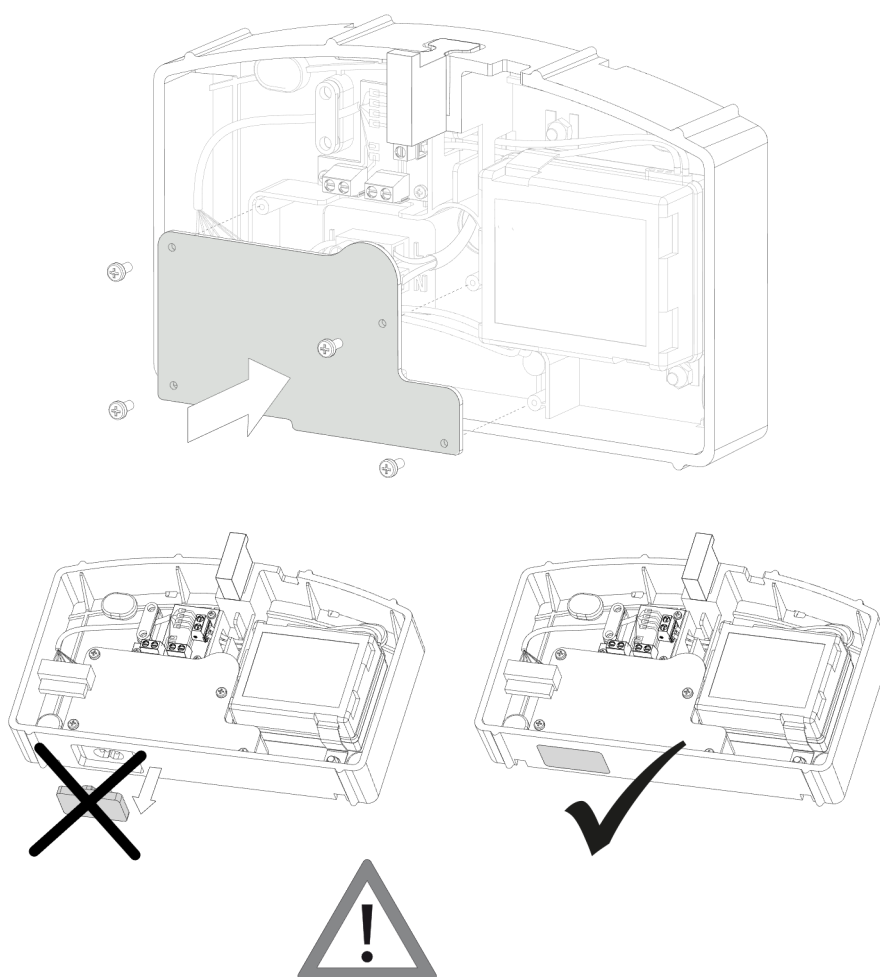

Fig.4

Position the protection screen and fix it with the 4 screws.

WARNING! When installing and whenever acting on the appliance, ensure that the power supply has been switched off. For the installation of the spare-part, it is necessary to consult a qualified electrician.

LA PLUS BELLE F3680064

EN

RF3680464

ANODIZED SHINY POWER UNIT

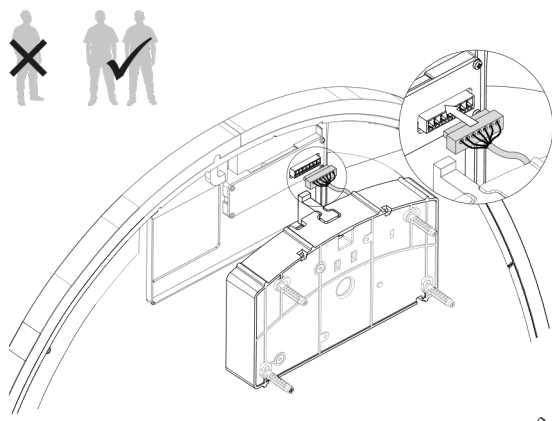

Fig.5

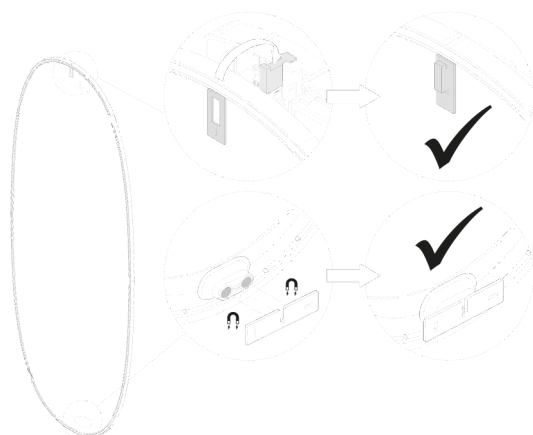

Fig.6

Position and connect the mirror.

WARNING! When installing and whenever acting on the appliance, ensure that the power supply has been switched off.
For the installation of the spare-part, it is necessary to consult a qualified electrician.