

A.1 LIGHT TUBE DIRECT / INDIRECT

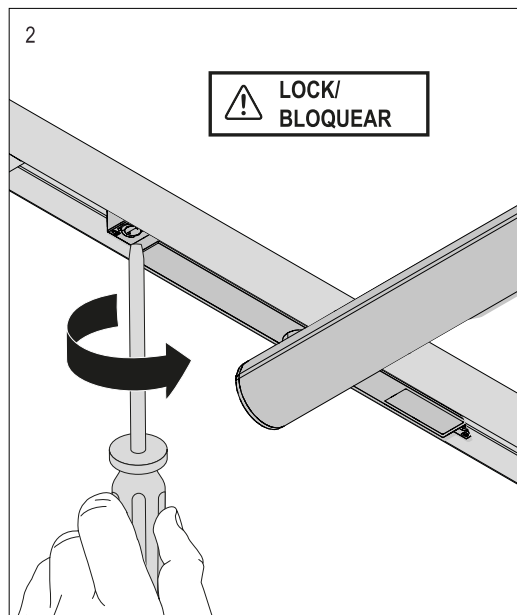

WARNING/ADVERTENCIA

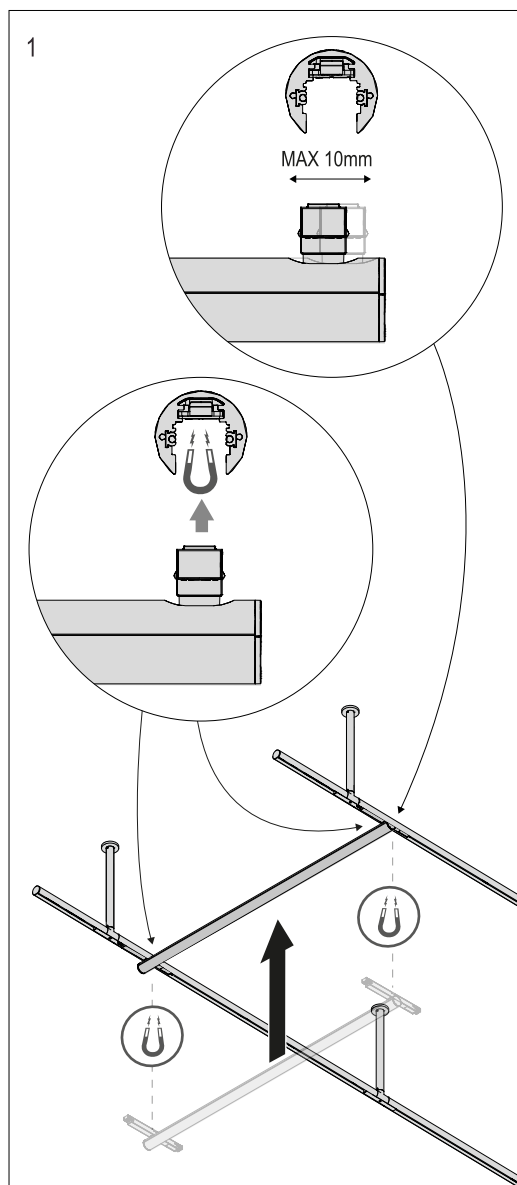
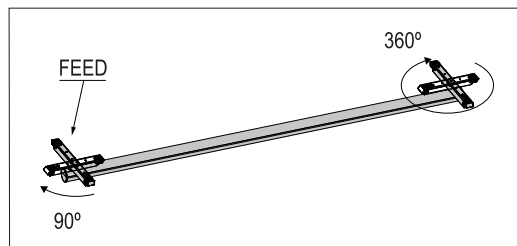
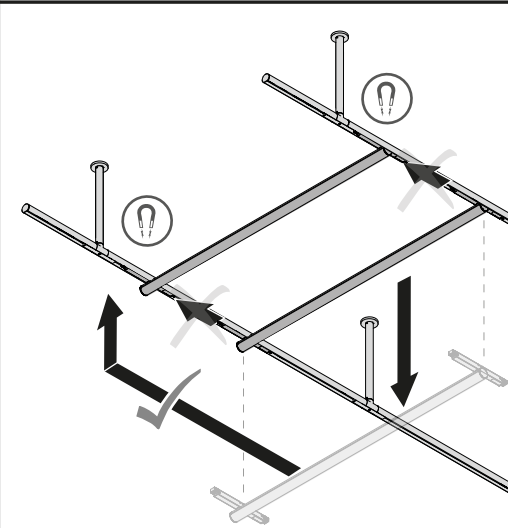

ADVERTENCIA

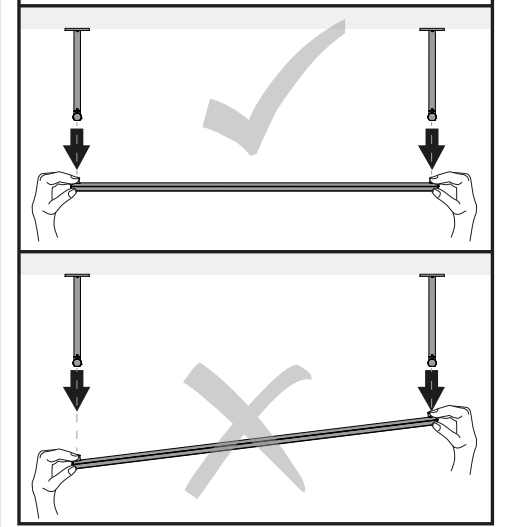

A.2 SUSPENSION STRUCTURE

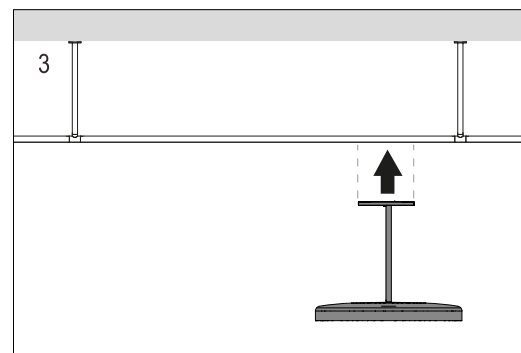
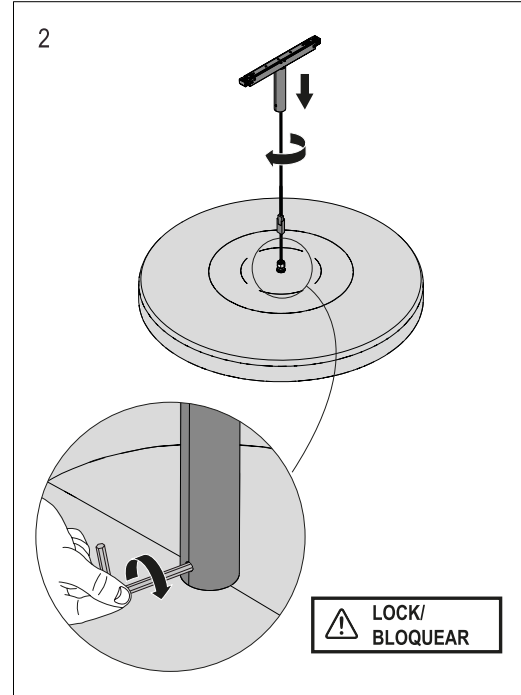
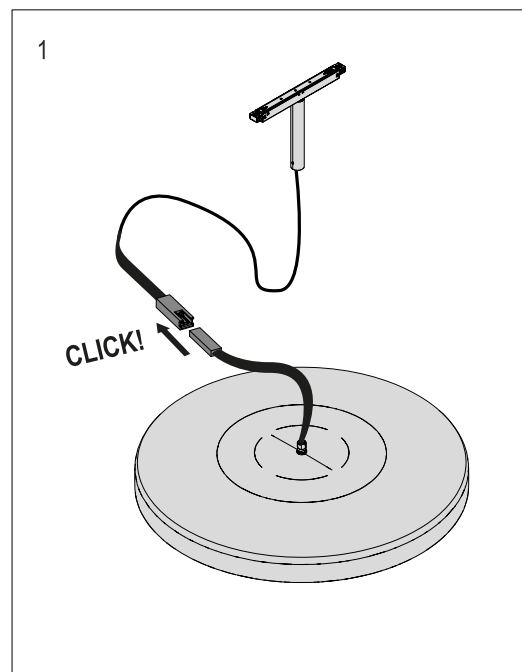

CORRECT POSITION/POSICIÓN CORRECTA

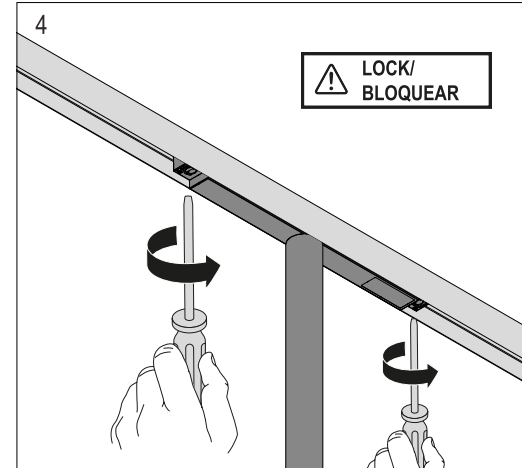
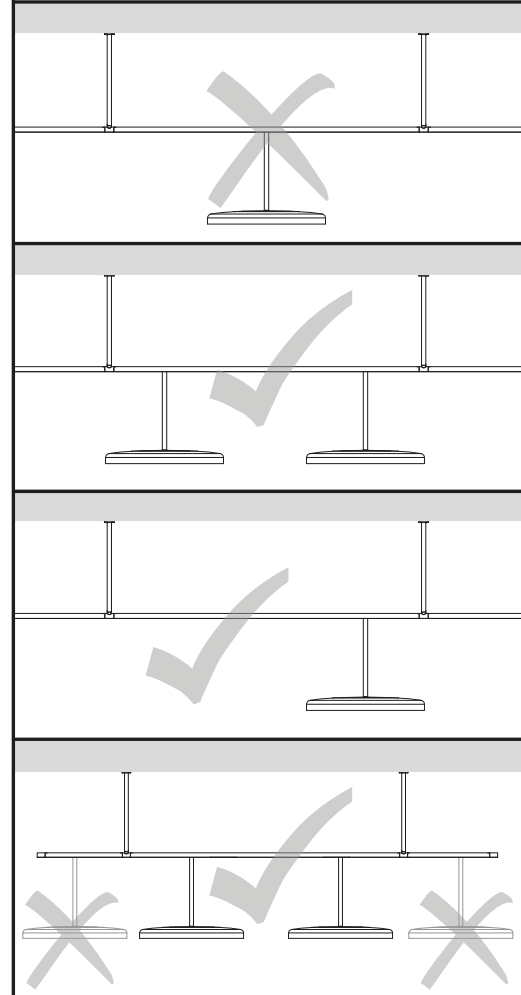

A.3 DOWNLIGHT STRUCTURE

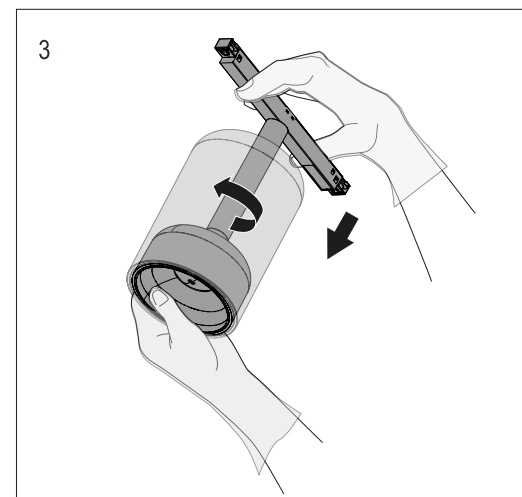
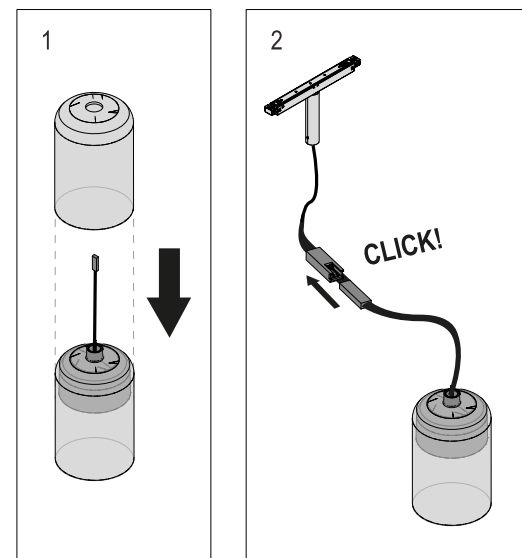

WARNING/ADVERTENCIA!

USE GLOVES FOR A PROPER INSTALLATION.
USAR GUANTES PARA LA CORRECTA INSTALACIÓN

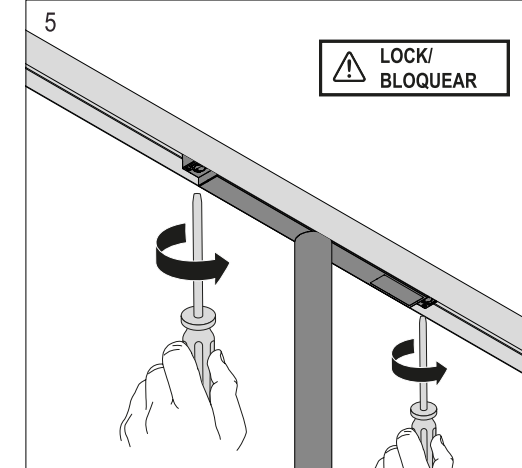
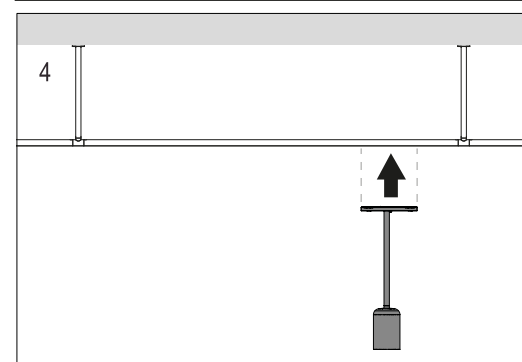

C DIMMABLE

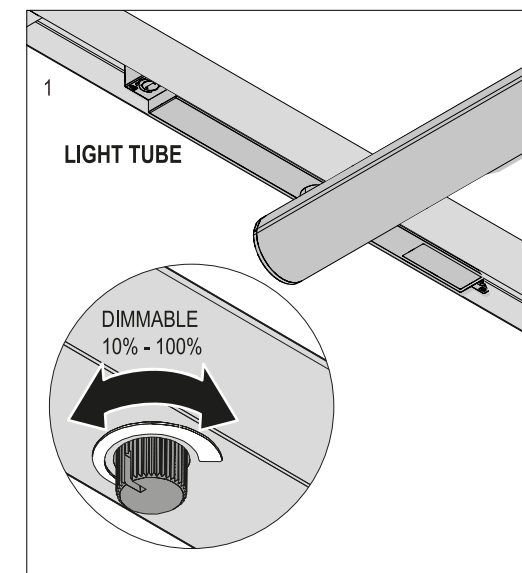

CASAMBI VERSION

- The CASAMBI control will be 1% to 100%
- MAX. 200 luminaires for a single CASAMBI network.
- MAX. 15 meters between luminaires if the environment is an open space (no wall in between luminaires)
- To know more about all CASAMBI options visit www.casambi.com